



Chipsmall Limited consists of a professional team with an average of over 10 year of expertise in the distribution of electronic components. Based in Hongkong, we have already established firm and mutual-benefit business relationships with customers from,Europe,America and south Asia,supplying obsolete and hard-to-find components to meet their specific needs.

With the principle of “Quality Parts,Customers Priority,Honest Operation,and Considerate Service”,our business mainly focus on the distribution of electronic components. Line cards we deal with include Microchip,ALPS,ROHM,Xilinx,Pulse,ON,Everlight and Freescale. Main products comprise IC,Modules,Potentiometer,IC Socket,Relay,Connector.Our parts cover such applications as commercial,industrial, and automotives areas.

We are looking forward to setting up business relationship with you and hope to provide you with the best service and solution. Let us make a better world for our industry!



Contact us

Tel: +86-755-8981 8866 Fax: +86-755-8427 6832

Email & Skype: info@chipsmall.com Web: www.chipsmall.com

Address: A1208, Overseas Decoration Building, #122 Zhenhua RD., Futian, Shenzhen, China



AZ Series • Flying Lead Current Transformers

Features

- Very high output voltage & linearity in small size
- Integral flying leads for ease of installation
- Large center-hole allows 6.3mm tabs
- Dielectric withstand voltage 4KVrms
- Operating temperature Range -40°C to +85°C
- All materials UL94V-0
- Manufactured in an ISO 9001:2008, ISO/TS 16949:2009 and ISO 14001:2004 certified Talema facility
- Fully RoHS & REACH Compliant

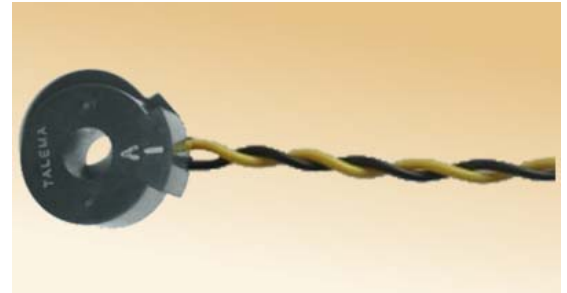

Electrical Specifications at 20°C

Parameter	AZ-0500	AZ-0750	AZ-1000
Operating Frequency in Hz	50/60	50/60	50/60
Maximum Primary Current in Amps	25	40	50
Turns Ratio Nominal	500:1	750:1	1000:1
DC Resistance in Ohms Nominal	18	35	72
Rated Burden Resistance in Ohms	33	33	33

Mechanical Drawing

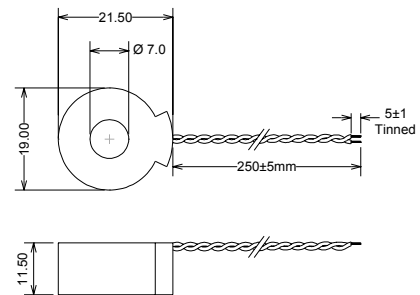

Lead outs: Flex UL1569 AWG24, 300V Rating, 250±5mm long out of trafo with 5mm tinned ends

AZ-0500

Response Curve

AZ-0750

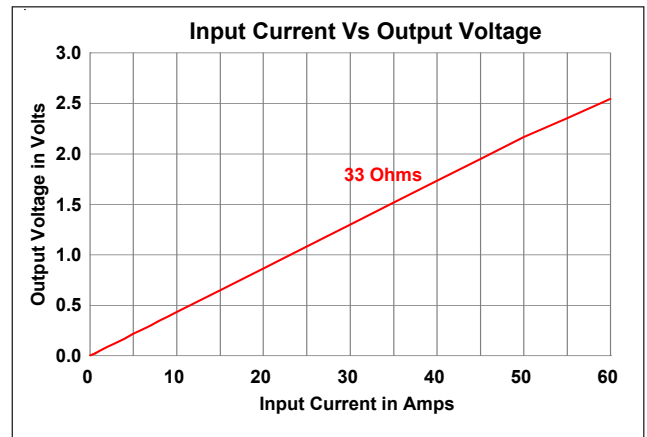
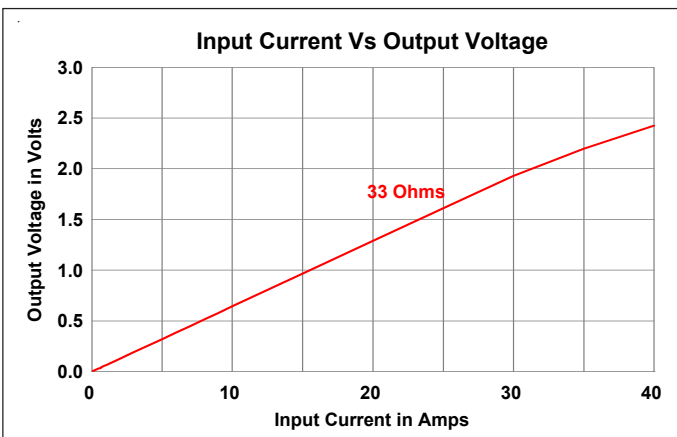

AZ-1000

