



Chipsmall Limited consists of a professional team with an average of over 10 year of expertise in the distribution of electronic components. Based in Hongkong, we have already established firm and mutual-benefit business relationships with customers from,Europe,America and south Asia,supplying obsolete and hard-to-find components to meet their specific needs.

With the principle of “Quality Parts,Customers Priority,Honest Operation,and Considerate Service”,our business mainly focus on the distribution of electronic components. Line cards we deal with include Microchip,ALPS,ROHM,Xilinx,Pulse,ON,Everlight and Freescale. Main products comprise IC,Modules,Potentiometer,IC Socket,Relay,Connector.Our parts cover such applications as commercial,industrial, and automotives areas.

We are looking forward to setting up business relationship with you and hope to provide you with the best service and solution. Let us make a better world for our industry!



Contact us

Tel: +86-755-8981 8866 Fax: +86-755-8427 6832

Email & Skype: info@chipsmall.com Web: www.chipsmall.com

Address: A1208, Overseas Decoration Building, #122 Zhenhua RD., Futian, Shenzhen, China



Metal Core SMD Power Inductors (MCOIL™, MD series)

MDMK2020T4R7MM

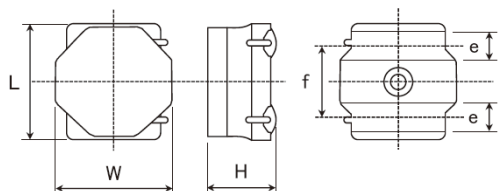

■ Features

- Item Summary
4.7uH±20%, 0.95A, 2.0x2.0x1.2mm
- Lifecycle Stage
Mass Production
- Standard packaging quantity (minimum)
Taping Embossed 2500pcs

■ Products characteristics table

| | |
|---|---|
| Inductance | 4.7 uH ± 20 % |
| Case Size (mm) | 2.0x2.0 |
| Rated Current (max) | 0.95 A |
| Saturation Current (max) | 1.15 A |
| Saturation Current (typ) | 1.3 A |
| Temperature Rise Current (max) | 0.95 A |
| Temperature Rise Current (typ) | 1.05 A |
| DC Resistance (max) | 0.242 Ω |
| DC Resistance (typ) | 0.21 Ω |
| LQ Measuring Frequency | 1 MHz |
| Operating Temp. Range | -40 to +125 °C (Including-self-generated heat) |
| Temperature characteristic (Inductance change) | ± 10 % |
| RoHS2 Compliance (10 subst.) | Yes |
| REACH Compliance (173 subst.) | Yes |
| Halogen Free | Yes |
| Soldering | Reflow |

■ External Dimensions

| | |
|-------------|--------------|
| Dimension L | 2.0 ±0.15 mm |
| Dimension W | 2.0 ±0.15 mm |
| Dimension H | Max 1.2 mm |
| Dimension e | 0.5 ±0.2 mm |
| Dimension f | 1.25 ±0.2 mm |

■ Recommended Land Patterns

【推奨ランドパターン】
実装上の注意
・実装状態を確認の上ご使用くださいますようお願いいたします。
・本製品のはんだ付けはリフローはんだ工法に限りします。

【Recommended Land Patterns】
Surface Mounting
・Mounting and soldering conditions should be checked beforehand.
・Applicable soldering process to these products is reflow soldering only.

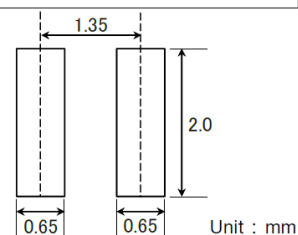

Metal Core SMD Power Inductors (MCOIL™, MD series)

MCOIL™
MDMK2020T4R7MM



| Dimension | unit : mm | unit : inch |
|-----------|--------------|---------------------|
| Length : | 2.0 +/- 0.15 | (0.079 +/- 0.006) |
| Width : | 2.0 +/- 0.15 | (0.079 +/- 0.006) |
| Height : | 1.2 max. | (0.047 max.) |

| | | | |
|--|---------------|-------------------|-----------------------|
| Inductance : | 4.7 | uH | (test freq at 1MHz) |
| DC Resistance : | 0.210 / 0.242 | ohm (typ / max) | |
| Saturation Current : | 1,300 / 1,150 | mA (typ / max) | |
| Temp. rise Current : | 1,050 / 950 | mA (typ / max) | |
| Saturation current typical : 30% reduction from initial L value. | | | |
| Temp rise Current typical : Temperature will rise by 40 deg C | | | |
| Maximum rated voltage : DC 25 V | | | |

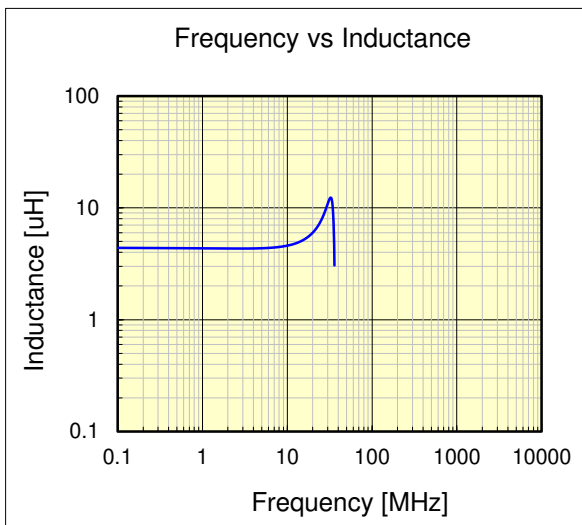
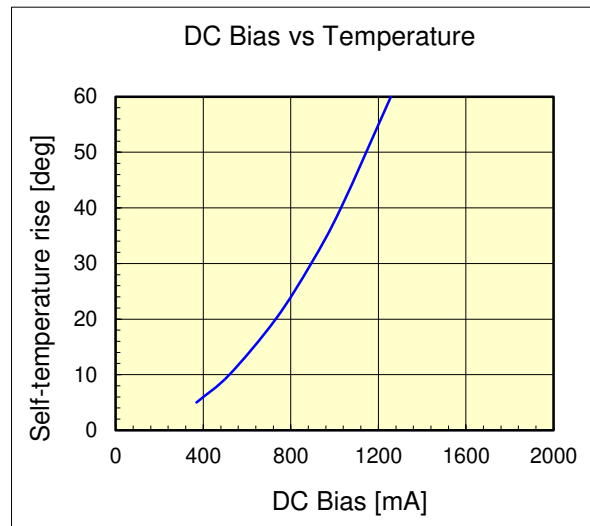
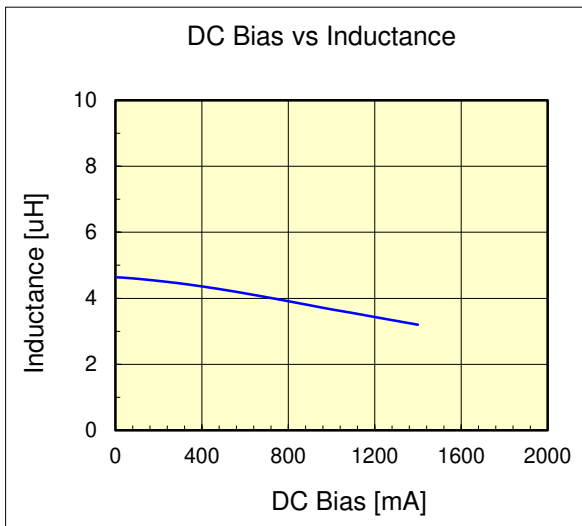

The data is reference only. Electrical characteristics vary depending on environment or measurement condition. TAIYO YUDEN reserves the right to make change to the data at any time without notice. Before making final selection, please check product specification.