



Chipsmall Limited consists of a professional team with an average of over 10 year of expertise in the distribution of electronic components. Based in Hongkong, we have already established firm and mutual-benefit business relationships with customers from,Europe,America and south Asia,supplying obsolete and hard-to-find components to meet their specific needs.

With the principle of “Quality Parts,Customers Priority,Honest Operation,and Considerate Service”,our business mainly focus on the distribution of electronic components. Line cards we deal with include Microchip,ALPS,ROHM,Xilinx,Pulse,ON,Everlight and Freescale. Main products comprise IC,Modules,Potentiometer,IC Socket,Relay,Connector.Our parts cover such applications as commercial,industrial, and automotives areas.

We are looking forward to setting up business relationship with you and hope to provide you with the best service and solution. Let us make a better world for our industry!



Contact us

Tel: +86-755-8981 8866 Fax: +86-755-8427 6832

Email & Skype: info@chipsmall.com Web: www.chipsmall.com

Address: A1208, Overseas Decoration Building, #122 Zhenhua RD., Futian, Shenzhen, China



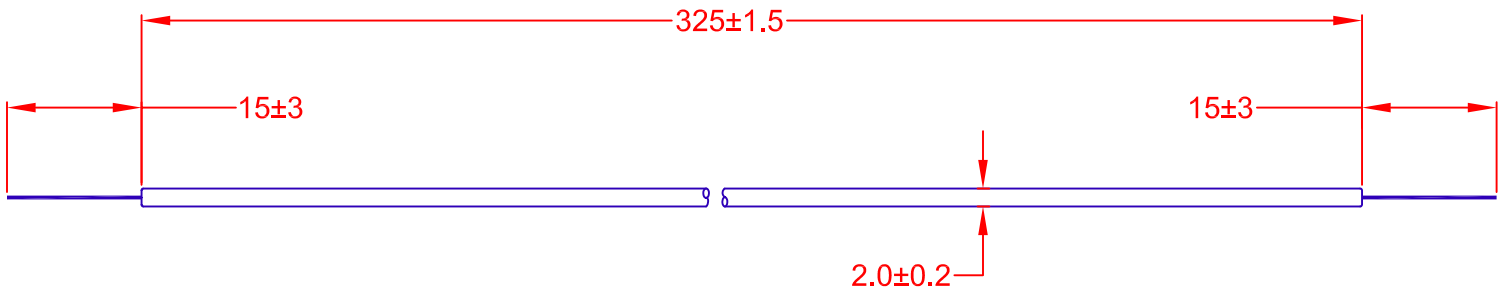

JKL LAMP PART NUMBER	COLOR	STARTING CIRCUIT VOLTAGE VS (Vrms)	OPERATING LAMP VOLTAGE VL (Vrms)	OPERATING LAMP CURRENT IL (mArms)	BRIGHTNESS (Cd/m ²)	*RATED LIFE (HRS)
CF20325-24B	8400 Kelvin x = .290 REF. y = .305 REF.	**1830 MAX.	735 @ 5mA	5.0 TYP. 7.0 MAX.	46,000 TYP.	20,000 MIN. 40,000 AVG.

* RATED LIFE IS DEFINED AS THE POINT AT WHICH THE INTENSITY BECOMES 50% OF THE INITIAL RATING.

**MAY BE HIGHER WHEN MOUNTED IN METAL RAIL AND USING INPUT HARNESS, REF. 2250 Vrms Max. @ 0 C.

 THIRD ANGLE PROJECTION		METRIC DIMENSIONS ARE IN MILLIMETERS TOLERANCE UNLESS OTHERWISE SPECIFIED 1 PL +/- 0.2 2 PL +/- 0 ANGLE +/- 0	JKL COMPONENTS CORPORATION				
		TITLE MINIATURE COLD CATHODE FLUORESCENT LAMP					
A CHANGE BRIGHTNESS TO 46,000 TYP. RELEASED	5/3/05 4/15/04	DRAWN BY L. WENGSTROM	APPVD BY J.K.	DATE 5/3/05	SIZE A	FSCM NO. 55335	DRAWING NO. CF20325-24B
- CAD DRAWING - MANUAL REVISIONS NOT PERMITTED		SCALE NONE	RELEASED DATE 4/15/04	REVISION DATE 5/3/05	REV. NO. A	SHEET 1 OF 1	