



Chipsmall Limited consists of a professional team with an average of over 10 year of expertise in the distribution of electronic components. Based in Hongkong, we have already established firm and mutual-benefit business relationships with customers from,Europe,America and south Asia,supplying obsolete and hard-to-find components to meet their specific needs.

With the principle of “Quality Parts,Customers Priority,Honest Operation,and Considerate Service”,our business mainly focus on the distribution of electronic components. Line cards we deal with include Microchip,ALPS,ROHM,Xilinx,Pulse,ON,Everlight and Freescale. Main products comprise IC,Modules,Potentiometer,IC Socket,Relay,Connector.Our parts cover such applications as commercial,industrial, and automotives areas.

We are looking forward to setting up business relationship with you and hope to provide you with the best service and solution. Let us make a better world for our industry!



Contact us

Tel: +86-755-8981 8866 Fax: +86-755-8427 6832

Email & Skype: info@chipsmall.com Web: www.chipsmall.com

Address: A1208, Overseas Decoration Building, #122 Zhenhua RD., Futian, Shenzhen, China



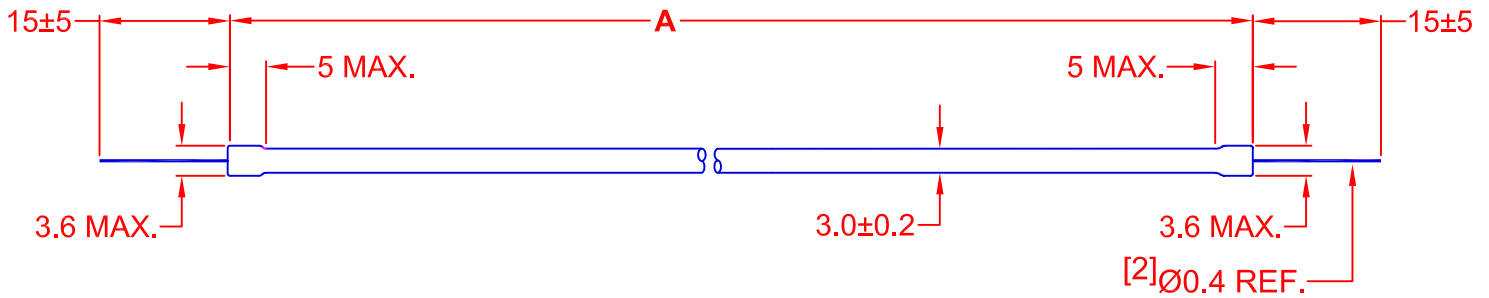

JKL PART NUMBER	- A - LENGTH	COLOR	STARTING CIRCUIT VOLTAGE VS (Vrms) @ 0°C TYP.	OPERATING LAMP VOLTAGE VL (Vrms) TYP.	OPERATING LAMP CURRENT IL (mA rms)	BRIGHTNESS (CANDELA/m ²) TYPICAL	*RATED LIFE (HRS) AVERAGE
BF350-20B	50 +/- 2.0	RGB HIGH OUTPUT WHITE 5400° KELVIN (REF.) x = .340 y = .360	425	170	5 ± 1	31,000	40,000
BF375-20B	75 +/- 2.0		515	205	5 ± 1	31,000	40,000
BF386-20B	86 +/- 2.0		540	215	5 ± 1	31,000	40,000
BF3100-20B	100 +/- 2.0		640	255	5 ± 1	31,000	40,000
BF3115-20B	115 +/- 2.0		725	290	5 ± 1	31,000	40,000
BF3130-20B	130 +/- 2.0		775	310	5 ± 1	31,000	40,000
BF3160-20B	160 +/- 2.0		900	360	5 ± 1	31,000	40,000
BF3180-20B	180 +/- 2.0		950	380	5 ± 1	31,000	40,000
BF3216-20B	216 +/- 2.0		1125	450	5 ± 1	31,000	40,000
BF3240-20B	240 +/- 2.0		1240	495	5 ± 1	31,000	40,000
BF3250-20B	250 +/- 2.0		1300	520	5 ± 1	31,000	40,000
BF3275-20B	275 +/- 2.0		1475	590	5 ± 1	31,000	40,000
BF3300-20B	300 +/- 1.5		1625	650	5 ± 1	31,000	40,000
BF3360-20B	360 +/- 2.0		1850	740	5 ± 1	31,000	40,000
BF3380-20B	380 +/- 2.0		1975	790	5 ± 1	31,000	40,000

*NOTE: RATED LIFE IS DEFINED AS THE POINT AT WHICH THE INTENSITY BECOMES 50% OF THE INITIAL RATING.

J	CHNG LEAD LTH & BRIGHTNESS TO 31,000 TYP	12/30/09	METRIC THIRD ANGLE PROJECTION	DIMENSIONS ARE IN MILLIMETERS TOLERANCE UNLESS OTHERWISE SPECIFIED 1 PL +/- 0.2 2 PL +/- 0.20 ANGLE +/- 0	JKL COMPONENTS CORPORATION TITLE MINIATURE COLD CATHODE FLUORESCENT LAMP
I	CHANGE LEAD LENGTH TOLERANCE	3/24/08			
H	CHANGE BF3300-20B LENGTH TOLERANCE	2/3/06			
G	ELECTRICAL MODIFICATIONS	8/5/04			
F	ADD PART NUMBER BF3115-20B	12/19/02			
E	ADD PART NUMBER BF3180-20B & BF3380-20B	11/30/01			
D	ADD PART NUMBER BF3240-20B	4/26/01			
C	ADD PART NUMBER BF3130-20B	9/11/00			
B	ADD PART NUMBER BF375-20B	4/21/00			
A	LENGTH ±5 TO ±2	2/25/00			
RELEASED - CANCEL BF-3mm DIA DRAWING			2/21/00	SIZE A FSCM NO. 55335 DRAWING NO. BF 3-20B	
REV. NO.	DESCRIPTION/ECO NUMBER	APPVD DATE	DRAWN BY L. WENGSTROM APPVD BY L.R. DATE 12/30/09 - CAD DRAWING - MANUAL REVISIONS NOT PERMITTED	SCALE NONE	RELEASED DATE 2/21/00 REVISION DATE 12/30/09 REV. NO. J SHEET 1 OF 1