



Chipsmall Limited consists of a professional team with an average of over 10 year of expertise in the distribution of electronic components. Based in Hongkong, we have already established firm and mutual-benefit business relationships with customers from,Europe,America and south Asia,supplying obsolete and hard-to-find components to meet their specific needs.

With the principle of "Quality Parts,Customers Priority,Honest Operation,and Considerate Service",our business mainly focus on the distribution of electronic components. Line cards we deal with include Microchip,ALPS,ROHM,Xilinx,Pulse,ON,Everlight and Freescale. Main products comprise IC,Modules,Potentiometer,IC Socket,Relay,Connector.Our parts cover such applications as commercial,industrial, and automotives areas.

We are looking forward to setting up business relationship with you and hope to provide you with the best service and solution. Let us make a better world for our industry!



Contact us

Tel: +86-755-8981 8866 Fax: +86-755-8427 6832

Email & Skype: info@chipsmall.com Web: www.chipsmall.com

Address: A1208, Overseas Decoration Building, #122 Zhenhua RD., Futian, Shenzhen, China



1/4" x 7/8" to 1 1/4" In-Line Fuse Holders

HHB Series

Description

- For 1/4" x 7/8" to 1/4" x 1 1/4" fuses
- Accepts #16 to #12 AWG copper wire
- Simple crimp assembly
- "Snap-Lock" feature provides strong positive union
- High visibility yellow color
- Recommended crimp tools:
 - Thomas & Betts – ERG-2001
 - Channelock No. 909
 - General Electric – U.S. & Metric Electrical Terminal Tool
- UL flammability rating 94 V2

Environmental Data

- Pull Force: 5 pounds minimum to separate fuseholder housing with fuse inside

Ordering

Specify packaging code

- Insert packaging code prefix before part number.
E.g. BK/HHB-R

Specify option codes if desired

- Drop "-R" suffix when ordering. E.g. BK/HHB-Y408

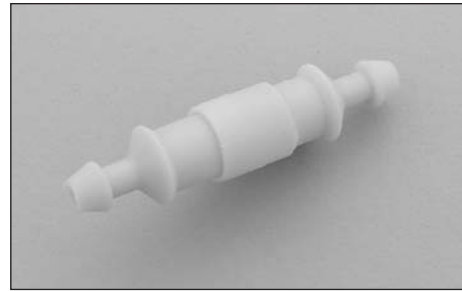

Dimensions - in (mm)

Drawing Not to Scale

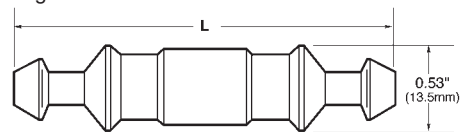

Fuse Length	"L" with fuse installed
7/8"	2.100 Max.
1"	2.250 Max.
1 1/4"	2.420 Max.

Specifications		
Part Number	Volts	Amps
HHB-R*	32	30 max

*RoHS compliant construction.

Component	Material
Body	Nylon
Crimp	Copper Tin-Plated

Packaging Code	
Packaging Code Prefix	Description
Blank	10 fuse holders packed into a carton
BK	1,000 fuse holders packed into a cardboard shelf package

Option Code	
Option Code	Description
Y408**†	#14 AWG insulated wire with 8 inch yellow leads
R408†	#14 AWG insulated wire with 8 inch red leads
B408**†	#14 AWG insulated wire with 8 inch black leads
Y419**†	#14 AWG insulated wire with 19 inch yellow leads
R419**†	#14 AWG insulated wire with 19 inch red leads
B419**†	#14 AWG insulated wire with 19 inch black leads

**Not available in RoHS compliant construction.

† Drop "-R" suffix when ordering these options.

The only controlled copy of this Data Sheet is the electronic read-only version located on the Cooper Bussmann Network Drive. All other copies of this document are by definition uncontrolled. This bulletin is intended to clearly present comprehensive product data and provide technical information that will help the end user with design applications. Cooper Bussmann reserves the right, without notice, to change design or construction of any products and to discontinue or limit distribution of any products. Cooper Bussmann also reserves the right to change or update, without notice, any technical information contained in this bulletin. Once a product has been selected, it should be tested by the user in all possible applications.

Life Support Policy: Cooper Bussmann does not authorize the use of any of its products for use in life support devices or systems without the express written approval of an officer of the Company. Life support systems are devices which support or sustain life, and whose failure to perform, when properly used in accordance with instructions for use provided in the labeling, can be reasonably expected to result in significant injury to the user.