



Chipsmall Limited consists of a professional team with an average of over 10 year of expertise in the distribution of electronic components. Based in Hongkong, we have already established firm and mutual-benefit business relationships with customers from,Europe,America and south Asia,supplying obsolete and hard-to-find components to meet their specific needs.

With the principle of “Quality Parts,Customers Priority,Honest Operation,and Considerate Service”,our business mainly focus on the distribution of electronic components. Line cards we deal with include Microchip,ALPS,ROHM,Xilinx,Pulse,ON,Everlight and Freescale. Main products comprise IC,Modules,Potentiometer,IC Socket,Relay,Connector.Our parts cover such applications as commercial,industrial, and automotives areas.

We are looking forward to setting up business relationship with you and hope to provide you with the best service and solution. Let us make a better world for our industry!



## Contact us

Tel: +86-755-8981 8866 Fax: +86-755-8427 6832

Email & Skype: info@chipsmall.com Web: www.chipsmall.com

Address: A1208, Overseas Decoration Building, #122 Zhenhua RD., Futian, Shenzhen, China



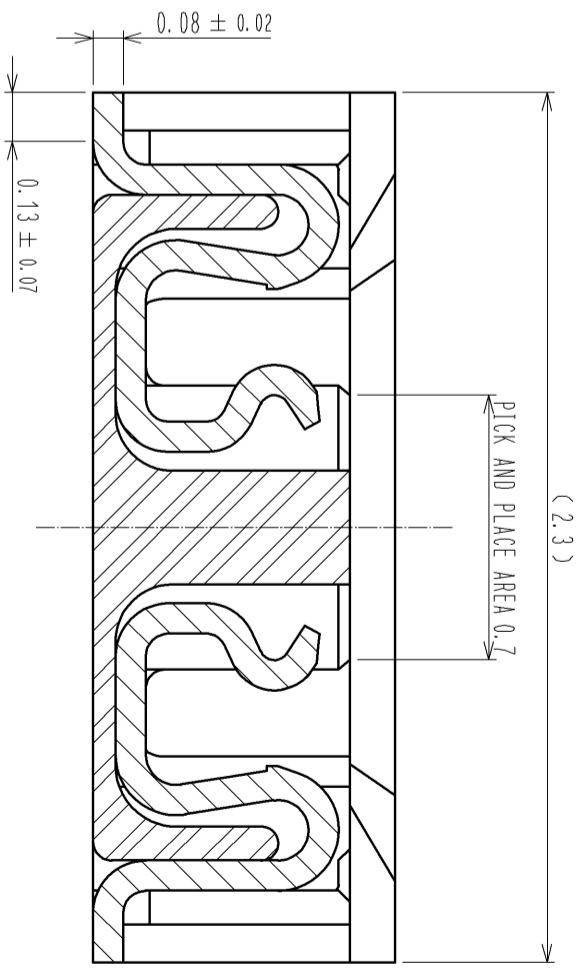
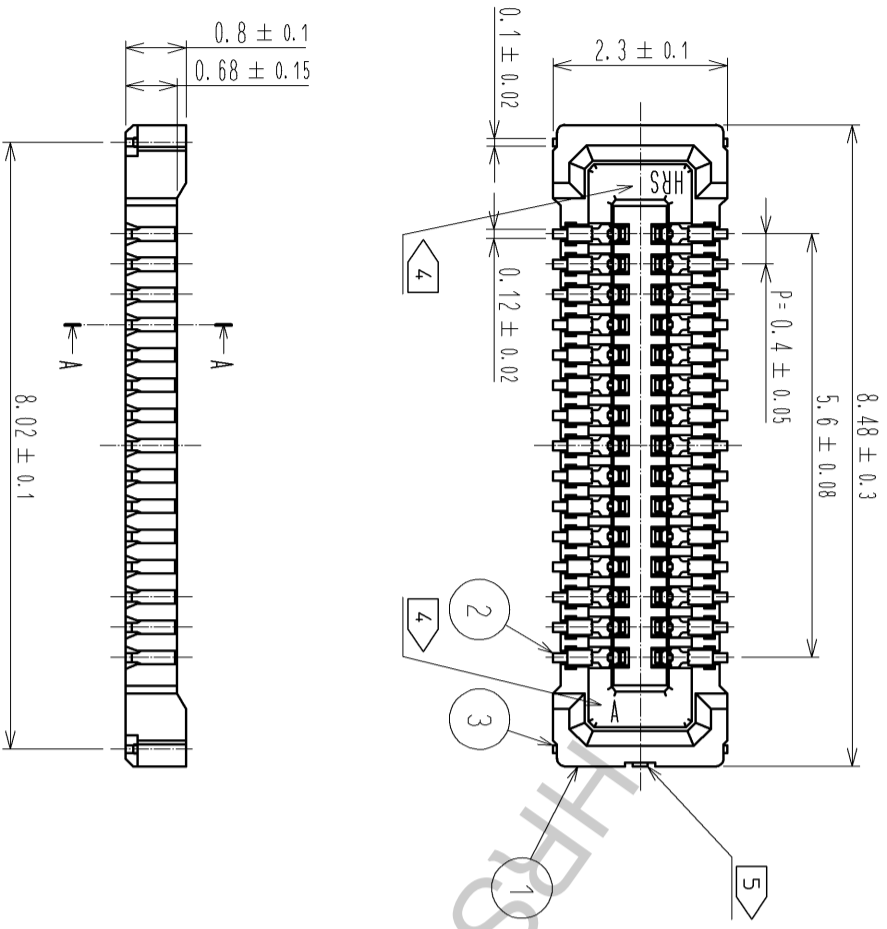

ENGAGEMENT FIGURE (50:1)

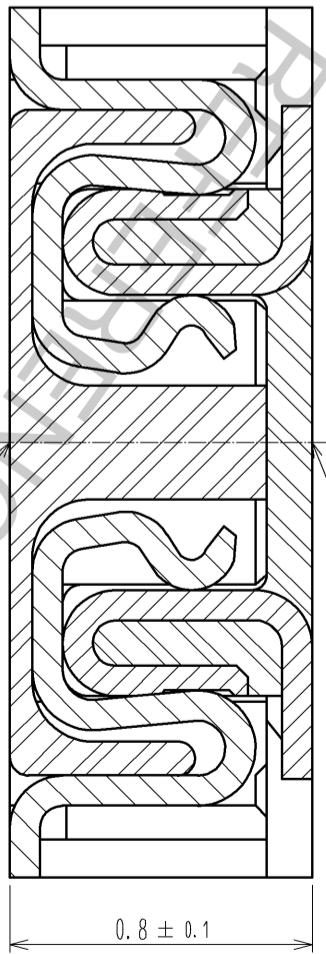

NOTE 1. ALL LEAD CO-PLANARITY SHALL BE 0.08mm MAX

2 CONTACT PLATING SPECIFICATIONS  
 CONTACT AREA : GOLD 0.05 $\mu$ m MIN  
 SMT LEAD : GOLD 0.05 $\mu$ m MIN  
 UNDERPLATING : NICKEL 1 $\mu$ m MIN  
 (SURFACE : SEALING)

3 MATAI FITTING PLATING SPECIFICATIONS  
 SMT LEAD : GOLD 0.05 $\mu$ m MIN  
 UNDERPLATING : NICKEL 1 $\mu$ m MIN  
 (SURFACE : SEALING)

4 HRS MARK AND CAV NO. ARE INDICATED IN APPROX POSITION SHOWN.

5 GATE POSITION IS INDICATED IN APPROX POSITION SHOWN.

NO.	MATERIAL	FINISH . REMARKS	NO.	MATERIAL	FINISH . REMARKS
4	PS	CLEAR (EMBOSSED CARRIER TAPE)	7	PS	CLEAR (REINFORCEMENT COLLAR)
3	BRASS		6	PS	BLACK (PLASTIC REEL)
2	PHOSPHOR BRONZE		5	POLYESTER	CLEAR (COVER TAPE)
1	LCP	UL94 V-0, BLACK			

UNITS	SCALE	COUNT	DESCRIPTION OF REVISIONS	DESIGNED	CHECKED	DATE
mm	10:1					

  

APPROVED : KH. IKEDA	12.03.15	DRAWING NO.	EDC3-332317-01
CHECKED : TS. MIYAZAKI	12.03.15	PART NO.	BM20B(0.8)-30DS-0.4V(51)
DESIGNED : YK. SATAKE	12.03.14	CODE NO.	CL684-9011-9-51
DRAWN : KR. AJITO	12.03.14		

◆ RECOMMENDED PCB LAYOUT

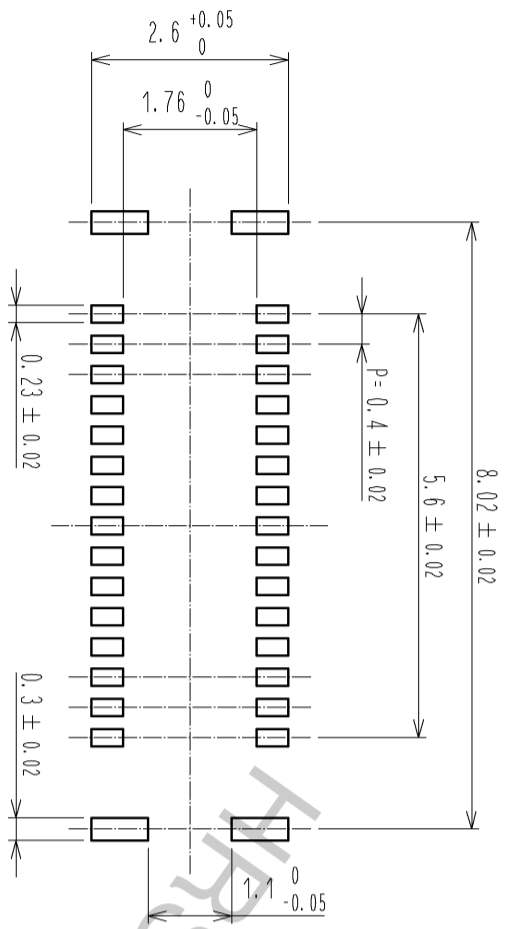

◆ RECOMMENDED METAL MASK DIMENSIONS  
METAL MASK THICKNESS : 100 μm

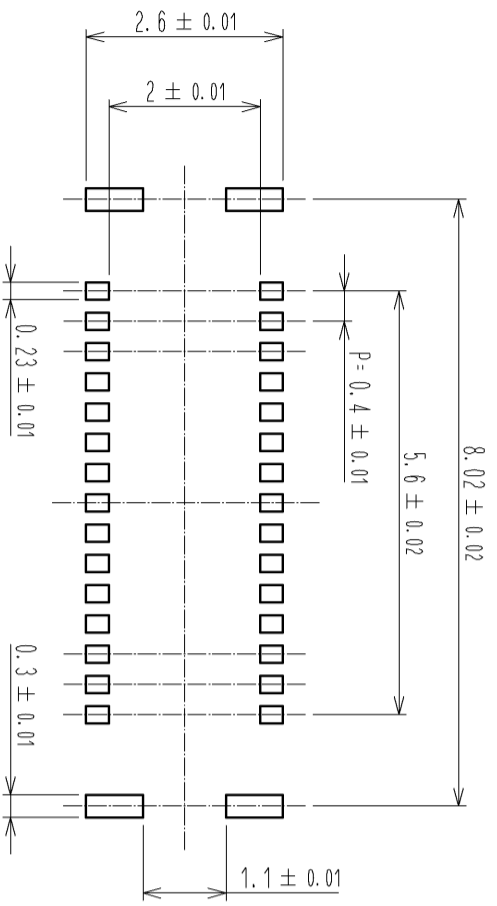

6 RECOMMENDED REFLOW TEMPERATURE PROFILE  
USING LEAD-FREE SOLDER PASTE.

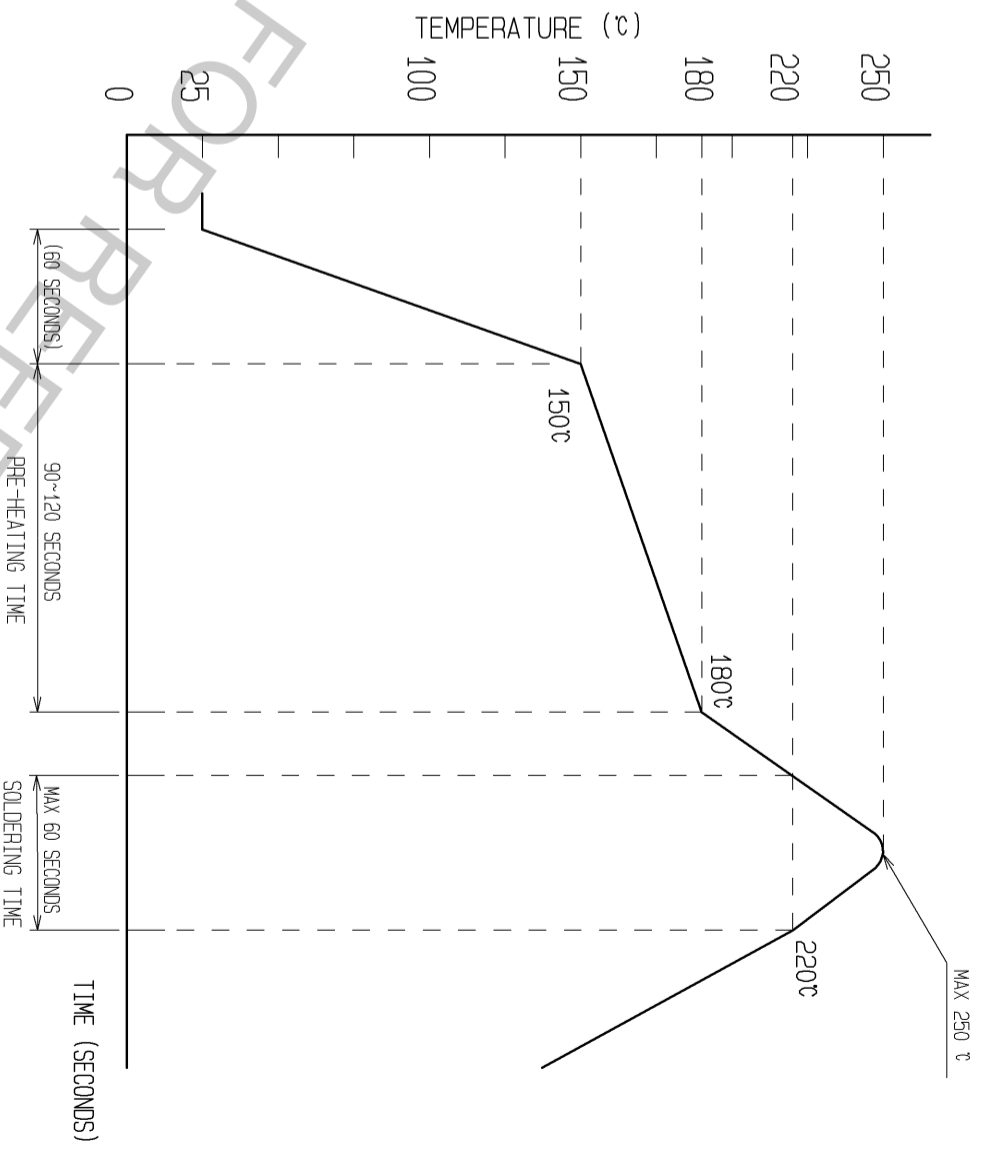

- REFLOW METHOD : IR REFLOW  
NUMBER OF REFLOW CYCLES : 2 CYCLES MAX.  
1) REFLOW TIME  
DURATION ABOVE 220°C: 60 SEC MAX.  
(PEAK TEMPERATURE : 250°C MAX)  
2) PRE-HEAT TIME  
PRE-HEAT TEMPERATURE(MIN): 150°C  
PRE-HEAT TEMPERATURE(MAX): 180°C  
PRE-HEAT TIME: 90-120 SEC.

6 THE TEMPERATURE PROFILE IS PER THE CONDITIONS SHOWN ABOVE. ADDITIONAL FACTORS, SUCH AS SOLDER PASTE TYPE, PCB SIZE AND OTHER MOUNTED COMPONENTS COULD AFFECT THE PROFILE. THEREFORE, A THOROUGH EVALUATION OF MOUNTING CONDITION IS REQUIRED PRIOR TO PRODUCTION. TEMPERATURE IS MEASURED AT CONTACT LEAD.

EMBOSSED CARRIER TAPE PACKAGING (5:1)

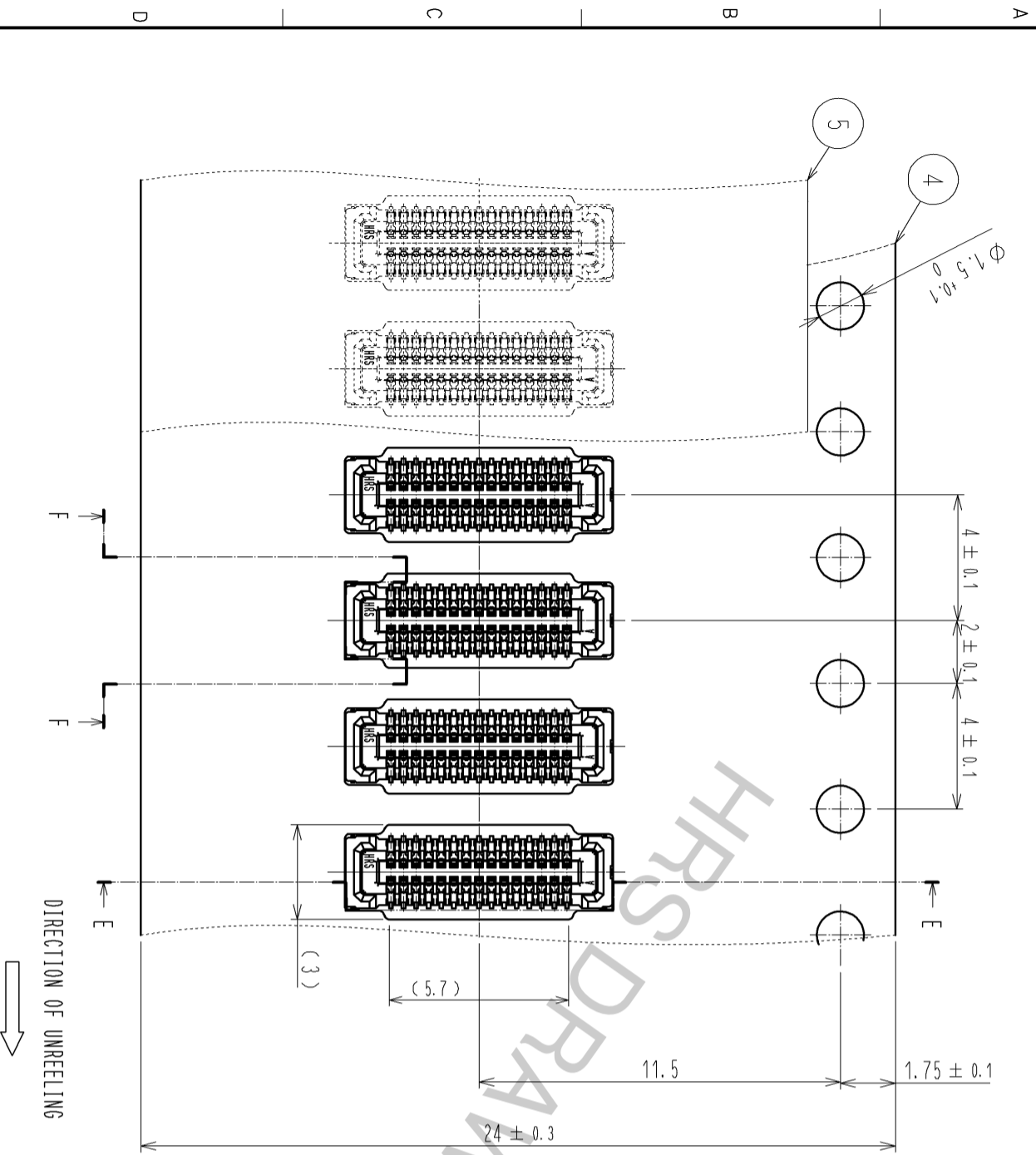

E-E (5:1)

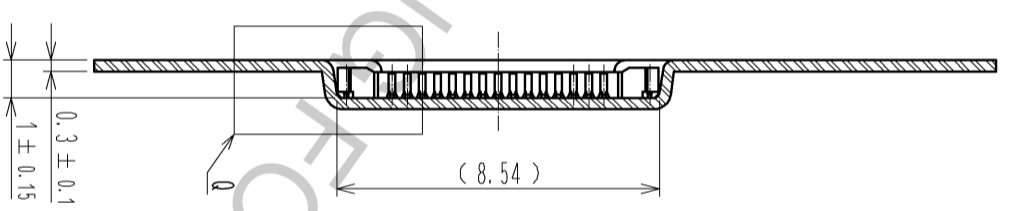

STYLE AND DIMENTION OF REEL (FREE)

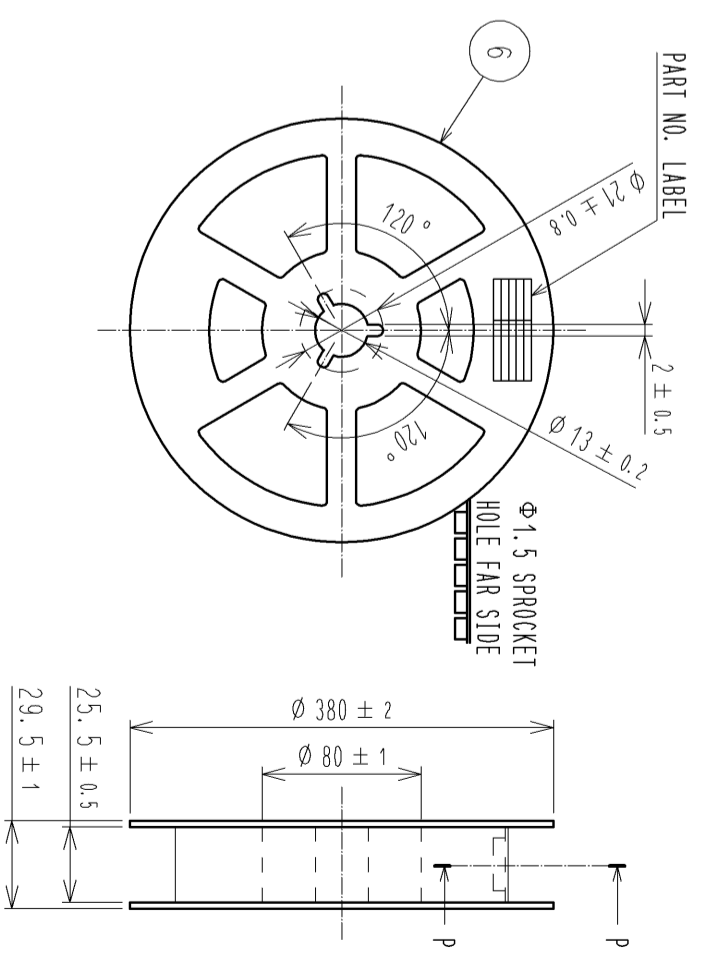

P-P (FREE)

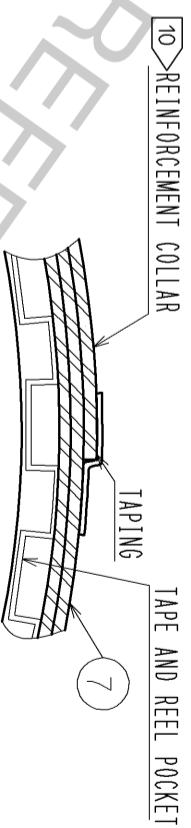

F-F (5:1)

Q(10:1)

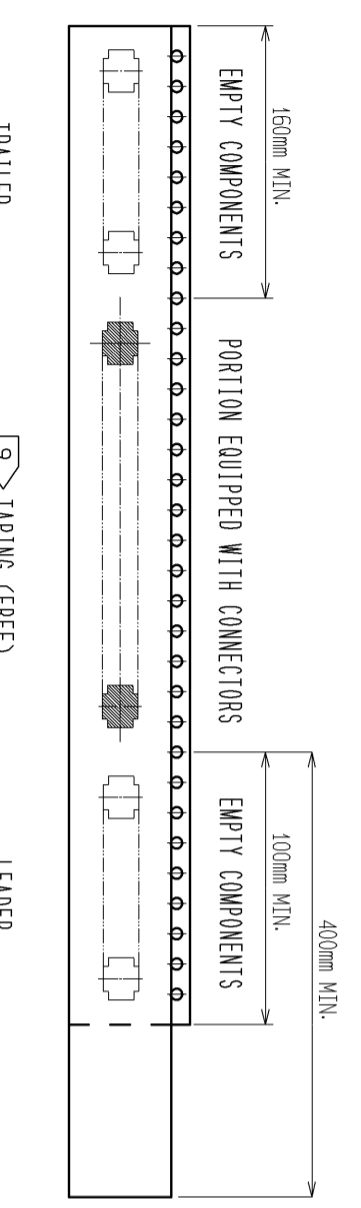

DETAIL OF PART NO. LABEL		DATA OF MANUFACTURED	
製造年月日	*** **	CODE NO.	
製品コード	CL0684-9011-9-(51)	PART NO.	
製品名	BM20B(0.8)-30DS-0.4V(51)	QUANTITY	
数量	8,000	SUPPLIER	
納入者	ヒロセ電機(株)		

- 7. PER REEL 8000 CONNECTORS.
- 8. THE DIMENSIONS IN PARENTHESES ARE FOR REFERENCE.
- 9. REFER TO JIS C 0806(PACKAGING OF COMPONENTS FOR AUTOMATIC HANDLING)
- 10. AFTER PACKAGING, ROLL 2 METERS OF THE REINFORCEMENT COLLAR TO OUTER CIRCUMFERENCE OF TAPE AND REEL POCKET. AND TAPE DOWN AT THE END THE COLLAR.

**HRS**

DRAWING NO.	EDC3-332317-01
PART NO.	BM20B(0.8)-30DS-0.4V(51)
CODE NO.	CL684-9011-9-51