



Chipsmall Limited consists of a professional team with an average of over 10 year of expertise in the distribution of electronic components. Based in Hongkong, we have already established firm and mutual-benefit business relationships with customers from,Europe,America and south Asia,supplying obsolete and hard-to-find components to meet their specific needs.

With the principle of “Quality Parts,Customers Priority,Honest Operation,and Considerate Service”,our business mainly focus on the distribution of electronic components. Line cards we deal with include Microchip,ALPS,ROHM,Xilinx,Pulse,ON,Everlight and Freescale. Main products comprise IC,Modules,Potentiometer,IC Socket,Relay,Connector.Our parts cover such applications as commercial,industrial, and automotives areas.

We are looking forward to setting up business relationship with you and hope to provide you with the best service and solution. Let us make a better world for our industry!



Contact us

Tel: +86-755-8981 8866 Fax: +86-755-8427 6832

Email & Skype: info@chipsmall.com Web: www.chipsmall.com

Address: A1208, Overseas Decoration Building, #122 Zhenhua RD., Futian, Shenzhen, China



MODEL BMK8 - BASE MOUNT KIT FOR CUB7



DESCRIPTION

The BMK8 base mount is designed for use with the CUB7 series products. Wire feed to the CUB7 unit may be through the existing panel/frame or through the hole in the BMK8 itself.

The base mount is constructed of steel with a textured black finish and includes four mounting bolts and nuts.

DIMENSIONS In inches (mm)

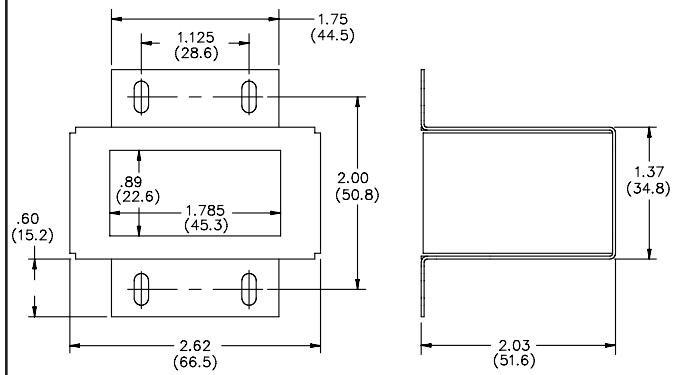

ORDERING INFORMATION

MODEL NO.	DESCRIPTION	PART NUMBER
BMK8	CUB7 BASE MOUNT KIT	BMK80000

For More information on Pricing, Enclosures & Panel Mount Kits refer to the RLC Catalog or contact your local RLC Distributor.

INSTALLATION

1. Mark and drill holes (5/32") in existing panel using the BMK8 as a template. An addition hole may be cut in the existing panel for wire feed.
2. Remove the panel latch (mounting clip) from the CUB7 unit and insert the mounting screws (supplied with the CUB7) on both sides of panel latch. The tip of the screw should not project from the hole in the panel latch (mounting clip).
3. Slide the CUB7 through the cut out in the BMK8 until the bezel flange contacts the base mount. The CUB7 panel gasket is optional.
4. Slide the panel latch (mounting clip) over the rear of the unit and towards the front of the unit until it latches firmly against the inside of the base mount. Note: It is necessary to hold the CUB7 in place when sliding the mounting clip into position.
5. Alternately tighten mounting screws.
6. Route wires through existing panel wire hole or through wire hole on base mount and connect to the appropriate terminals on the CUB7.
7. Mount the CUB7/base mount assembly to the existing panel or frame utilizing the four bolts and nuts provided with the base mount.

