



Chipsmall Limited consists of a professional team with an average of over 10 year of expertise in the distribution of electronic components. Based in Hongkong, we have already established firm and mutual-benefit business relationships with customers from,Europe,America and south Asia,supplying obsolete and hard-to-find components to meet their specific needs.

With the principle of "Quality Parts,Customers Priority,Honest Operation,and Considerate Service",our business mainly focus on the distribution of electronic components. Line cards we deal with include Microchip,ALPS,ROHM,Xilinx,Pulse,ON,Everlight and Freescale. Main products comprise IC,Modules,Potentiometer,IC Socket,Relay,Connector.Our parts cover such applications as commercial,industrial, and automotives areas.

We are looking forward to setting up business relationship with you and hope to provide you with the best service and solution. Let us make a better world for our industry!



## Contact us

Tel: +86-755-8981 8866 Fax: +86-755-8427 6832

Email & Skype: info@chipsmall.com Web: www.chipsmall.com

Address: A1208, Overseas Decoration Building, #122 Zhenhua RD., Futian, Shenzhen, China



### Pushbutton Switches, Splashproof Boot Seals

A wide selection of stock boot seals for pushbuttons are available in a variety of styles and thread sizes. ALCOSWITCH seals replace standard mounting hardware to provide environmental seal. Fabricated of Neoprene in black and optional red or gray. Custom colors and thread sizes are also available on special order.



BP10480

#### 10-48 PUSHBUTTON BOOT SEALS

Splashproof seal designed for "TINY" pushbutton switches having a 10-48 bushing and .14" long button actuators. The hex nut is molded-in to the Neoprene seal. No O-Ring is required. Custom colors are available on special order.

Model	Mount Color	Boot Color	Thread Size	Use with Switch Types
BP10480	Black	Black	10-48	Recommended for TP Series
BP10482	Red	Red	10-48	Recommended for TP Series
BP10488	Gray	Gray	10-48	Recommended for TP Series

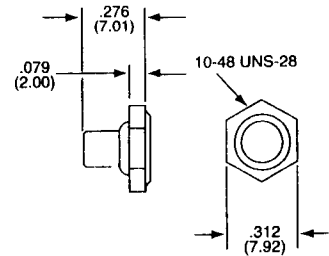

BPA14400



BP14400

#### 1/4-40 PUSHBUTTON BOOT SEALS

Splashproof seals for miniature pushbuttons having a 1/4-40 bushing. The two models allow use with buttons that extend up to .17" (BPA) or up to .33" (BP). The hex nut is molded-in and no O-Ring is required.

Model	Mount Color	Boot Color	Thread Size	Use with Switch Types
BP14400	Black	Black	1/4-40	MSPM, MPA3, MPS and TP Series
BP14402	Red	Red	1/4-40	MSPM, MPA3, MPS and TP Series
BP14408	Gray	Gray	1/4-40	MSPM, MPA3, MPS and TP Series
BPA14400	Black	Black	1/4-40	MSPMBS, MSPMCS, MSP3, MPA3, TP Series
BPA14402	Red	Red	1/4-40	MSPMBS, MSPMCS, MSP3, MPA3, TP Series
BPA14408	Gray	Gray	1/4-40	MSPMBS, MSPMCS, MSP3, MPA3, TP Series

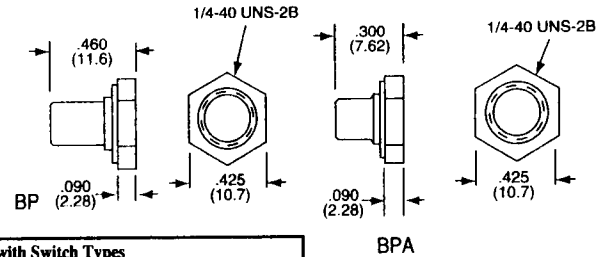

BP20100



BP1900

#### 1/4-40 PUSHBUTTON BOOT SEALS

Splashproof seals having 1/4-40 blind nuts integrally mounted to the black Neoprene seal. Supplied with a captive O-Ring to complete the panel seal. Used with actuators up to .37" long. Choice of two-tone having knurled ring with nickel finish or all black appearance.

Model	Mount Color	Boot Color	Thread Size	Use with Switch Types
BP1900	Nickel	Black	1/4-40	MSPM, MSP3, MPA3 and TP Series
BP2010	Black	Black	1/4-40	MSPM, MSP3, MPA3 and TP Series

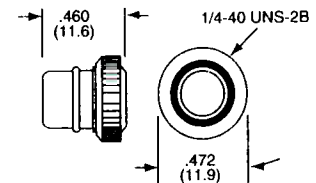

BP15320

#### 15/32-32 PUSHBUTTON BOOT SEALS

Splashproof seals incorporating a molded-in hex nut for washer tight and dust tight protection. Replaces standard hardware usually supplied. Recommended for large size pushbutton switches with actuators extending up to .31" long.

Model	Mount Color	Boot Color	Thread Size	Use with Switch Types
BP15320	Black	Black	15/32-32	MSPF and MPG Series
BP15322	Red	Red	15/32-32	MSPF and MPG Series
BP15328	Gray	Gray	15/32-32	MSPF and MPG Series

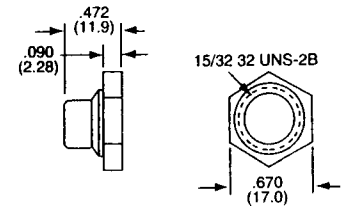

BP5900



BP5890

#### 15/32-32 PUSHBUTTON BOOT SEALS

Splashproof seals having 15/32-32 hex shape mounts integrally bonded onto the black Neoprene seal. Supplied with a captive O-Ring for use against the panel. Readily accepts actuators up to .38" in length. Available in two tone with nickel finish hex-mount, or all black appearance.

Model	Mount Color	Boot Color	Thread Size	Use with Switch Types
BP5890	Nickel	Black	15/32-32	MSPF and MPG Series
BP5900	Black	Black	15/32-32	MSPF and MPG Series

