



Chipsmall Limited consists of a professional team with an average of over 10 year of expertise in the distribution of electronic components. Based in Hongkong, we have already established firm and mutual-benefit business relationships with customers from,Europe,America and south Asia,supplying obsolete and hard-to-find components to meet their specific needs.

With the principle of “Quality Parts,Customers Priority,Honest Operation,and Considerate Service”,our business mainly focus on the distribution of electronic components. Line cards we deal with include Microchip,ALPS,ROHM,Xilinx,Pulse,ON,Everlight and Freescale. Main products comprise IC,Modules,Potentiometer,IC Socket,Relay,Connector.Our parts cover such applications as commercial,industrial, and automotives areas.

We are looking forward to setting up business relationship with you and hope to provide you with the best service and solution. Let us make a better world for our industry!



Contact us

Tel: +86-755-8981 8866 Fax: +86-755-8427 6832

Email & Skype: info@chipsmall.com Web: www.chipsmall.com

Address: A1208, Overseas Decoration Building, #122 Zhenhua RD., Futian, Shenzhen, China



FIG 1:

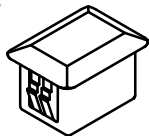

FIG 2:

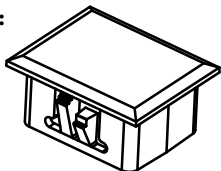
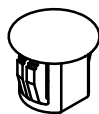

FIG 3:



REV.	MODIFICATION.	DATE	DRN
01	C0-2010730	15/07/09	OW
02	C0-2010780	25/08/09	OW
03	C0-2010881	05/02/10	OW
04	C0-2010984	07/09/10	SF
05	C0-2011040	19/01/11	SF

PARTNo.	"A"	"B"	"C"	"D"	"E"	"L1"	"L2"	PANEL THICKNESS	FIG	COLOR
BPE-SC-1-01	21.5 +0.6 -0 [.85 +.024 -0]	12.8 [.50]	12 [.47]	9.3 [.37]	1.5 [.059]	13 [.512]	9.5 [.374]	1.4 - 3.5 [.550 - .138]	1	BLACK
BPE-SC-2-01	16 [.63]									
BPE-SC-3-01	34.8 [1.37]	25.8 [1.02]				26 [1.024]				
BPE-RJ45-01	17.7[.70]	14.7 [.58]	22[.87]	19.1 [.75]		19.3-20 [.760-.787]	14.9-15 [.587-.591]	0.75[.030], 1.2[.050], 1.6[.060], 2.7 [.110], 3.5 [.140]	2	GREY
BPE-LC-D-01	15 [.59]	13.2 [.52]	15 [.59]	13.2 [.52]	2 [.078]	13.5 [.532]	13.5 [.532]	0.75[.030], 1.2[.050], 1.6[.060], 2.7 [.110], 3.75 [.148]	1	BLACK
BPE-ST1-01	Ø 12 [.47]	Ø 9.2 [.36]	Ø 12 [.47]	7.7 [.30]	1.5 [.059]	Ø 9.4 [.370]	7.9 [.311]	1.4 - 3.5 [.055 - .138]	3	

FIG 1:

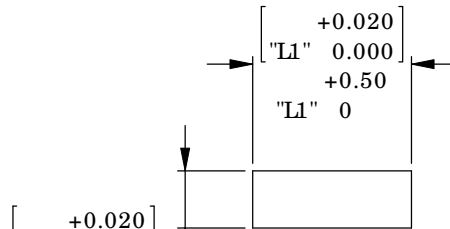
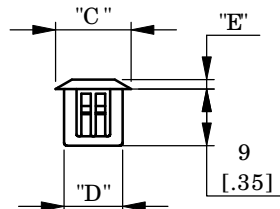
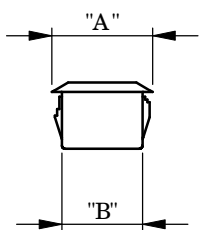

RECOMMENDED MOUNTING HOLE FOR FIG 1 & 2.

FIG 2:

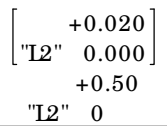
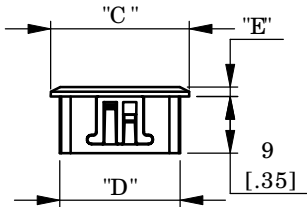
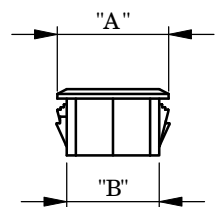

RECOMMENDED MOUNTING HOLE FOR FIG 1 & 2.

FIG 3:

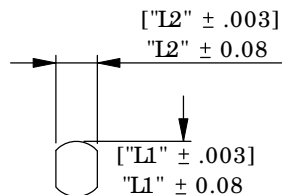
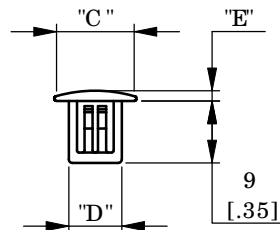
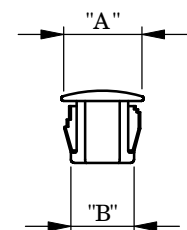

RECOMMENDED MOUNTING HOLE FOR FIG 3.

NOTES:

- 1) ALTERNATE UNITS FOR REFERENCE ONLY
- 2) PARTS AVAILABLE IN OTHER COLORS BY SPECIAL ORDER
- 3) PARTS AVAILABLE IN NYLON 6/6 UL94 V-0(RMS-19) BY SPECIAL ORDER, REPLACE -01 WITH -19 AT END OF PART NUMBER

INFORMATION CONTAINED IN THIS DOCUMENT IS CONFIDENTIAL TO RICHCO INTERNATIONAL Co. Ltd. AND MAY NOT BE DISCLOSED OR REPRODUCED IN WHOLE OR PART WITHOUT THEIR WRITTEN CONSENT

RICHCO, INC.
WWW.RICHCO-INC.COM

ALL DIMENSIONS IN mm
GENERAL TOLERANCES ±0.25
UNLESS OTHERWISE STATED
1 DECIMAL PLACE ±
2 DECIMAL PLACES ±
ANGULAR ±1°

THIRD ANGLE

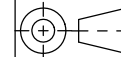

MATERIAL:
NYLON 6/6 UL94 V-2 (RMS-01)

COLOR:
SEE TABLE

DESCRIPTION:
BLANKING PLUGS

PARTNo:
SEE TABLE

DRG No:
09-071

NPR No:
N/A

SHEET SIZE A4

DRN
OW

DATE
15/07/09

CHKD
TC

DATE
15/07/09

SCALE
NTS

SHEETNo.
1 OF 1