



Chipsmall Limited consists of a professional team with an average of over 10 year of expertise in the distribution of electronic components. Based in Hongkong, we have already established firm and mutual-benefit business relationships with customers from,Europe,America and south Asia,supplying obsolete and hard-to-find components to meet their specific needs.

With the principle of “Quality Parts,Customers Priority,Honest Operation,and Considerate Service”,our business mainly focus on the distribution of electronic components. Line cards we deal with include Microchip,ALPS,ROHM,Xilinx,Pulse,ON,Everlight and Freescale. Main products comprise IC,Modules,Potentiometer,IC Socket,Relay,Connector.Our parts cover such applications as commercial,industrial, and automotives areas.

We are looking forward to setting up business relationship with you and hope to provide you with the best service and solution. Let us make a better world for our industry!



Contact us

Tel: +86-755-8981 8866 Fax: +86-755-8427 6832

Email & Skype: info@chipsmall.com Web: www.chipsmall.com

Address: A1208, Overseas Decoration Building, #122 Zhenhua RD., Futian, Shenzhen, China



Copying of this document and giving it to others and the use or communication of the contents thereof, are forbidden without express authority. Offenders are liable to the payment of damages. All rights are reserved in the event of the grant of a patent or the registration of the utility model or design.

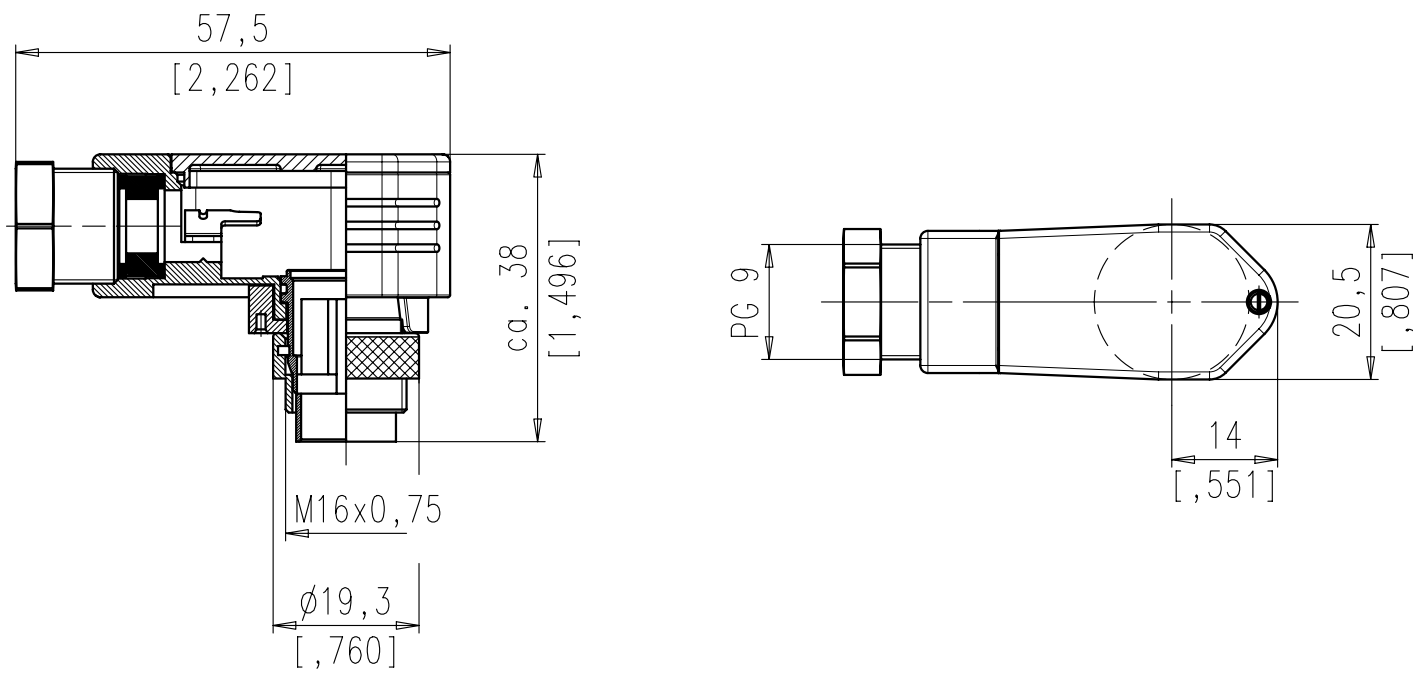

| | | | | | | | | | | |
|---|-----------------------------------------------------------|----------------------------------|------------------------------------------------------------------------------------------------------------------------|---------|--------|---------|---------|--------|---------|---------|
| | Polzahl number of contacts | Norm standard | 3 | 4 | 5 | 5S | 6 | 7 | 7S | 8 |
| D | Kontaktanordnung nach DIN contact arrangement acc. to DIN | | 41 524 | | - | 41 524 | 45 322 | - | 45 329 | 45 326 |
| | Kontaktanordnung nach IEC contact arrangement acc. to IEC | | 60130-9 | 60130-9 | - | 60130-9 | 60130-9 | - | 60130-9 | 60130-9 |
| | Bemessungsspannung rated voltage | IEC 60664-1 | 300V = | | 100V = | 300V = | | 100V = | | |
| | Bemessungsspannung rated voltage | UL 1977 | 250V | | | | | | | |
| | Bemessungs-Stoßspannung rated impulse withstand voltage | IEC 60664-1 | 1500V | | 1200V | 1500V | | 1200V | | |
| | Verschmutzungsgrad pollution degree | IEC 60664-1 | 1 | | | | | | | |
| | Überspannungskategorie installation category | IEC 60664-1 | I | | | | | | | |
| C | Isolierstoffgruppe insulation group | IEC 60664-1 | II, 400 ≤ CTI < 600 | | | | | | | |
| | Strombelastbarkeit current rating | IEC 60512-5-2 Test 5b UL 1977 | 5A / +40°C / +104°F | | | | | | | |
| | Isolationswiderstand insulation resistance | IEC 60512-3-1 Test 3a | >10 ¹⁰ Ω | | | | | | | |
| | Durchgangswiderstand contact resistance | IEC 60512-2-1 Test 2a | < 5m Ω | | | | | | | |
| B | Prüfklasse climatic category | IEC 60668-1 | 40/100/56 | | | | | | | |
| | Temperaturbereich temperatur range | | - 40°C ... +100°C - 40°F ... +212°F | | | | | | | |
| | IP-Schutzart IP-degree | IEC 60529 | IP 67 / IP 65 | | | | | | | |
| A | Steck- und Ziehkraft insertion and withdrawal forces | IEC 60512-13-2 Test 13b | 25 N | 30 N | 35 N | 50 N | 55 N | 60 N | | |
| | Mechanische Lebensdauer mechanical operation | IEC 60512-9-1 Test 9a | silber/silver ≥ 500 Steckzyklen/mating cycles gold/gold ≥ 1000 Steckzyklen/mating cycles | | | | | | | |
| | Werkstoff Gehäuse housing material | | Zink-Druckguß, Oberfläche vernickelt die cast, nickel plated | | | | | | | |
| | Werkstoff Kontaktträger dielectric material | | Thermoplast thermoplastic | | | | | | | |
| | Werkstoff Dichtung sealing material | | Neoprene neoprene | | | | | | | |
| | Kontaktoberfläche contact plating | | versilbert/vergoldet * silver plated/gold/plated | | | | | | | |
| | Anschlusstechnik termination technique | | crimpen crimp | | | | | | | |
| | Anschlussquerschnitt wire gauge | | crimpen 2 - 6 pol (exclusive 5S): 0,09 - 1,00 mm ² crimpen 5S, 7, 7S, 8 pol: 0,09 - 0,75 mm ² | | | | | | | |
| | Brennbarkeit flamability | | UL 94 V0 | | | | | | | |
| | Verriegelung locking system | IEC 60130-9 | schrauben; Anzugsmoment 0,5 - 0,7Nm metal screw coupling; tightening torque 0,5 - 0,7Nm | | | | | | | |

| | | |
|---------------|----------------------------|------------------------------------|
| | 8 IEC | C091 11K008 001 2 |
| | 7 IEC | C091 11K107 001 2 |
| | 7 | C091 11K007 001 2 |
| | 6 | C091 11K006 001 2 |
| | 5 | C091 11K005 001 2" |
| | 5 IEC | C091 11K105 001 2" |
| | 4 | C091 11K004 001 2" |
| | 3 | C091 11K003 001 2" |
| SYMBOL symbol | POLZAHL number of contacts | TYP-NUMMER-CRIMP type-number-crimp |

Diese Steckverbinder dürfen betriebsmäßig nicht unter Spannung betätigt werden. Metallene Gehäuseteile sind sicher mit dem Schutzleitersystem zu verbinden.
 Do not connect or disconnect under load. Metal housing parts shall be securely incorporated to protected ground.

Kontakte bitte separat bestellen siehe M-N 01 015 00XX X
 please order contact separately acc. to M-N 01 015 00XX X

Teile entsprechen der Richtlinie 2002/95/EG (RoHS)/
 parts according to directive 2002/95/EG (RoHS)

* Lieferbar auf Anfrage
 available upon request

| | | | | | | | | | |
|--------------------------------------------|--|--------------------------|--|----------------------------------|--|---------------------|--|----------------------|--|
| Gewicht (errechnet)/ Calc WT: 9 | | Zul. Abw./Tolerances: | | Maßstab/Scale 1:1 | | A3 | | | |
| Prüfmaß/Testdimension | | DIN 6784 | | CUSTOMER DRAWING | | | | | |
| Teileindex Partindexnumber | | 04 | | Datum/Date | | Name | | Kabelstecker PG7 | |
| | | Gez. Drawn | | 31.08. | | Brauer | | male cable connector | |
| | | Gepr. Checked | | | | ? | | | |
| 02 200700144 22.11.07 CI | | 01 200400530 31.08.04 DB | | Amphenol-Tuchel Electronics GmbH | | M C091 11KXXX 001 2 | | Blatt/Sheet 1 | |
| Index Änderung/Description Datum/Date Name | | Ers. f./Similar to: | | | | | | 1 Bl. | |