



Chipsmall Limited consists of a professional team with an average of over 10 year of expertise in the distribution of electronic components. Based in Hongkong, we have already established firm and mutual-benefit business relationships with customers from,Europe,America and south Asia,supplying obsolete and hard-to-find components to meet their specific needs.

With the principle of “Quality Parts,Customers Priority,Honest Operation,and Considerate Service”,our business mainly focus on the distribution of electronic components. Line cards we deal with include Microchip,ALPS,ROHM,Xilinx,Pulse,ON,Everlight and Freescale. Main products comprise IC,Modules,Potentiometer,IC Socket,Relay,Connector.Our parts cover such applications as commercial,industrial, and automotives areas.

We are looking forward to setting up business relationship with you and hope to provide you with the best service and solution. Let us make a better world for our industry!



Contact us

Tel: +86-755-8981 8866 Fax: +86-755-8427 6832

Email & Skype: info@chipsmall.com Web: www.chipsmall.com

Address: A1208, Overseas Decoration Building, #122 Zhenhua RD., Futian, Shenzhen, China



THIS COPY IS PROVIDED ON A RESTRICTED BASIS AND IS NOT TO BE USED IN ANY WAY DETRIMENTAL TO THE INTERESTS OF PANDUIT CORP.

NOTES:

1. DIMENSIONS IN [] ARE
IN MILLIMETERS.

PANDUIT PART NO.	MATERIAL	FACE COLOR	PKG. QTY.	THICKNESS	PRODUCT TYPE
C125X030A0T	GMH3	BLACK	500	.030 +/- .010	POLYESTER/ FOAM DATA LABEL
C125X030APT	GMH3-W	WHITE			

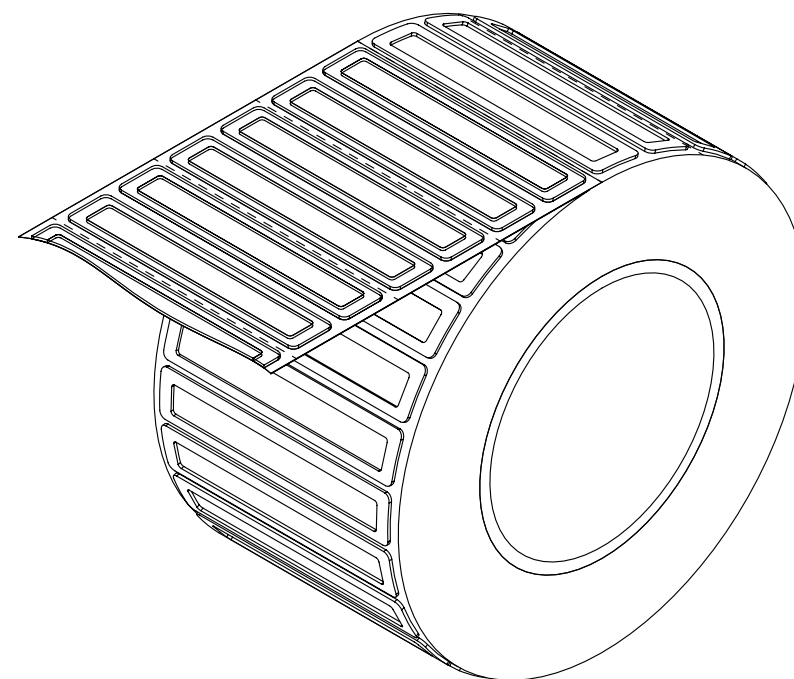
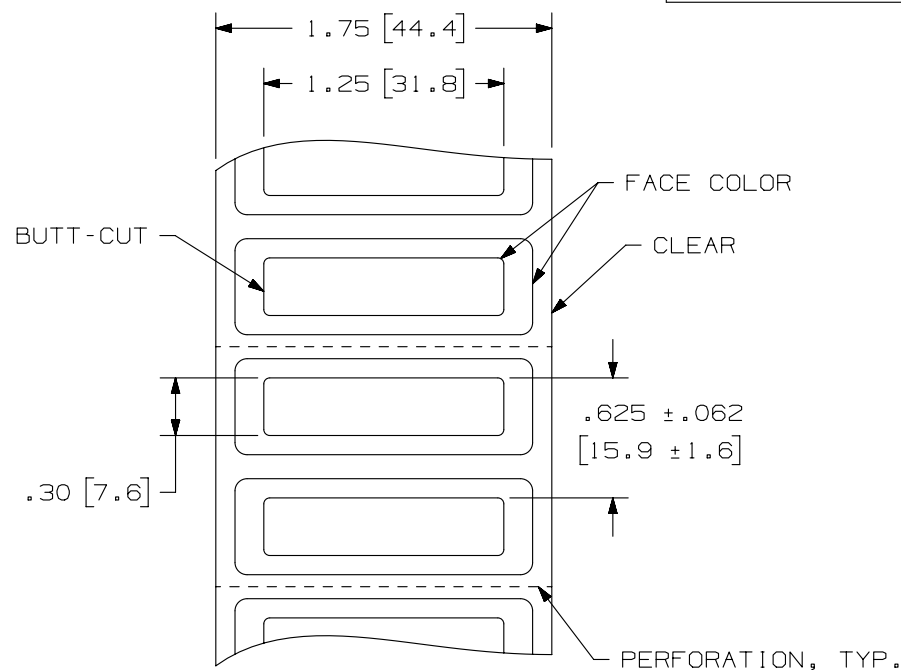

						TITLE	
						RAISED PANEL DATA LABELS	
						C125X030A*T	
						CUSTOMER DRAWING	
						ITEM REVISION NAME	
						100491DL/01	
						DATASET FILE NAME	
						100491DL-DC-C10982/01B	
						UNLESS OTHERWISE SPECIFIED, DIMENSIONAL TOLERANCES ARE: IN [mm]	
						.x ± .12 [3.05] .xxx ± .025 [.635]	
						.xx ± .062 [1.57] ANGLES ±	
						THIRD ANGLE PROJECTION	
						DRAWN BY	
						RVU	
						DATE	
						3/21/12	
						CHK	
						MSAD	
						SCALE	
						NTS	
						SHT 1 OF 1	
						SIZE	
						A	