



Chipsmall Limited consists of a professional team with an average of over 10 year of expertise in the distribution of electronic components. Based in Hongkong, we have already established firm and mutual-benefit business relationships with customers from,Europe,America and south Asia,supplying obsolete and hard-to-find components to meet their specific needs.

With the principle of “Quality Parts,Customers Priority,Honest Operation,and Considerate Service”,our business mainly focus on the distribution of electronic components. Line cards we deal with include Microchip,ALPS,ROHM,Xilinx,Pulse,ON,Everlight and Freescale. Main products comprise IC,Modules,Potentiometer,IC Socket,Relay,Connector.Our parts cover such applications as commercial,industrial, and automotives areas.

We are looking forward to setting up business relationship with you and hope to provide you with the best service and solution. Let us make a better world for our industry!



Contact us

Tel: +86-755-8981 8866 Fax: +86-755-8427 6832

Email & Skype: info@chipsmall.com Web: www.chipsmall.com

Address: A1208, Overseas Decoration Building, #122 Zhenhua RD., Futian, Shenzhen, China



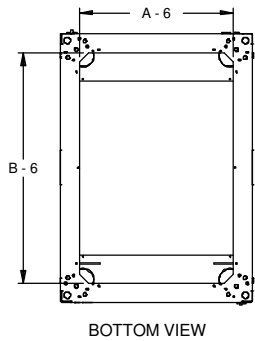
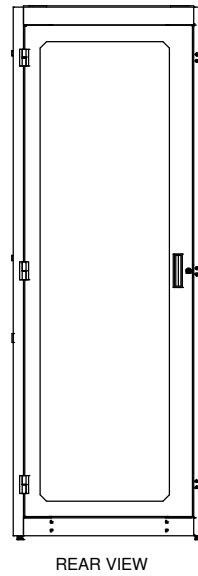
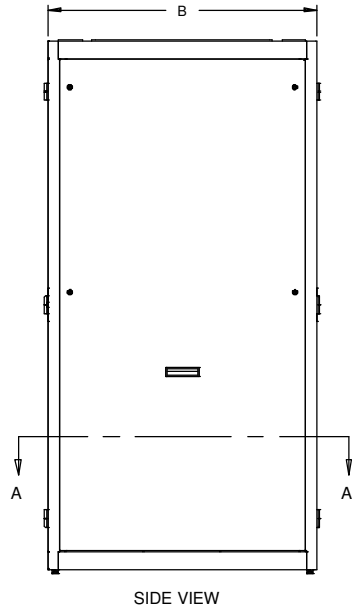
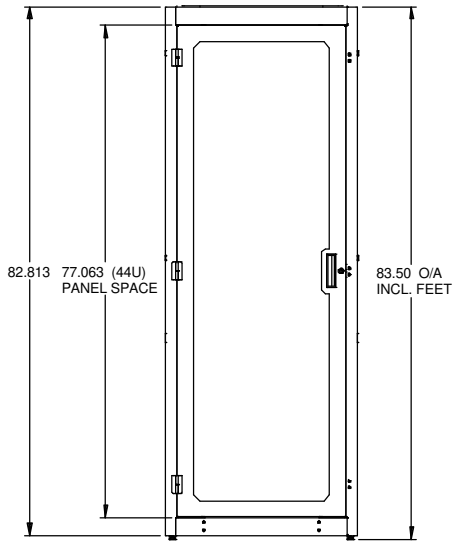
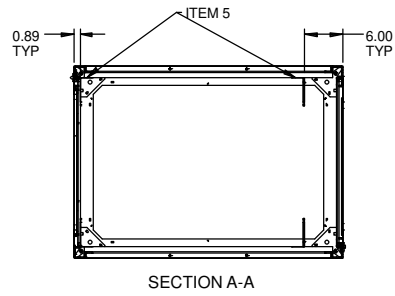
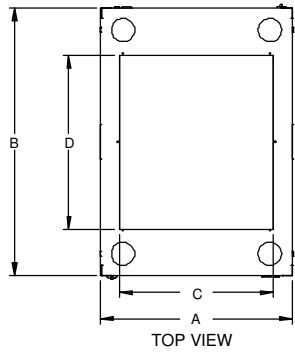

Item #	Description	Qty
1	C4F - CABINET FRAME	1
2	C4D - FLUSH PLEXI DOOR	1
3	C4D - FLUSH VENTED DOOR	1
4	C4SP - SOLID SIDE PANEL	2
5	C4PR - 19" PANEL RAILS, SQ. HOLES	4
6	C4T - TOP PANEL, VENTED/FAN CUTOUTS	1
7	PLUG - 3.50" DIA. HOLE	4

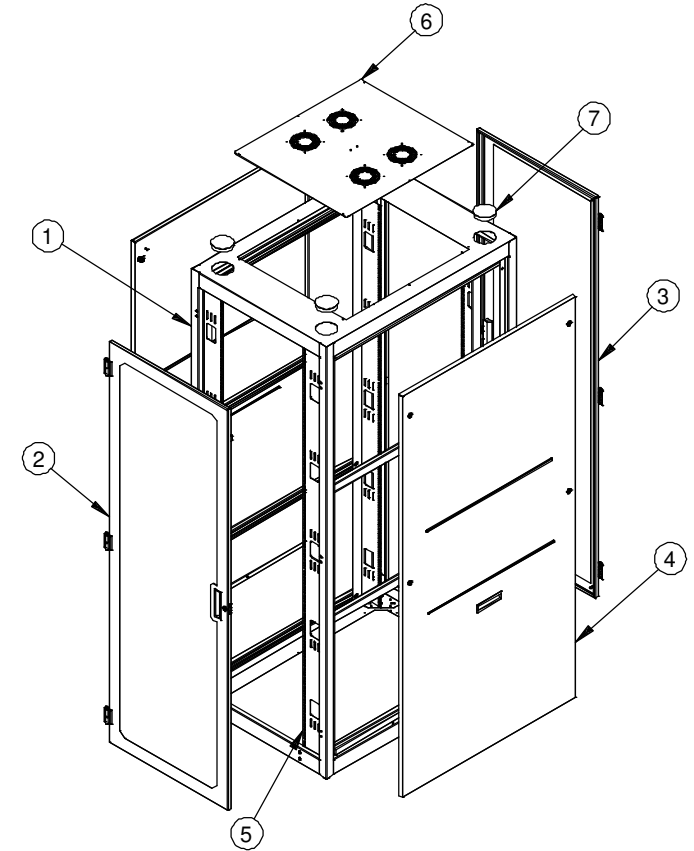

C4RR - DATACOM CABINET ASSEMBLY

COMPONENT NUMBER	A WIDTH	B DEPTH	C	D
C4RR307731D	30.000	31.500	24.062	14.000
C4RR307736D	30.000	36.000	24.062	22.750
PART SHOWN - C4RR307742D	30.000	42.000	24.062	27.250