



Chipsmall Limited consists of a professional team with an average of over 10 year of expertise in the distribution of electronic components. Based in Hongkong, we have already established firm and mutual-benefit business relationships with customers from,Europe,America and south Asia,supplying obsolete and hard-to-find components to meet their specific needs.

With the principle of “Quality Parts,Customers Priority,Honest Operation,and Considerate Service”,our business mainly focus on the distribution of electronic components. Line cards we deal with include Microchip,ALPS,ROHM,Xilinx,Pulse,ON,Everlight and Freescale. Main products comprise IC,Modules,Potentiometer,IC Socket,Relay,Connector.Our parts cover such applications as commercial,industrial, and automotives areas.

We are looking forward to setting up business relationship with you and hope to provide you with the best service and solution. Let us make a better world for our industry!



Contact us

Tel: +86-755-8981 8866 Fax: +86-755-8427 6832

Email & Skype: info@chipsmall.com Web: www.chipsmall.com

Address: A1208, Overseas Decoration Building, #122 Zhenhua RD., Futian, Shenzhen, China



D

C

B

A

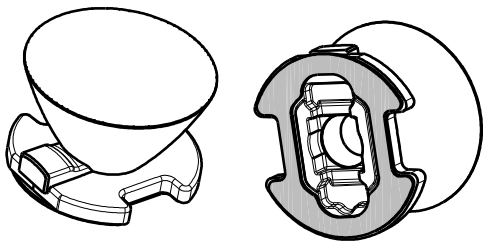

Apollo SS/M/O

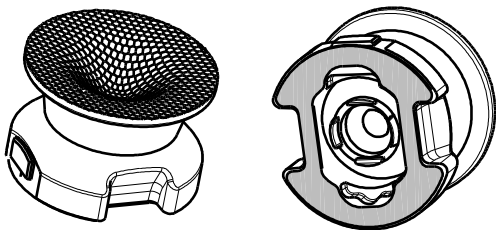

Apollo W

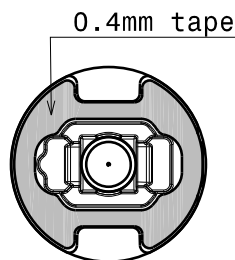

Bottom view

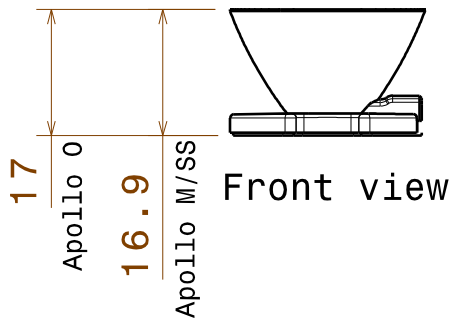
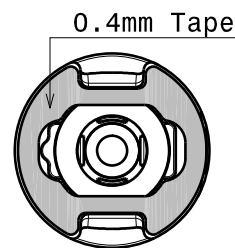

Front view

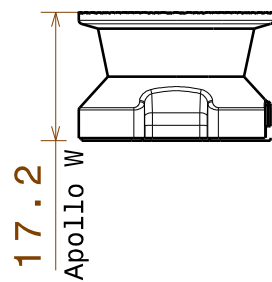

4

4

3

3

2

2

Part no.s:
 CA10243_Apollo-W
 CA10251_Apollo-M
 CA10315_Apollo-SS
 CA10316_Apollo-O
 Material: PMMA

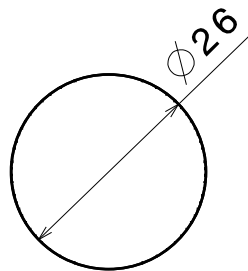

Top view

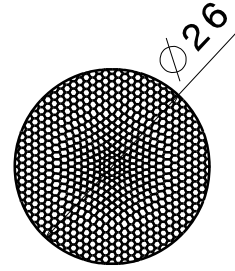

This drawing is our property.
 It can't be reproduced
 or communicated without
 our written agreement.



Ledil Oy
 Tehdaskatu 13
 FIN-24100 SALO
 Finland

DRAWING TITLE

Datasheet Apollo-series

DRAWN BY
 mav

DATE
 28.02.2011

CHECKED BY
 HH

DATE
 28.02.2011

SIZE
 A4

DRAWING NUMBER
 Multiple

REV
 1

DESIGNED BY
 HH

DATE
 18.03.2006

SCALE 1:1 WEIGHT (g)

SHEET 1/1

D

A

1

1