



Chipsmall Limited consists of a professional team with an average of over 10 year of expertise in the distribution of electronic components. Based in Hongkong, we have already established firm and mutual-benefit business relationships with customers from,Europe,America and south Asia,supplying obsolete and hard-to-find components to meet their specific needs.

With the principle of “Quality Parts,Customers Priority,Honest Operation,and Considerate Service”,our business mainly focus on the distribution of electronic components. Line cards we deal with include Microchip,ALPS,ROHM,Xilinx,Pulse,ON,Everlight and Freescale. Main products comprise IC,Modules,Potentiometer,IC Socket,Relay,Connector.Our parts cover such applications as commercial,industrial, and automotives areas.

We are looking forward to setting up business relationship with you and hope to provide you with the best service and solution. Let us make a better world for our industry!



## Contact us

Tel: +86-755-8981 8866 Fax: +86-755-8427 6832

Email & Skype: [info@chipsmall.com](mailto:info@chipsmall.com) Web: [www.chipsmall.com](http://www.chipsmall.com)

Address: A1208, Overseas Decoration Building, #122 Zhenhua RD., Futian, Shenzhen, China



DASH NO	MODEL NO	TYPE
-1	CBBJ82	2-LUG
-2	CBBJ823	3-LUG

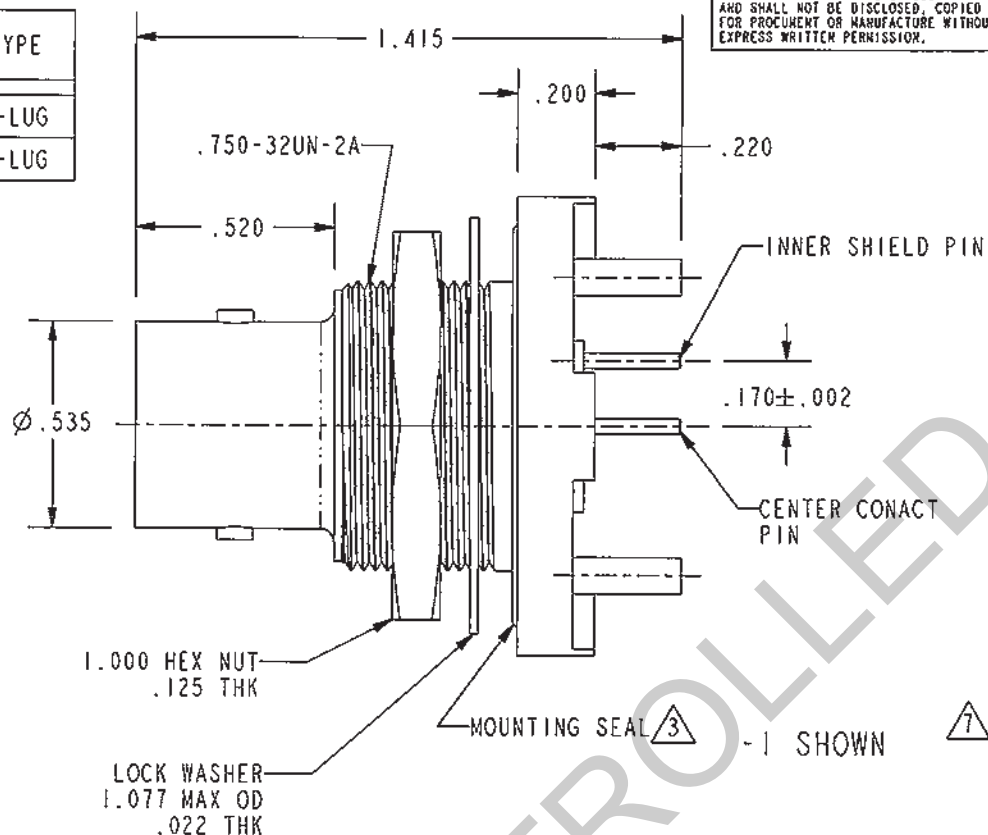

DATA CONTAINED IN THIS DOCUMENT IS PROPRIETARY TO TROMPETER ELECTRONICS INC. AND SHALL NOT BE DISCLOSED, COPIED OR USED FOR PROMOTION OR MANUFACTURE WITHOUT EXPRESS WRITTEN PERMISSION.

REVISIONS			
REV	DESCRIPTIONS	DATE	APPROVED
F	REVISED PER ECO 14566	5/29/02	WJX

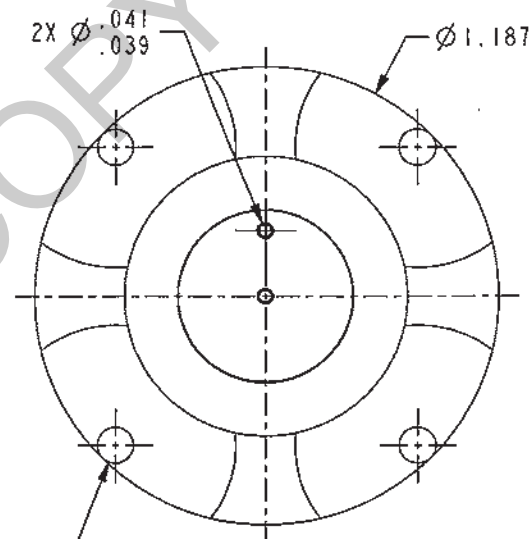

SCALE 1/1

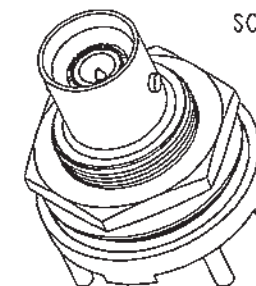

## RED INDICATES ORIGINAL

7 PRE-TINNED, .0015 MAXIMUM THICKNESS WITH SN63 OR EQUIV SOLDER, PER QQ-S-571, TO WITHIN .060 MAXIMUM OF SHOULDER, AFTER PLATING

6. INTERFACE: TCS-BJ80

5. MAX BOARD THK .190

4. MAX PANEL THK .250 (WITH 2 FULL THD EXPOSED)

3 PARKER SEAL NO. 2-021S604-70 (.926 GLAND ID)

2. FINISH: TFS-1A (NICKEL)

1. CONCENTRIC TWINAX/TRIAX, SERIES TRC, CIRCUIT BOARD/BULKHEAD JACK

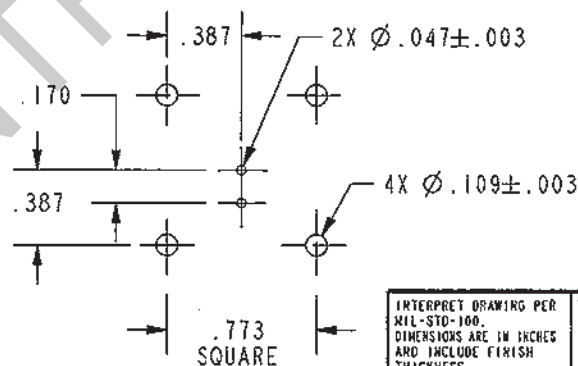

RECOMMENDED  
MTG HOLE PATTERN  
SCALE 1/1

INTERPRET DRAWING PER MIL-STD-100. DIMENSIONS ARE IN INCHES AND INCLUDE FINISH THICKNESS UNLESS OTHERWISE SPECIFIED.		TOL: UNLESS SPECIFIED. .XX ± .02 .XXX ± .005 ANGLE ± 1°	
DRN	JCM 5-28-02	MATERIAL:	
CHK	5/29/02	FINISH:	
QUALITY	5/29/02	SEE NOTE 2	
MANUF	5/29/02	DO NOT SCALE DWG	
APPROVED	WJX 5/29/02	SCALE 2/1	
PROJECT NO.	3-0041	DATE 7-12-79	

**TROMPETER**  
RF connectivity  
a cinch connectivity solutions brand

CBBJ82/CBBJ823

SIZE	CAGE CODE	DRAWING NO.	REV.
A	14949	3-0041	F
DATE	SHEET		
7-12-79	IC		

NOTES: UNLESS OTHERWISE SPECIFIED.

NEXT ASSY