



Chipsmall Limited consists of a professional team with an average of over 10 year of expertise in the distribution of electronic components. Based in Hongkong, we have already established firm and mutual-benefit business relationships with customers from,Europe,America and south Asia,supplying obsolete and hard-to-find components to meet their specific needs.

With the principle of “Quality Parts,Customers Priority,Honest Operation,and Considerate Service”,our business mainly focus on the distribution of electronic components. Line cards we deal with include Microchip,ALPS,ROHM,Xilinx,Pulse,ON,Everlight and Freescale. Main products comprise IC,Modules,Potentiometer,IC Socket,Relay,Connector.Our parts cover such applications as commercial,industrial, and automotives areas.

We are looking forward to setting up business relationship with you and hope to provide you with the best service and solution. Let us make a better world for our industry!



Contact us

Tel: +86-755-8981 8866 Fax: +86-755-8427 6832

Email & Skype: info@chipsmall.com Web: www.chipsmall.com

Address: A1208, Overseas Decoration Building, #122 Zhenhua RD., Futian, Shenzhen, China



THIS COPY IS PROVIDED ON A RESTRICTED BASIS AND IS NOT TO BE USED IN ANY WAY DETRIMENTAL TO THE INTERESTS OF PANDUIT CORP.

A

PANDUIT PART#	COLOR	DESCRIPTION	WEIGHT
CC5E88BL	BLACK	MINI-COM CAT5e COUPLER MODULE	1.32 LB/100 PCS (600g/100 PCS)
CC5E88IW	INT. WHITE		
CC5E88GR	GREEN		
CC5E88BU	BLUE		
CC5E88OR	ORANGE		

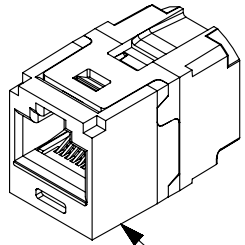

COUPLER MODULE

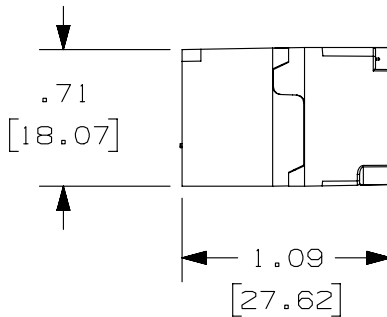
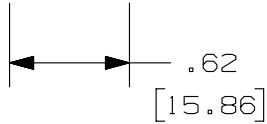
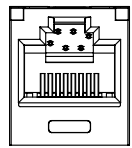

NOTES:

- CATEGORY 5e/CLASS D 8-POSITION FEMALE-TO-FEMALE COUPLER MODULE.
- MATERIAL:
MODULE HOUSING - UL94-V0 ABS
MODULE CIRCUIT BOARD - GLASS REINFORCED EPOXY RESIN
MODULE CONTACT CARRIER - UL94-V0 ABS
- DIMENSIONS IN PARENTHESES ARE IN METRIC.
- COMPATIBLE WITH ALL PANDUIT MINI-COM FACEPLATES AND MODULAR PATCH PANELS. NOT COMPATIBLE WITH SURFACE MOUNT BOXES.
- ACTS AS A SINGLE CONNECTOR IN CATEGORY 5e/CLASS D CHANNELS
- c(UL)US LISTED-UL FILE NUMBER E129886
- ALSO AVAILABLE AS 24-PORT COUPLER PATCH PANEL, PART NUMBER CP245E88BLY.

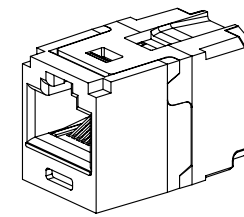

FRONT

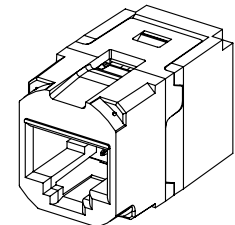

REAR

ACTUAL SIZE

PART NUMBER		CC5E88**	
TITLE			
MINI-COM CAT5E COUPLER MODULE			
CUSTOMER DRAWING			
ITEM REVISION NAME		M02037CD/02	
DATASET FILE NAME		M02037CD_DC11/02A	
UNLESS OTHERWISE SPECIFIED, DIMENSIONAL TOLERANCES ARE: IN [mm]		MATERIAL:	
.x ± .1 [2.54] .xxx ± .005 [.127]		SEE NOTE 2	
.xx ± .01 [.25] ANGLES ± 5 °		DRAWING NUMBER:	
		02037-11	
DRAWN BY	DATE	CHK	SCALE
MDJr	12-21-04	CEF	FULL
REV	DATE	BY	CHK
APR			
DESCRIPTION		ECN	
SHT 1 OF 1		A	

REV	DATE	BY	CHK	APR	DESCRIPTION	ECN
4	6-20-14	MDJR	REFR	EJH	A. ADDED PART NUMBERS FOR GREEN, BLUE, AND ORANGE COLORS.	02037-11
3	2-3-14	BJN	EJH	EJH	UPDATED	02037-11

D10100DA/14

2

1