



Chipsmall Limited consists of a professional team with an average of over 10 year of expertise in the distribution of electronic components. Based in Hongkong, we have already established firm and mutual-benefit business relationships with customers from,Europe,America and south Asia,supplying obsolete and hard-to-find components to meet their specific needs.

With the principle of “Quality Parts,Customers Priority,Honest Operation,and Considerate Service”,our business mainly focus on the distribution of electronic components. Line cards we deal with include Microchip,ALPS,ROHM,Xilinx,Pulse,ON,Everlight and Freescale. Main products comprise IC,Modules,Potentiometer,IC Socket,Relay,Connector.Our parts cover such applications as commercial,industrial, and automotives areas.

We are looking forward to setting up business relationship with you and hope to provide you with the best service and solution. Let us make a better world for our industry!



## Contact us

Tel: +86-755-8981 8866 Fax: +86-755-8427 6832

Email & Skype: info@chipsmall.com Web: www.chipsmall.com

Address: A1208, Overseas Decoration Building, #122 Zhenhua RD., Futian, Shenzhen, China



**ALL DIMENSIONS ARE REFERENCE  
(SEE XC-169-XX-XX-X-XX FOR CONTROLLING PRINT)**

DO NOT  
SCALE FROM  
THIS PRINT

CC69X-XXXX-01-X-XX

SUPPLIED  
-L: LOOSE  
-R: REEL

MATERIAL SPECIFICATION  
-SP: STANDARD POWER  
\* -HP: HIGH POWER

LEAD STYLE  
-2024 (20-24 AWG)  
-1620 (16-20 AWG)  
-2426 (24-26 AWG)(PTFE)

PLATING  
-T: MATTE TIN

OPTION  
(INSULATION THICKNESS)  
-01

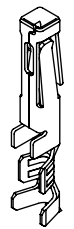

(SEE PP-C-169-XX-XX-X FOR PLATING INSTRUCTIONS)  
\* = EXISTING CUSTOMERS ONLY AS OF REV P

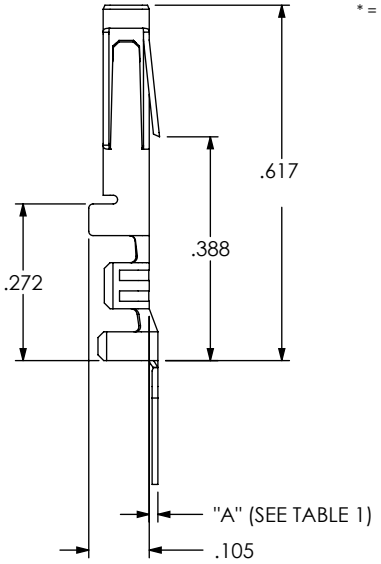
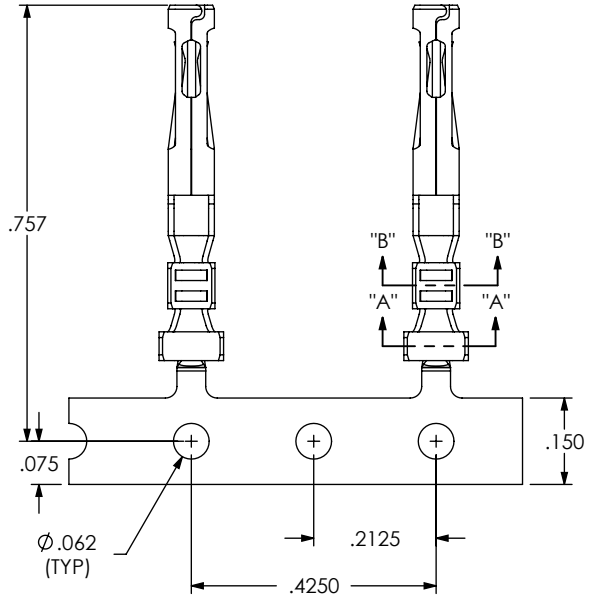
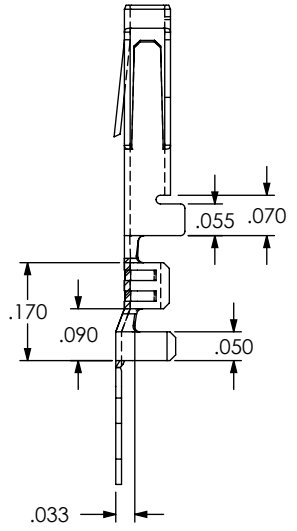
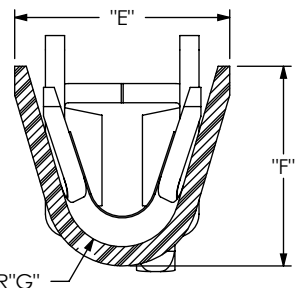
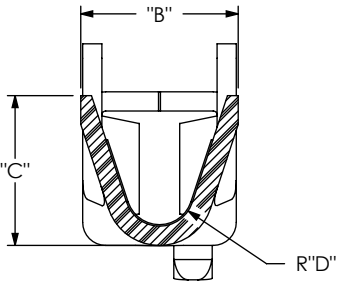

FIG 1  
(CC69X-XXXX-01-X-XX SHOWN)



SECTION "A"-"A"  
SCALE 10 : 1



SECTION "B"-"B"  
SCALE 10 : 1

- NOTES:
1. PLATED XC-169 PARTS TO BE PULLED, PLATING OPTION CONFIRMED, POSITIONED AS SHOWN ON SAMTEC REEL WITH VIEWPORTS, LABELED CC69R WITH APPROPRIATE PLATING CALLOUT AND LABEL PLACED AS SHOWN.
  2. MAXIMUM NO OF SPLICES PER REEL: 2.
  3. SPLICES ARE NOT TO BE CONNECTED.
  4. NUMBER OF SPLICES TO BE MARKED ON EACH REEL.
  5. REELED PARTS TO BE INTERLEAVED WITH PAPER BETWEEN EACH LAYER OF PARTS.
  6. ALLOWABLE INTERLEAF SPLICES PER REEL: 3.
  7. SECURELY CONNECT INTERLEAF SPLICE.
  8. OUTER WRAP SHALL RECEIVE PROTECTIVE REEL BAND PER BELOW: RB-24-1.00-P.
  9. DUE TO PLATING REQUIREMENTS CONTACT SAMPLES MAY BE REMOVED INTERMITTINGLY FROM THE CARRIER RESULTING IN SMALL GAPS BUT DOES NOT AFFECT FINAL COUNT.
  10. QTY PER REEL: 4,000 +100/-0 PCS.

TABLE 1									
STYLE	"A"	"B"	"C"	"D"	"E"	"F"	"G"	"H"	"J"
-2024	.015	.082	.078	.018	.112	.104	.030	.005	30
-1620	.025	.110	.115	.025	.184	.168	.055	.005	30
-2426	.015	.082	.078	.018	.080	.067	.020	.005	30

UNLESS OTHERWISE SPECIFIED, DIMENSIONS ARE IN INCHES. TOLERANCES ARE:  
DECIMALS ANGLES

**PROPRIETARY NOTE**  
THIS DOCUMENT CONTAINS INFORMATION CONFIDENTIAL AND PROPRIETARY TO SAMTEC, INC. AND SHALL NOT BE REPRODUCED OR TRANSFERRED TO OTHER DOCUMENTS OR DISCLOSED TO OTHERS OR USED FOR ANY PURPOSE OTHER THAN THAT WHICH IT WAS OBTAINED WITHOUT THE EXPRESSED WRITTEN CONSENT OF SAMTEC, INC.



520 PARK EAST BLVD, NEW ALBANY, IN 47150  
PHONE: 812-944-6733 FAX: 812-948-5047  
e-Mail: info@SAMTEC.com code 55322

MATERIAL: DO NOT SCALE DRAWING SHEET SCALE: 3:1  
-SP: PHOS BRONZE  
-HP: HIGH COPPER ALLOY  
THICKNESS: .0100

DESCRIPTION: .165 IPBD CONTACT  
DWG. NO. CC69X-XXXX-01-X-XX

REVISION X

TABLE 2								
P/N	AWG	STRANDS / AWG	INSULATION OD	"K"	"L"	"M"	"R" MAX (VESTIGE LENGTH)	"S" MAX (TAB LENGTH)
CC69X-2024-X	24	7/32	0.053-0.059	.0360	.0580	.128	.0020	.0200
	22	7/30	0.059-0.065	.0390	.0580	.128	.0020	.0200
	20	7/28	0.0660-0.0720	.0410	.0580	.128	.0020	.0200
CC69X-1620-X	20	7/28	0.097-0.103	.0470	.0740	.115	.0020	.0200
	18	16/30	0.107-0.113	.0520	.0740	.115	.0020	.0200
	18TC	19/30	0.0655-0.0688	.0520	.0740	.115	.0020	.0200
	16	26/30	0.121-0.125	.0620	.0740	.128	.0020	.0200
CC69X-2426-X	24TC	7/32	0.041-0.047	.0380	.0580	.128	.0020	.0200

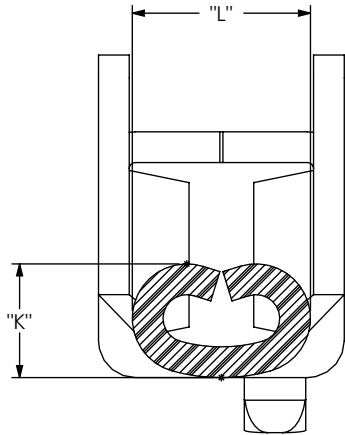

WIRE CRIMP  
SCALE 16:1

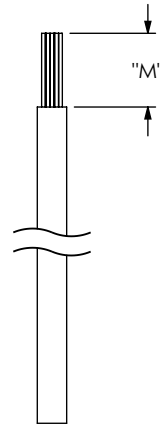

INSULATOR STRIP LENGTH

FIG 2  
RECOMENDED PROCESSING

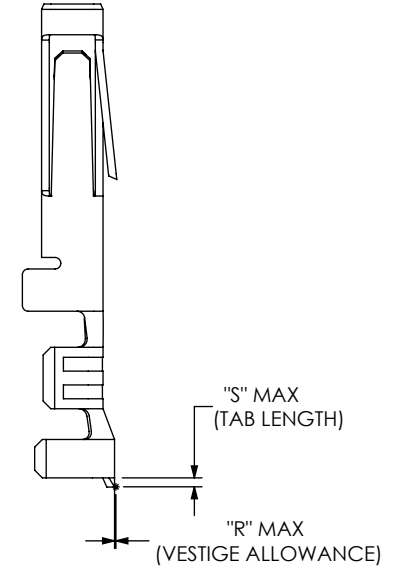

CARRIER TAB SPECIFICATION  
SCALE 4:1

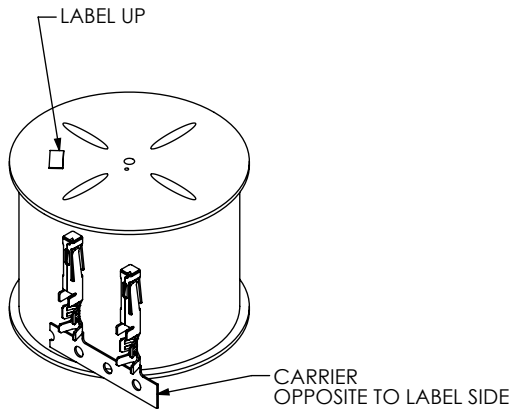

UNWINDING DIRECTION

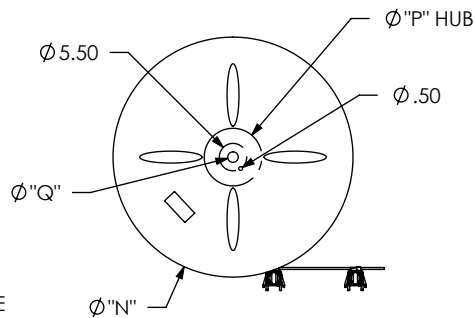

FIG 3  
REEL SPECIFICATIONS

TABLE 3				
SUPPLIED	REEL PART NUMBER	"N"	"P"	"Q"
-R	R-24-08.00-1.00-P	24.00	8.000	1.125

**PROPRIETARY NOTE**  
THIS DOCUMENT CONTAINS INFORMATION CONFIDENTIAL AND PROPRIETARY TO SAMTEC, INC. AND SHALL NOT BE REPRODUCED OR TRANSFERRED TO OTHER DOCUMENTS OR DISCLOSED TO OTHERS OR USED FOR ANY PURPOSE OTHER THAN THAT WHICH IT WAS OBTAINED WITHOUT THE EXPRESSED WRITTEN CONSENT OF SAMTEC, INC.

DO NOT SCALE DRAWING

SHEET SCALE: 3:1

**samtec**

520 PARK EAST BLVD, NEW ALBANY, IN 47150  
PHONE: 812-944-6733 FAX: 812-948-5047  
e-Mail: info@SAMTEC.com code 55322

DESCRIPTION:  
.165 IPBD CONTACT

DWG. NO.  
CC69X-XXXX-01-X-XX

BY: BRATCHER 10/7/04

SHEET 2 OF 2