



Chipsmall Limited consists of a professional team with an average of over 10 year of expertise in the distribution of electronic components. Based in Hongkong, we have already established firm and mutual-benefit business relationships with customers from,Europe,America and south Asia,supplying obsolete and hard-to-find components to meet their specific needs.

With the principle of “Quality Parts,Customers Priority,Honest Operation,and Considerate Service”,our business mainly focus on the distribution of electronic components. Line cards we deal with include Microchip,ALPS,ROHM,Xilinx,Pulse,ON,Everlight and Freescale. Main products comprise IC,Modules,Potentiometer,IC Socket,Relay,Connector.Our parts cover such applications as commercial,industrial, and automotives areas.

We are looking forward to setting up business relationship with you and hope to provide you with the best service and solution. Let us make a better world for our industry!



Contact us

Tel: +86-755-8981 8866 Fax: +86-755-8427 6832

Email & Skype: info@chipsmall.com Web: www.chipsmall.com

Address: A1208, Overseas Decoration Building, #122 Zhenhua RD., Futian, Shenzhen, China



REV.	N° DCR	NATURE DE LA MODIFICATION	DATE	VISA
D	ECR-1877	Contact forces values updated (A4)	11/02/2008	V.P
E	ECR-2137	0.85 ± 0.1/0.15 → 0.75 ± 0.1 (D2)	11/04/2008	V.P
	ECR-4868	Contact forces values 0.8 → 0.65N and 0.5 → 0.35N	23/12/2009	GP

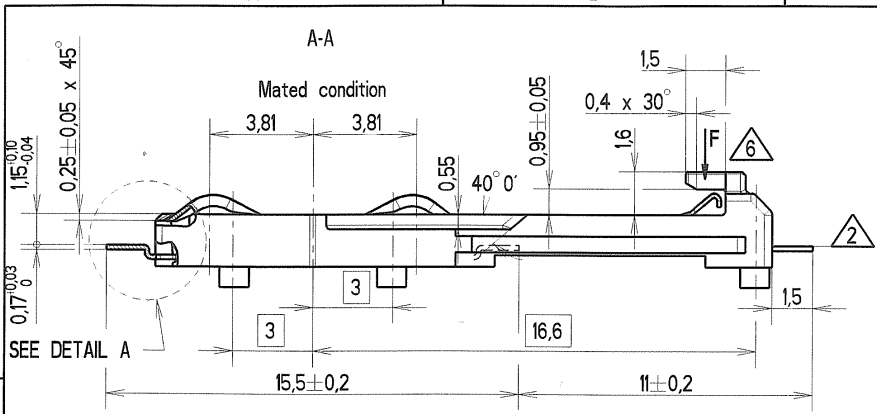

DETAIL A
Scale 10

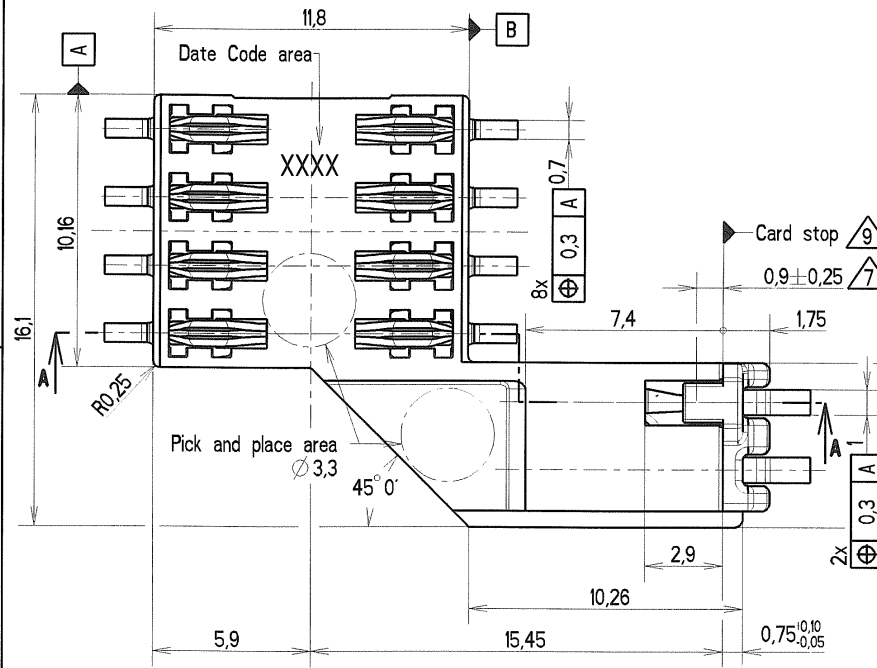

- Notes :
- 1 - Termination to PCB : SMT reflow soldering. Temperature/time profile according to C&K PS-LF-001 specification.
 - 2 - Level of each contact tail compared to the surrounding base of the insulator. Coplanarity of metal soldering surfaces : 0,1 mm.
 - 3 - Recommendation for solder paste thickness > 0,2 mm.
 - 4 - 2,5 microns min tin plating on contact terminal areas and 0,1 microns min gold plating on switch terminal areas.
 - 5 - Contact forces :
 - max 0,65 N per contact at 0,2 from Card seating area.
 - min 0,35 N per contact at 0,2 from Card seating area.

- 6 - Force F required on end travel switch NO :
 - max 0,8 N to activate the switch.
 - max 1,8 N for complete actuator depression.
- 7 - Card end travel switch NO activates when the sliding card is 0,9 mm from card stop.
- 8 - Precious metal inlay on signal contacts.
- 9 - End stop must be put on rear side of the connector for mechanical strength.
- 10 - For packaging on tape and reel, see documents : cu 030282Y0021.

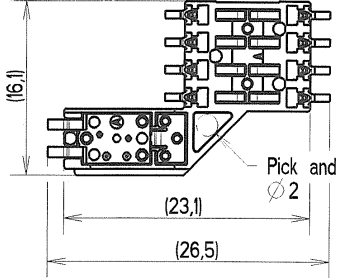
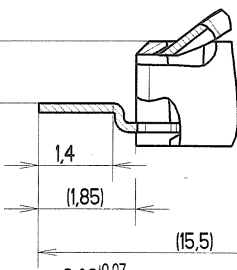

Scale 2

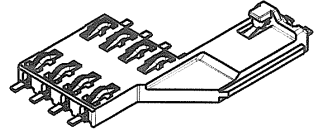

SYSTEM CONFIDENTIAL

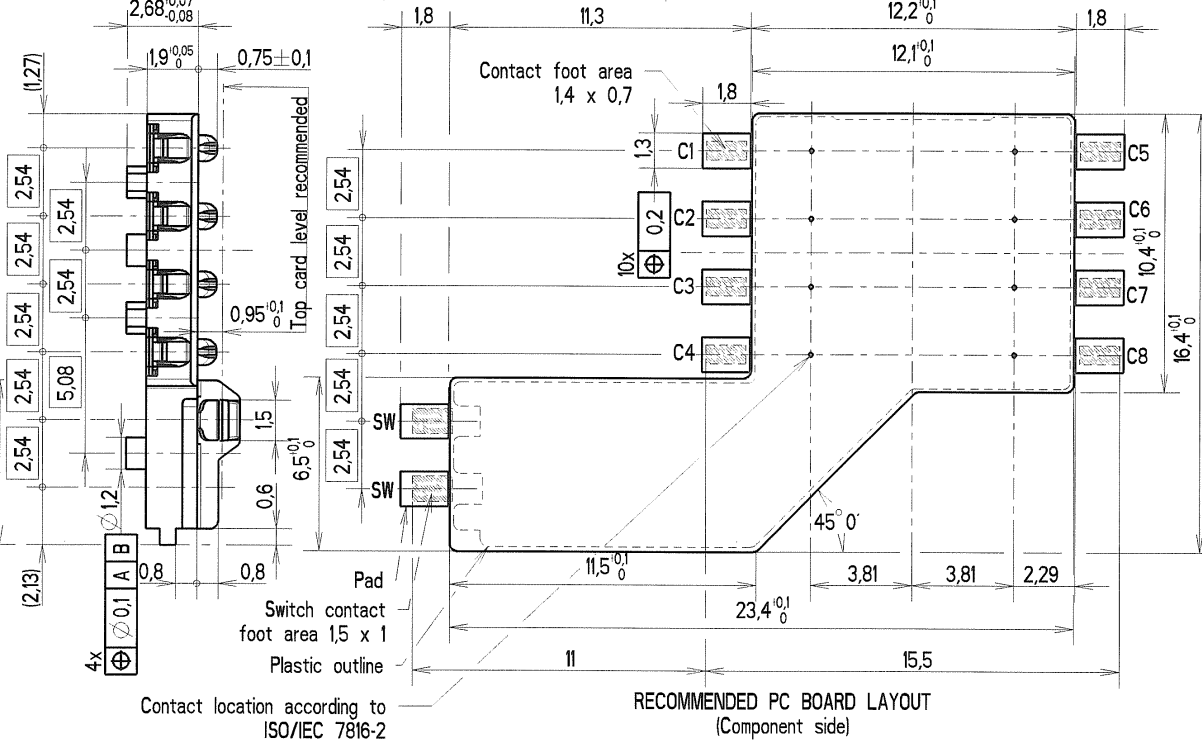

CE PLAN EST LA PROPRIETE DE C&K - COMPONENTS SAS ET NE PEUT ETRE REPRODUIT OU COMMUNIQUE SANS SON AUTORISATION

MATIERE	TRAITEMENT	PROTECTION
SAUF INDIQUE :	TOL. LINEAIRE ± 0,1	TOL. ANGULAIRE ± 2 °
- COTES DONNEES AVANT PROTECTION	ETAT DE SURFACE Ra	DIMENSIONS CRITIQUES ▼
- BAVURES ET ARETES VIVES SUPPRIMEES		DIMENSIONS SPC ▼
DESSINE P.DAUBIGNEY	DATE 05-08-05	ANALYSE N TAB. FAM. Y PRO/E Y LANGAGE E
VERIFIE G.PINON	DATE	
APPROUVE L.KUBAT	DATE 11/01/2010	REPLACE
G&K C&K Components	PROJECTION TER DIEDRE	DESIGNATION
	ECHELLE 5	CCM04-520LFT 2x4 contacts + switch NO + card retention + 4 stand-offs
BP 359 - 39105 Dole - FRANCE -	TAILLE FEUILLE A3 1 / 1	NUMERO REV CU 030288Y5202 E