



Chipsmall Limited consists of a professional team with an average of over 10 year of expertise in the distribution of electronic components. Based in Hongkong, we have already established firm and mutual-benefit business relationships with customers from,Europe,America and south Asia,supplying obsolete and hard-to-find components to meet their specific needs.

With the principle of “Quality Parts,Customers Priority,Honest Operation,and Considerate Service”,our business mainly focus on the distribution of electronic components. Line cards we deal with include Microchip,ALPS,ROHM,Xilinx,Pulse,ON,Everlight and Freescale. Main products comprise IC,Modules,Potentiometer,IC Socket,Relay,Connector.Our parts cover such applications as commercial,industrial, and automotives areas.

We are looking forward to setting up business relationship with you and hope to provide you with the best service and solution. Let us make a better world for our industry!



## Contact us

Tel: +86-755-8981 8866 Fax: +86-755-8427 6832

Email & Skype: info@chipsmall.com Web: www.chipsmall.com

Address: A1208, Overseas Decoration Building, #122 Zhenhua RD., Futian, Shenzhen, China



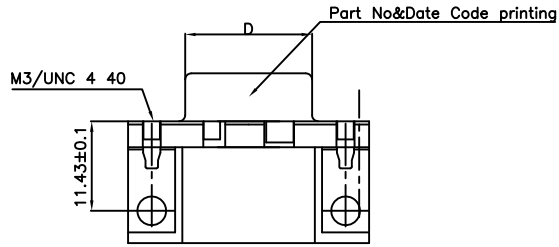

SIZE	DIMENSIONS						
	A±0.38	B±0.12	C±0.10	D <sup>+0.25</sup> <sub>-0</sub>	E	F	G
14/15	30.81	24.99	16.96	16.21	8.19	2.28	1.14
26	39.14	33.32	25.18	24.54	8.01	2.285	1.14
44	53.03	47.04	39.12	38.25	8.02	2.285	1.14

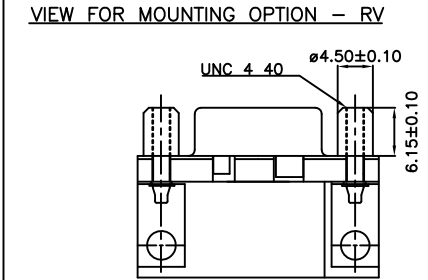
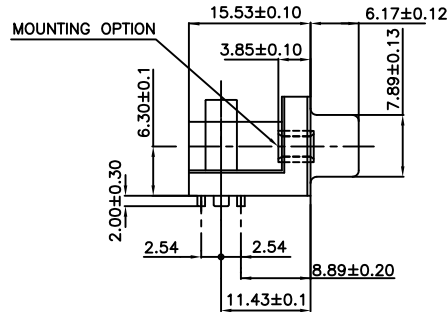
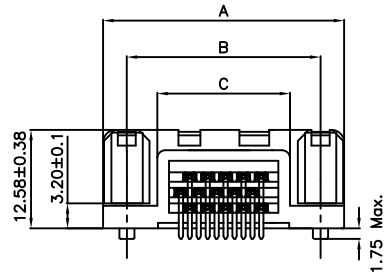
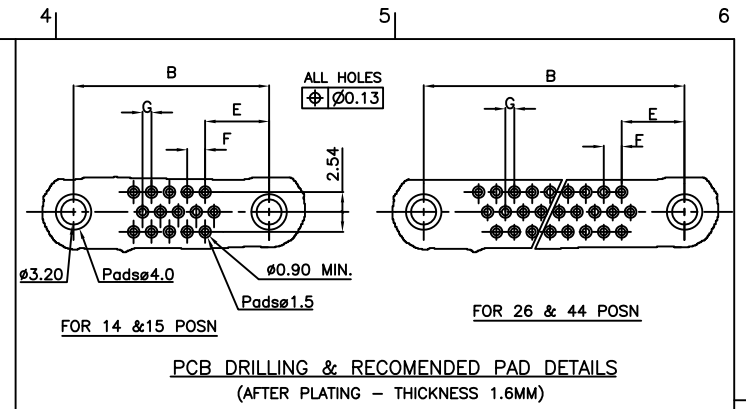

**ORDERING INFORMATION**

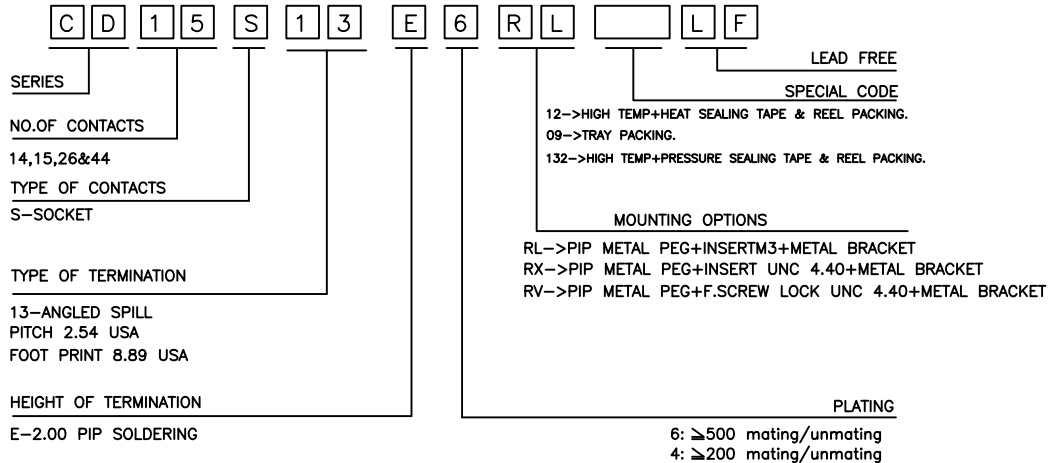

"This product meets European Union Directives and other country regulations as described in GS-47-0004"

The housing will withstand exposure to 260°C peak temperature for 30 seconds in a convection, infra-red or vapor reflow oven solder application.

Packaging as per GS-14-920

TRUE POSITION :  $\varnothing 0.36$

**PRODUCT SPECIFICATION**

See :- GS-12-607

**PACKAGING SPECIFICATION**

See :- GS-14-1139 - Tape & Reel Packing  
See :- GS-14-1157 - Tray Packing

- NOTES :
- GENERAL VIEW IS FOR MOUNTING OPTION - RX/RL
  - FOR 14 POSN , HOLE NO:9 IS BLOCKED

mat'l. code		surface ISO 1302		tolerance ISO 406 ISO 1101		projection		product family COMPACT D	
ltr	ecn no	dr	date	tolerances unless otherwise specified		MM		title	
A	107-0166	AS	2007-12-4	angles	linear	0.0±0.1		C-D A/S FEMALE PIP CONNECTOR	
B	109-0130	AS	2009-7-8			0.0±0.1			
C	109-0202	NG	2009-9-24			0.00±0.00X		scale -	
D	111-0052	RPK	2011-3-17	dr	ANISH.SALAM	2007-12-04		dwg no	
E	ELX-1-21007	AB	2015/06/03	enrg	ALIAS.BABU	2015/06/03		sheet 1 of 1	
				chr	MITHUN.PAUL	2015/06/03		size A3	
				appd	BIJU.K.PAUL	2015/06/03		type Product Customer Drawing	
sheet index	revision sheet	E	1						