



Chipsmall Limited consists of a professional team with an average of over 10 year of expertise in the distribution of electronic components. Based in Hongkong, we have already established firm and mutual-benefit business relationships with customers from,Europe,America and south Asia,supplying obsolete and hard-to-find components to meet their specific needs.

With the principle of “Quality Parts,Customers Priority,Honest Operation,and Considerate Service”,our business mainly focus on the distribution of electronic components. Line cards we deal with include Microchip,ALPS,ROHM,Xilinx,Pulse,ON,Everlight and Freescale. Main products comprise IC,Modules,Potentiometer,IC Socket,Relay,Connector.Our parts cover such applications as commercial,industrial, and automotives areas.

We are looking forward to setting up business relationship with you and hope to provide you with the best service and solution. Let us make a better world for our industry!



Contact us

Tel: +86-755-8981 8866 Fax: +86-755-8427 6832

Email & Skype: info@chipsmall.com Web: www.chipsmall.com

Address: A1208, Overseas Decoration Building, #122 Zhenhua RD., Futian, Shenzhen, China



PART NO.	"A"	"B"	"C"	MATERIAL (COLOR)
CFCC-3-05A-RT	.563±.025	.46 (11.7)	.18 (4.6)	NORYL, RMS-05 (WHITE)
CFCC-4-05A-RT	(14.29±0.64)	.40 (10.2)	.25 (6.4)	
CFCC-8-05A-RT	1.062±.030	.880±.025	.25 (6.4)	
CFCC-8-04A-RT	(26.97±0.76)	(22.35±0.64)	.25 (6.4)	RIGID PVC, RMS-04 (GREY)

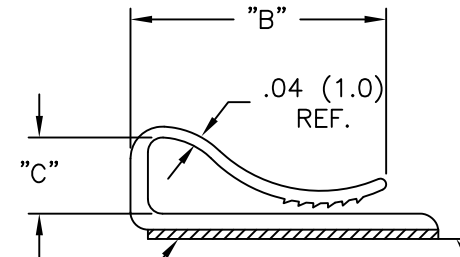
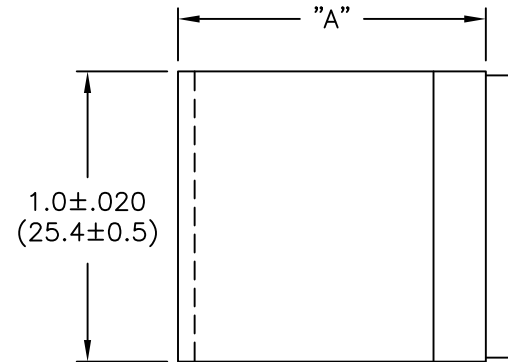

NOTES:

1. ACRYLIC ADHESIVE TAPE (RMS-15), WHITE LINER.
2. RUBBER ADHESIVE TAPE (RMS-102), BLUE LINER, AVAILABLE BY SPECIAL ORDER ONLY.
TO ORDER, REPLACE "A-RT" WITH "A1-RT" ON PART NO.
PARTS ARE ALSO AVAILABLE WITHOUT TAPE BY SPECIAL ORDER.
TO ORDER, REMOVE SUFFIX "-A-RT" FROM THE PART NO.
3. CUSTOM LENGTHS AVAILABLE BY SPECIAL ORDER.

DOUBLE SIDED ADHESIVE TAPE
1/32 (0.8) THICK FOR -3
1/16 (1.6) THICK FOR -4 & -8

TYPICAL RELEASE
TAB LOCATION

N	SEE CO 200660 FOR CHANGES	SK 04.18.11
M	SEE CO 200615 FOR CHANGES	SK 01.10.11
L	SEE ECN #980 FOR CHANGES	SK 04.12.05
K	SEE ECN #635 FOR CHANGES	SM 05.27.03
J	ADDED RUBBER ADHESIVE BY SPECIAL ORDER	SM 09.11.02
I	ADDED NOTE 1 & CORRECTED METRIC DIM.	SJ 3.13.02
H	CORRECTED TAPE NOTE	SM 12.13.01
G	ADDED RMS-05 AND RMS-04 TO MATERIAL	SM 12.11.01
F	CHANGED FILE NO. AND TITLE BLOCK	SM 07.20.01
E	ADDED ±.020 TOL. A DIM	JK 9.1.99
D	CONVERTED TO ACAD	PB 06.21.95
C	ADD MAT'L, COLOR	RS 10.29.92
B	ADDED PART NO. CFCC-8-04A-RT ADD SUFFIX "A" IN ALL P/N'S	RS 06.22.92
A	ADDED CFCC-3 TO CHART	AH 03.07.90
REV	DESCRIPTION	ENGR DATE

TITLE: CONTINUOUS FLAT CABLE CLAMPS		DWG IN IN (MM)	FINAL	PRINT TYPE
FILE #	CFCC	DWN: P.B.	APP: DLC	CA
MAT'L:	SEE TABLE	DT: 06-21-94	DT: 09/11/02	
RE:	RICHCO, INC.	RICHCO INC. PO BOX 804238, CHICAGO, 60680 (773) 539-4060		
TOLERANCES UNLESS NOTED .XX=±.020 .XXX=±.015 FRAC=±1/32 ANG=±1°		PART # SEE TABLE		