



Chipsmall Limited consists of a professional team with an average of over 10 year of expertise in the distribution of electronic components. Based in Hongkong, we have already established firm and mutual-benefit business relationships with customers from,Europe,America and south Asia,supplying obsolete and hard-to-find components to meet their specific needs.

With the principle of “Quality Parts,Customers Priority,Honest Operation,and Considerate Service”,our business mainly focus on the distribution of electronic components. Line cards we deal with include Microchip,ALPS,ROHM,Xilinx,Pulse,ON,Everlight and Freescale. Main products comprise IC,Modules,Potentiometer,IC Socket,Relay,Connector.Our parts cover such applications as commercial,industrial, and automotives areas.

We are looking forward to setting up business relationship with you and hope to provide you with the best service and solution. Let us make a better world for our industry!



Contact us

Tel: +86-755-8981 8866 Fax: +86-755-8427 6832

Email & Skype: info@chipsmall.com Web: www.chipsmall.com

Address: A1208, Overseas Decoration Building, #122 Zhenhua RD., Futian, Shenzhen, China



THIS COPY IS PROVIDED ON A RESTRICTED BASIS AND IS NOT TO BE USED IN ANY WAY DETRIMENTAL TO THE INTERESTS OF PANDUIT CORP.

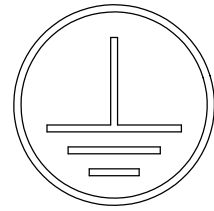
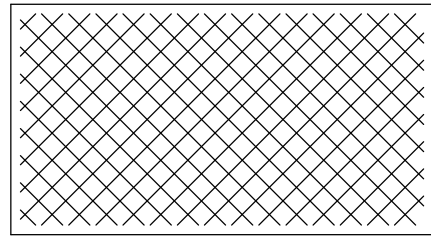

UNIVERSAL GROUNDING STICKER (QTY. 2)



5cc TUBE ANTI-OXIDANT PASTE (QTY. 1)

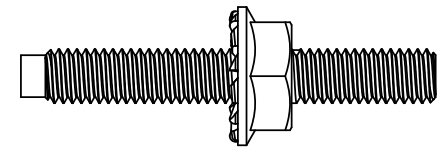

#10-32 & M5 BONDING STUD (QTY. 8 OF EACH)

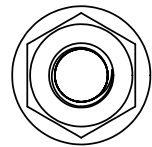

#10-32 & M5 BONDING NUT (QTY. 16 OF EACH)

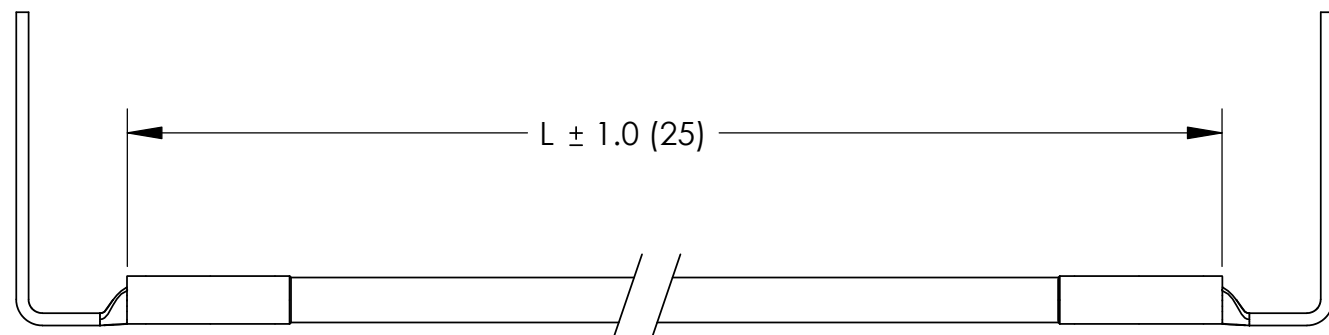

FACTORY CRIMPED #6 AWG FRONT TO BACK RAIL JUMPER GREEN/YELLOW INSULATION (QTY. 2)

PART NUMBER	L
CGJ620UA	20.00 (508)
CGJ630UA	30.00 (762)
CGJ640UA	40.00 (1016)

NOTES:

1. CABINET GROUNDING JUMPER KIT
PART NUMBERS: CGJ620UA, CGJ630UA, CGJ640UA
2. PACKAGING: 1 KIT PER BAG
3. DIMENSIONS IN PARENTHESIS ARE MILLIMETERS.
4. ALL COMPONENTS THAT MAKE UP THIS KIT ARE ROHS COMPLIANT.



LISTED
GROUNDING AND BONDING EQUIPMENT



CERTIFIED

C41627_01

							PANDUIT CORP. TINLEY PARK, ILLINOIS		
							FRONT TO BACK RAIL JUMPER KITS (CGJ620UA, CGJ630UA, CGJ640UA) CUSTOMER DRAWING		
							UNLESS OTHERWISE SPECIFIED DIMENSIONAL TOLERANCES ARE: (.X) ± (.XXX) ± (.XX) ± ANGLES ±		
							UNLESS OTHERWISE SPECIFIED, ALL DIMENSIONS ARE GIVEN IN INCHES, THIRD ANGLE PROJECTION		
01	3/06	JHNU	JHNU	REVISED DRAWING TITLE	PC00329		DRAWN BY JHNU	MAT'L:	SCALE NONE
00	1/06	JHNU	JMAR	DRAWING RELEASED	PC00276		DATE 1/06		DRAWING NO / CAD FILE C41627
REV	DATE	BY	CHK	DESCRIPTION	ECN	PM	CUST	CHK'D	DWG B SIZE