



Chipsmall Limited consists of a professional team with an average of over 10 year of expertise in the distribution of electronic components. Based in Hongkong, we have already established firm and mutual-benefit business relationships with customers from,Europe,America and south Asia,supplying obsolete and hard-to-find components to meet their specific needs.

With the principle of "Quality Parts,Customers Priority,Honest Operation,and Considerate Service",our business mainly focus on the distribution of electronic components. Line cards we deal with include Microchip,ALPS,ROHM,Xilinx,Pulse,ON,Everlight and Freescale. Main products comprise IC,Modules,Potentiometer,IC Socket,Relay,Connector.Our parts cover such applications as commercial,industrial, and automotives areas.

We are looking forward to setting up business relationship with you and hope to provide you with the best service and solution. Let us make a better world for our industry!



Contact us

Tel: +86-755-8981 8866 Fax: +86-755-8427 6832

Email & Skype: info@chipsmall.com Web: www.chipsmall.com

Address: A1208, Overseas Decoration Building, #122 Zhenhua RD., Futian, Shenzhen, China



THIS COPY IS PROVIDED ON A RESTRICTED BASIS AND IS NOT TO BE USED IN ANY WAY DETRIMENTAL TO THE INTERESTS OF PANDUIT CORP.

PART#	COLOR	DESCRIPTION	WEIGHT*
CJS5E88TGY	BLACK	8 POSITION, 8 WIRE SHIELDED MODULE WITH INTEGRAL SHIELD. WIRE CAP LABEL IS COLOR CODED FOR T568A AND T568B WIRING SCHEMES.	3.715 LB/100 PCS (1685g/100 PCS)
CJS5E88TGRDY	RED		
CJS5E88TGBUY	BLUE		
CJS5E88TGGRY	GREEN		
CJS5E88TGVLY	VIOLET		
CJS5E88TGWHY	WHITE		
CJS5E88TGYLY	YELLOW		

*WEIGHT IS APPROXIMATE

NOTES:

1. RED WIRE CAP DESIGNATES CATEGORY 5E PERFORMANCE.
2. MATERIAL:
MODULE HOUSING-ABS
SHIELD-TIN PLATED OVER PHOS. BRONZE
WIRE CAP/CLIP - ZINC AND PC
3. ALL TX5e,6 AND 6A 8 POSITION, 8 WIRE JACK MODULES ARE UNIVERSAL IN DESIGN. THEY ACCEPT SIX AND EIGHT POSITION MODULAR PLUGS WITHOUT DAMAGE.
4. DIMENSIONS IN PARENTHESES ARE IN METRIC.
5. .187 x .010" GROUNDING TAB PROVIDED AS OPTIONAL CONDUCTIVE PATH FOR GROUNDING.

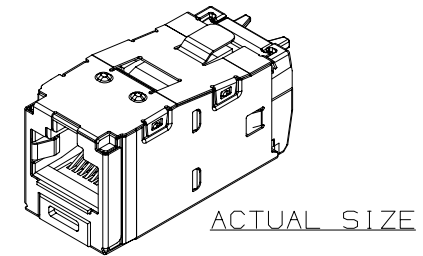
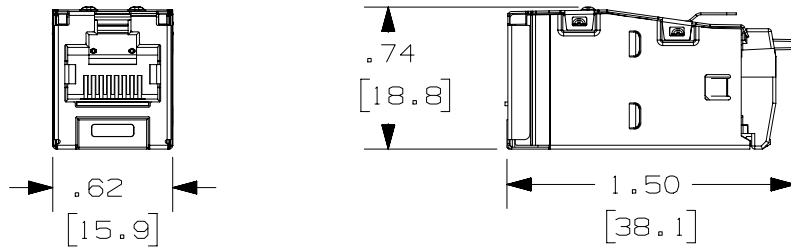
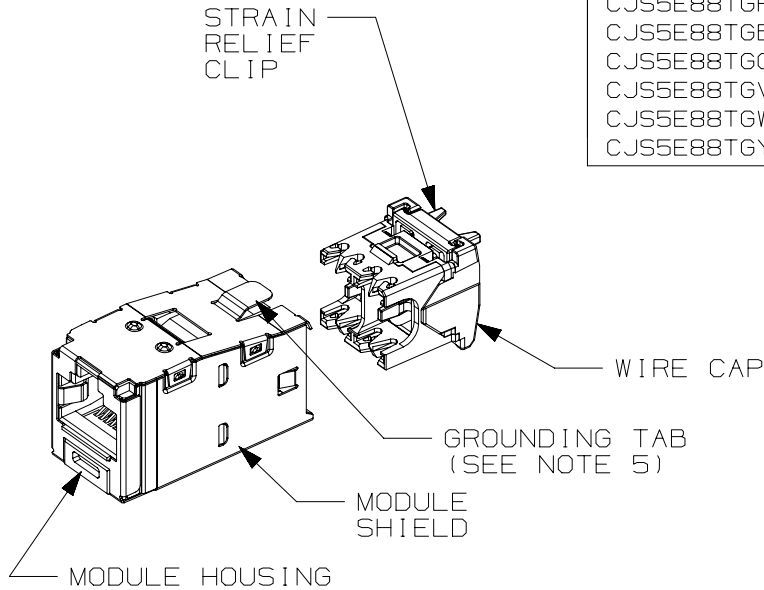

PART NUMBER		CJS5E88TG**Y	
TITLE		TX5E SHIELDED JACK MODULE	
		CUSTOMER DRAWING	
ITEM REVISION NAME		M02479NR/06	
DATASET FILE NAME		M02479NR_DC356/06C	
UNLESS OTHERWISE SPECIFIED, DIMENSIONAL TOLERANCES ARE: IN [mm]		MATERIAL: PANDUIT	
.x ± .xxx ± .010 [.3]		SEE NOTE 2	
.xx ± .03 [.8] ANGLES ±		DRAWING NUMBER: 02479-356	
THIRD ANGLE PROJECTION			
DRAWN BY	DATE	CHK	SCALE
AFW	3-11-06	CEF	FULL
SHT 1 OF 1		A	

REV	DATE	BY	CHK	APR	DESCRIPTION	ECN
8	4-26-18	BJN	BSN	TMBA	UPDATED WEIGHT ALIGNED METRIC DIMENSIONAL EQUIVALENTS	02479-356
7	4-12-18	BJN	MDJR	TMBA	ADDED WHITE TO COLOR OPTIONS	02479-356
6	2-15-17	ROJC	NAGL	TMBA	MODEL REVISION UPDATED REMOVED PREVIOUS REVISIONS FOR CLARITY	02479-356

D10100DA/14