



Chipsmall Limited consists of a professional team with an average of over 10 year of expertise in the distribution of electronic components. Based in Hongkong, we have already established firm and mutual-benefit business relationships with customers from,Europe,America and south Asia,supplying obsolete and hard-to-find components to meet their specific needs.

With the principle of "Quality Parts,Customers Priority,Honest Operation,and Considerate Service",our business mainly focus on the distribution of electronic components. Line cards we deal with include Microchip,ALPS,ROHM,Xilinx,Pulse,ON,Everlight and Freescale. Main products comprise IC,Modules,Potentiometer,IC Socket,Relay,Connector.Our parts cover such applications as commercial,industrial, and automotives areas.

We are looking forward to setting up business relationship with you and hope to provide you with the best service and solution. Let us make a better world for our industry!



Contact us

Tel: +86-755-8981 8866 Fax: +86-755-8427 6832

Email & Skype: info@chipsmall.com Web: www.chipsmall.com

Address: A1208, Overseas Decoration Building, #122 Zhenhua RD., Futian, Shenzhen, China



SERIES

**CM7560R
CM7560**



PC Mount Common Mode Choke

DASH NUMBER*
L (μH) L1 or L2 @ 1 kHz ±25%
DC RESISTANCE MAXIMUM (OHMS)
CURRENT RATING MAXIMUM (AMPS)
LEAKAGE INDUCTANCE MAXIMUM (μH)

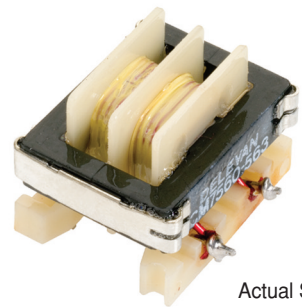

Actual Size

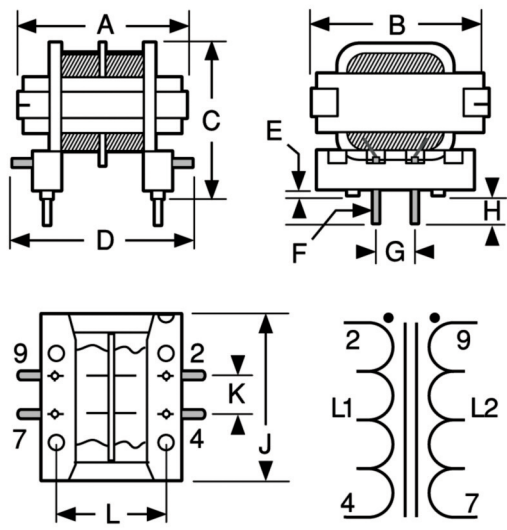

SERIES CM7560 FERRITE CORE				
-563	56	0.013	5.5	3.5
-683	68	0.013	5.5	3.5
-823	82	0.013	5.5	3.5
-104	100	0.013	5.5	3.5
-124	120	0.015	5.5	4.5
-154	150	0.015	5.5	6.0
-184	180	0.019	4.5	7.0
-224	220	0.020	4.5	7.5
-274	270	0.025	4.5	9.0
-334	330	0.025	3.5	12
-474	470	0.030	3.5	14
-564	560	0.035	3.5	18
-684	680	0.040	3.5	20
-824	820	0.060	2.8	24
-105	1000	0.065	2.8	30
-125	1200	0.095	2.2	35
-155	1500	0.115	1.7	40
-185	1800	0.125	1.7	45
-225	2200	0.170	1.4	55
-275	2700	0.180	1.4	75
-335	3300	0.320	1.1	90
-395	3900	0.400	1.1	100
-475	4700	0.450	0.88	130
-565	5600	0.500	0.88	175
-685	6800	0.600	0.88	220
-825	8200	0.750	0.88	230
-106	10000	0.800	0.70	250
-126	12000	0.900	0.70	300
-156	15000	1.00	0.70	350
-186	18000	1.30	0.55	425
-226	22000	1.50	0.55	475
-276	27000	1.80	0.44	550
-336	33000	2.20	0.44	650
-396	39000	2.60	0.44	800
-476	47000	3.00	0.44	900
-566	56000	4.00	0.35	1100
-686	68000	5.00	0.27	1300
-826	82000	5.50	0.27	1800
-107	100000	6.40	0.27	2100
-127	120000	7.80	0.22	2600
-157	150000	9.00	0.22	3000

Physical Parameters

	Inches	Millimeters
A	0.860 ± 0.025	21.8 ± 0.64
B	1.070 ± 0.050	27.2 ± 1.27
C	0.830 ± 0.030	21.1 ± 0.76
D	1.060 (Ref. only)	26.9 (Ref. only)
E	0.040 ± 0.025	1.0 ± 0.64
F	0.025 Sq. (Typ.)	0.64 Sq. (Typ.)
G	0.400 ± 0.010	10.2 ± 0.3
H	0.175 ± 0.015	4.4 ± 0.38
J	1.03 (Ref. only)	26.2 (Ref. only)
K	0.400 ± 0.010	10.2 ± 0.3
L	0.630 ± 0.010	16.0 ± 0.3

Operating Temperature Range -55°C to +125°C

Current Rating at 85°C Ambient 40°C Rise

Mechanical Configuration Tape wrapped winding sections; varnish impregnated assembly

- Notes** 1) Inductance in table is for either L1 or L2.
2) Leakage Inductance tested at L1 with L2 shorted or at L2 with L1 shorted. 3) Windings balanced within 1%.

*Complete part # must include series # PLUS the dash #
For surface finish information, refer to www.delevanfinishes.com

Marking DELEVAN; part number.

Example: CM7560-563
DELEVAN
CM7560-563

Packaging Bulk only