



Chipsmall Limited consists of a professional team with an average of over 10 year of expertise in the distribution of electronic components. Based in Hongkong, we have already established firm and mutual-benefit business relationships with customers from,Europe,America and south Asia,supplying obsolete and hard-to-find components to meet their specific needs.

With the principle of “Quality Parts,Customers Priority,Honest Operation,and Considerate Service”,our business mainly focus on the distribution of electronic components. Line cards we deal with include Microchip,ALPS,ROHM,Xilinx,Pulse,ON,Everlight and Freescale. Main products comprise IC,Modules,Potentiometer,IC Socket,Relay,Connector.Our parts cover such applications as commercial,industrial, and automotives areas.

We are looking forward to setting up business relationship with you and hope to provide you with the best service and solution. Let us make a better world for our industry!



## Contact us

Tel: +86-755-8981 8866 Fax: +86-755-8427 6832

Email & Skype: info@chipsmall.com Web: www.chipsmall.com

Address: A1208, Overseas Decoration Building, #122 Zhenhua RD., Futian, Shenzhen, China



**SERIES**

**CM9900R  
CM9900**



**PC Mount Common Mode Chokes**

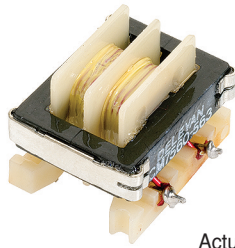

Actual Size

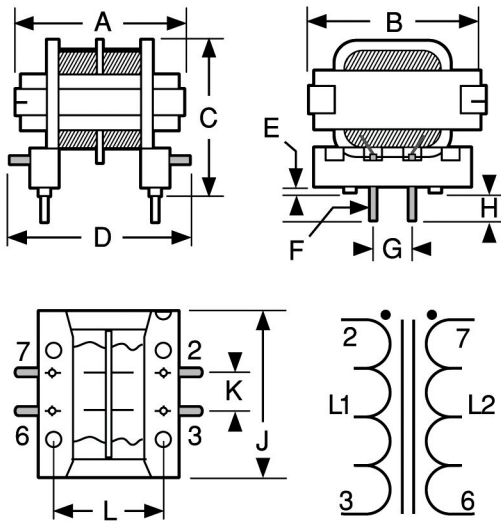

**Physical Parameters**

	Inches	Millimeters
A	0.740	18.8
B	0.840	21.3
C	0.670	17.0
D	0.900	22.9
E	0.040	1.0
F	0.025	0.64
G	0.200	5.1
H	0.175	4.4
J	0.750	19.1
K	0.200	5.1
L	0.515	13.1

All dimensions are typical

**Operating Temperature Range** -55°C to +125°C

**Current Rating at 80°C Ambient** 40°C rise

**Mechanical Configuration** Tape wrapped winding sections; varnish impregnated assembly.

- Notes**
- 1) Inductance in table is for either L1 or L2.
  - 2) Leakage Inductance tested at L1 with L2 shorted or at L2 with L1 shorted.
  - 3) Windings balanced within 1%.

DASH NUMBER\*  
L (μH) L1 or L2 @ 1 kHz ±25%  
DC RESISTANCE MAXIMUM (OHMS)  
CURRENT RATING MAXIMUM (AMPS)  
LEAKAGE INDUCTANCE TYPICAL (μH)

Transformers

SERIES CM9900 FERRITE CORE				
-473	47	0.016	3.5	4.0
-563	56	0.018	3.5	4.0
-683	68	0.019	3.5	5.0
-823	82	0.023	2.8	5.5
-104	100	0.025	2.8	6.0
-124	120	0.028	2.8	6.5
-154	150	0.030	2.8	7.5
-184	180	0.038	2.2	8.0
-224	220	0.044	2.2	9.0
-274	270	0.051	2.2	10
-334	330	0.058	1.7	11
-474	470	0.078	1.4	16
-564	560	0.091	1.4	18
-684	680	0.115	1.1	20
-824	820	0.131	1.1	25
-105	1000	0.194	0.88	35
-125	1200	0.219	0.88	47
-155	1500	0.278	0.70	49
-185	1800	0.306	0.70	59
-225	2200	0.431	0.55	76
-275	2700	0.469	0.55	91
-335	3300	0.531	0.55	101
-395	3900	0.669	0.44	135
-475	4700	0.760	0.44	158
-565	5600	0.853	0.44	196
-685	6800	1.24	0.35	257
-825	8200	1.40	0.35	296
-106	10000	1.61	0.35	362
-126	12000	1.98	0.27	410
-156	15000	2.24	0.27	503
-186	18000	2.45	0.27	602
-226	22000	3.49	0.22	730
-276	27000	4.60	0.17	870
-336	33000	5.21	0.17	1150
-396	39000	7.19	0.13	1300
-476	47000	7.80	0.13	1541
-566	56000	8.69	0.13	1875
-686	68000	9.69	0.13	2254
-826	82000	13.10	0.10	2702
-107	100000	14.60	0.10	3269
-127	120000	16.00	0.10	3456

\*Complete part # must include series # PLUS the dash #  
For surface finish information, refer to [www.delevanfinishes.com](http://www.delevanfinishes.com)

**Marking** DELEVAN; part number.

Example: CM9900R-473  
DELEVAN  
CM9900R-473

**Packaging** Bulk only