



Chipsmall Limited consists of a professional team with an average of over 10 year of expertise in the distribution of electronic components. Based in Hongkong, we have already established firm and mutual-benefit business relationships with customers from,Europe,America and south Asia,supplying obsolete and hard-to-find components to meet their specific needs.

With the principle of “Quality Parts,Customers Priority,Honest Operation,and Considerate Service”,our business mainly focus on the distribution of electronic components. Line cards we deal with include Microchip,ALPS,ROHM,Xilinx,Pulse,ON,Everlight and Freescale. Main products comprise IC,Modules,Potentiometer,IC Socket,Relay,Connector.Our parts cover such applications as commercial,industrial, and automotives areas.

We are looking forward to setting up business relationship with you and hope to provide you with the best service and solution. Let us make a better world for our industry!



## Contact us

Tel: +86-755-8981 8866 Fax: +86-755-8427 6832

Email & Skype: info@chipsmall.com Web: www.chipsmall.com

Address: A1208, Overseas Decoration Building, #122 Zhenhua RD., Futian, Shenzhen, China





# CNX714 Series 0.551" (14mm) Ruggedized LED Panel Mount Indicator



Ruggedized CNX714 Series with built-in LED offers fast, easy installation in harsh environments.



## Applications

- Industrial Machinery
- Transportation Dashboards
- Instrument Panels
- Control Cabinets
- Safety Applications
- Disinfection and Sterilization
- Switching Stations
- Slot, Gaming and Vending Machines
- Outdoor Signs
- Military Aircraft

## Key Features

- For panel hole diameter: 0.551" (14mm)
- Designed for extreme harsh and outdoor environments.
- Variety of connection options for fast, easy installation.
- Built-in LED can be used with FlexVolt™ (5 to 28 VDC) or 120VAC circuits
- Fast pitch threads ease assembly, requiring only one turn.
- Nut assembly by finger-tightening or with 1 inch hex key.
- Outdoor visibility in direct sunlight.
- Available in six solid colors (red, green, white, blue, soft yellow and yellow).
- Wide Viewing Angle
- Resistant to shock and vibration.
- Moisture sealed, IP67, protected from total dust ingress and withstanding water immersion between 15 cm and 1 meter for 30 minutes.
- Lead wire options with custom wire length available.
- Other colors (single or bicolor) are available upon request.
- RoHS and REACH Compliant.

## Ordering Data

The CNX714 Series is available in a range of standard features and options. To specify your Panel Mount Indicator, select one option from each column.

LED Color		Voltage		Termination Style	
CNX714C				<b>W</b>	
CNX714C: Colored Body					
<b>200</b>	Red			<b>W</b> Wire Leads	
<b>400*</b>	Soft Yellow				
<b>401</b>	Yellow				
<b>500</b>	Green				
<b>600</b>	Blue	<b>FV</b>	5-28VDC		
<b>900</b>	White	<b>120</b>	120VAC		

Example:  
CNX714C600120W  
Blue  
120VAC  
Wire Leads



\* Not Available for the 120VAC Version

## Product Dimensions

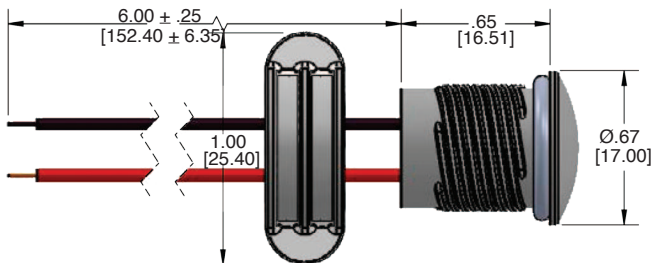

Recommended Mounting Hole

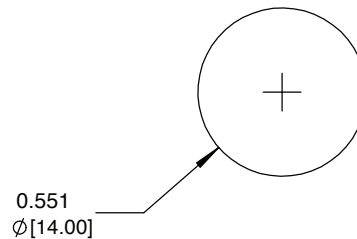

All Dimensions in inches [mm]

Tolerances are:  $\pm 0.01$  inches [ $\pm 0.25$  mm] unless otherwise specified

## Product Specifications

Flex Voltage Version:

LED output		
LED color	Luminous intensity typ. (mcd)	I (mA)
red	1300-2700	20
soft yellow	80-400	20
yellow	450-1120	20
green	1000-1400	20
blue	280-710	20
white	1300-1800	20

120VAC Version:

LED output		
LED color	Luminous intensity typ. (mcd)	I (mA)
red	550	8
yellow	245	8
green	924	8
blue	67	8
white	644	8

### Installation Specification

Mounting Hole	0.551" (14.0mm)
Panel Thickness	Up to .250" (6.3mm)
Spacing	minimum 1.5" center to center
Retainer Width	1" (25.4 mm)
Torque Specs	4-5 in/lbs

### Temperatures

Operating Temperature	-40°F (-40°C) to 176°F (80°C)
Storage Temperature	-40°F (-40°C) to 212°F (100°C)

### Materials

Body	polycarbonate, UL94-V2
Retaining Nut	PBT/Glass Filled, UL94-V0
Wire	24 AWG - Black/Red** 20 AWG - Black***
Lens	polycarbonate, UL94-V2
Moisture Seal	EPDM

\*\* Flex Voltage Version

\*\*\* 120 VAC Version

## Compliance and Approvals

