



Chipsmall Limited consists of a professional team with an average of over 10 year of expertise in the distribution of electronic components. Based in Hongkong, we have already established firm and mutual-benefit business relationships with customers from,Europe,America and south Asia,supplying obsolete and hard-to-find components to meet their specific needs.

With the principle of “Quality Parts,Customers Priority,Honest Operation,and Considerate Service”,our business mainly focus on the distribution of electronic components. Line cards we deal with include Microchip,ALPS,ROHM,Xilinx,Pulse,ON,Everlight and Freescale. Main products comprise IC,Modules,Potentiometer,IC Socket,Relay,Connector.Our parts cover such applications as commercial,industrial, and automotives areas.

We are looking forward to setting up business relationship with you and hope to provide you with the best service and solution. Let us make a better world for our industry!



## Contact us

Tel: +86-755-8981 8866 Fax: +86-755-8427 6832

Email & Skype: info@chipsmall.com Web: www.chipsmall.com

Address: A1208, Overseas Decoration Building, #122 Zhenhua RD., Futian, Shenzhen, China



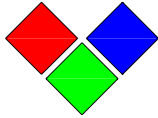

深圳市昱申科技有限公司  
CHINA YOUNG SUN LED TECHNOLOGY CO., LTD.

TEL: (86) 755-28079401 28079402 28079403 28079404 28079405  
FAX: (86) 755-28079407 E-mail: info@100LED.com Web: www.100LED.com

Model No.: YSM-2388CRGBC  
8mm Pitch RED/GREEN/BLUE Tripple Color  
Dot Matrix

Applications:

- Moving Message Display
- Full Color Display
- Banking Board
- Score Boards
- Digital Display



LED Chip Absolute Maximum Ratings: (Ta=25°C)

Pararmeter	Symbol	Red	Green	Blue	Unit
Forward curret	I <sub>F</sub>	20	20	20	mA
Peak forward current (Duty Cycle=1/10, 10KHz)	I <sub>PF</sub>	30	30	30	mA
Reverse voltage (V <sub>R</sub> =5V)	I <sub>R</sub>	10	10	10	μ A
Operating temp	T <sub>OPR</sub>	-25 - 85	-25 - 85	-25 - 85	°C
Storage temp	T <sub>STG</sub>	-30-85	-30-85	-30-85	°C
Spectral Line half-width	λ P <sub>H</sub>	20	30	30	nm

\* Soldering Bath: not more than 5 seconds @260°C. The bottom ends of the plastic reflector should be at least 2mm above the solder surface  
Soldering Iron: not more than 3 seconds @300°C under 30W

LED Chip Typical Electircal & Optical Characteristics: (Ta=25°C)

ITEMS	Color	Symbol	Condition	Min.	Typ.	Max.	Unit
Forward Voltage	Red	V <sub>F</sub>	I <sub>F</sub> =20mA	1.9	2.0	2.2	V
	Green			3.2	3.3	3.5	
	Blue			3.2	3.3	3.5	
Luminous Intensity	Red	I <sub>v</sub>	I <sub>F</sub> =20mA	120	150	160	mcd
	Green			250	300	330	
	Blue			180	200	250	
Wavelenength	Red	Δ λ	I <sub>F</sub> =20mA	620	---	625	nm
	Green			515	---	517.5	
	Blue			465	---	467.5	
Light Degradation after 1000 hours	Red	-4.68% ~ -8.27%					
	Green	-11.37% ~ -15.30%					
	Blue	-12.47% ~ -16.81%					

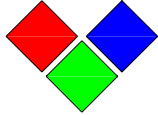

# 深圳市昱申科技有限公司

## CHINA YOUNG SUN LED TECHNOLOGY CO., LTD.

TEL: (86) 755-28079401 28079402 28079403 28079404 28079405  
 FAX: (86) 755-28079407 E-mail: info@100LED.com Web: www.100LED.com

### Mechanical Dimensions:

- All dimension are in mm, tolerance is  $\pm 0.2\text{mm}$  unless otherwise noted
- An epoxy meniscus may extend about 1.5mm down the leads.

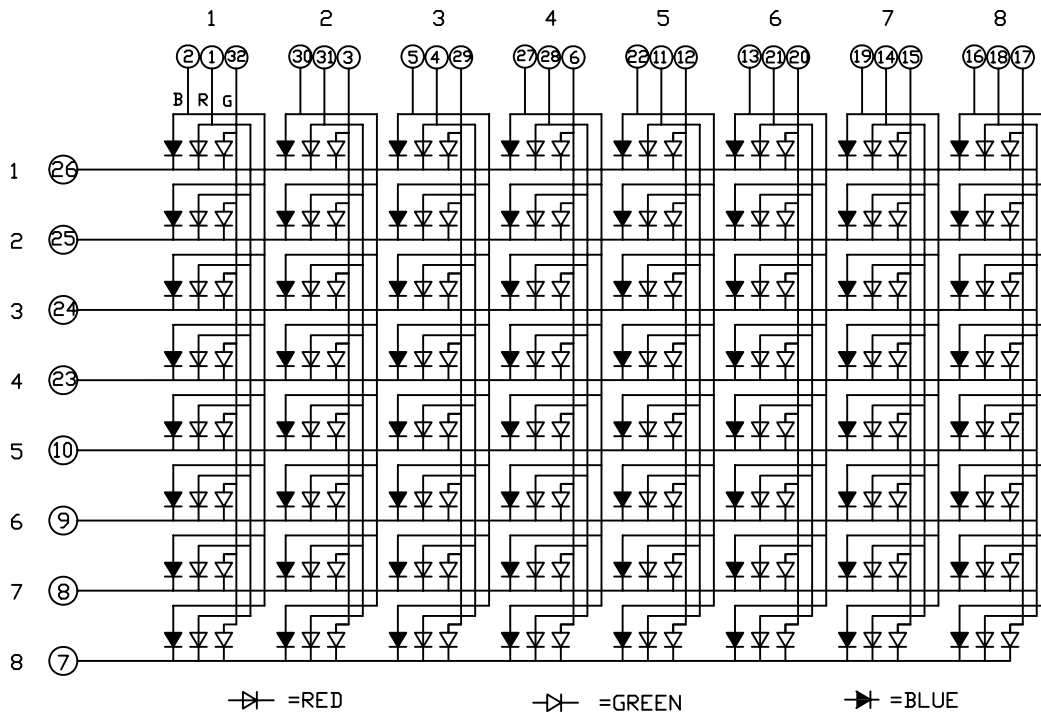
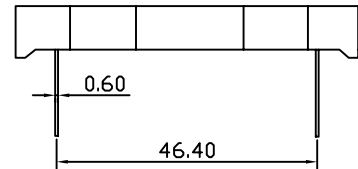
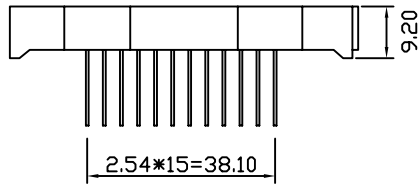
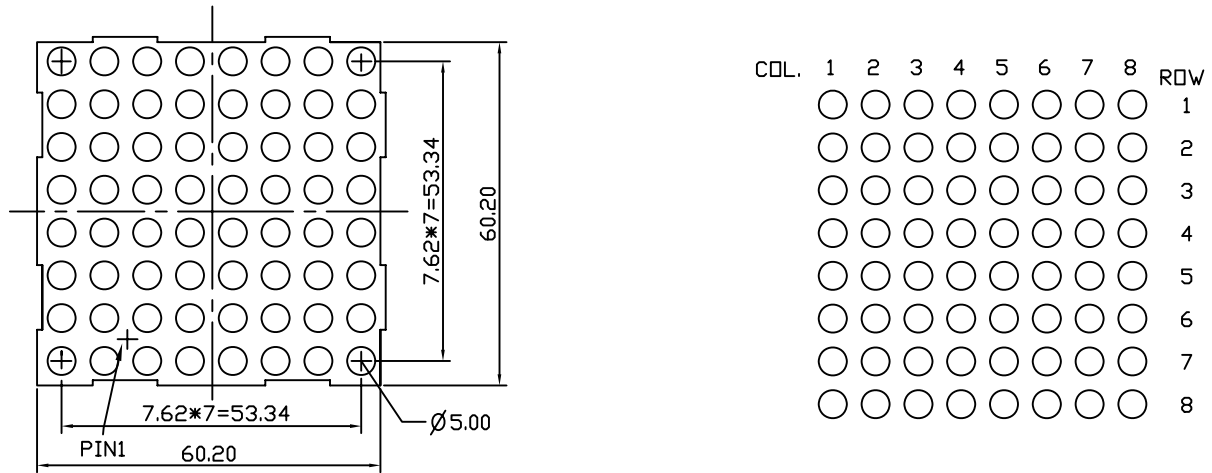

Unit: mm

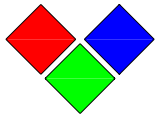

深圳市昱申科技有限公司

CHINA YOUNG SUN LED TECHNOLOGY CO., LTD.

TEL: (86) 755-28079401 28079402 28079403 28079404 28079405

FAX: (86) 755-28079407 E-mail: info@100LED.com Web: www.100LED.com

## Code System:

YSM-2388CXXC

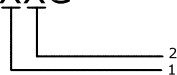

### 1. Color:

R: Red A: Amber K: Kelly Y: Yellow  
G: Green C: Cyan P: Purple W: White

### 2. Wavelength or Color Temperature Range:

R1: 610-615nm	G1: 512.5-515nm	B1: 455-457.5nm
R2: 615-620nm	G2: 517.5-520nm	B2: 457.5-460nm
R3: 620-625nm	G3: 520-522.5nm	B3: 460-462.5nm
	G4: 522.5-525nm	B4: 462.5-465nm
	G5: 525-527.5nm	B5: 465-467.5nm
	G6: 527.5-530nm	B6: 467.5-470nm
	G7: 530-532.5nm	B7: 470-472.5nm
	G8: 532.5-535nm	B8: 472.5-475nm

## Warranty:

- 3 years warranty for our red, yellow, amber and kelly items based on no more than 8 hours continuously lighting per day.
- 2 years warranty for our Blue, Green, Cyan and Purple items based on no more than 8 hours continuously lighting per day.
- 1 years warranty for our Cool White, Pure White and Warm White items based on no more than 8 hours continuously lighting per day.
- Electrical & Optical Characteristics consistency of same items all shipments.

## Notes:

- Please use Dot Matrixs based on our datasheet.
- Dot Matrix is sensitive to statics, be sure your equipments are anti-static when you use our Dot Matrixs.
- Pay more attention to your heat dissipation system when you use it, the better heat dissipation, the longer Dot Matrix lifespan.