



Chipsmall Limited consists of a professional team with an average of over 10 year of expertise in the distribution of electronic components. Based in Hongkong, we have already established firm and mutual-benefit business relationships with customers from,Europe,America and south Asia,supplying obsolete and hard-to-find components to meet their specific needs.

With the principle of “Quality Parts,Customers Priority,Honest Operation,and Considerate Service”,our business mainly focus on the distribution of electronic components. Line cards we deal with include Microchip,ALPS,ROHM,Xilinx,Pulse,ON,Everlight and Freescale. Main products comprise IC,Modules,Potentiometer,IC Socket,Relay,Connector.Our parts cover such applications as commercial,industrial, and automotives areas.

We are looking forward to setting up business relationship with you and hope to provide you with the best service and solution. Let us make a better world for our industry!



Contact us

Tel: +86-755-8981 8866 Fax: +86-755-8427 6832

Email & Skype: info@chipsmall.com Web: www.chipsmall.com

Address: A1208, Overseas Decoration Building, #122 Zhenhua RD., Futian, Shenzhen, China



THIS COPY IS PROVIDED ON A RESTRICTED BASIS AND IS NOT TO BE USED IN ANY WAY DETRIMENTAL TO THE INTERESTS OF PANDUIT CORP.

PANDUIT P/N	WEIGHT
CPI06**	.360 LB/10 PCS (163.8 g/10 PCS)

- NOTES:
- **1. SEE CURRENT CATALOG FOR ADDITIONAL PART NUMBER SUFFIXES TO INDICATE COLOR AND OR PACKAGE QUANTITY.
 - 2. ONE (1) #6-32 X 1/2" SLOTTED OVAL HEAD SCREW IS INCLUDED WITH THIS PART.
 - 3. DIMENSIONS IN PARENTHESES ARE IN METRIC.
 - 4. PART ACCEPTS "106" DUPLEX MODULE FRAME. CF1064.

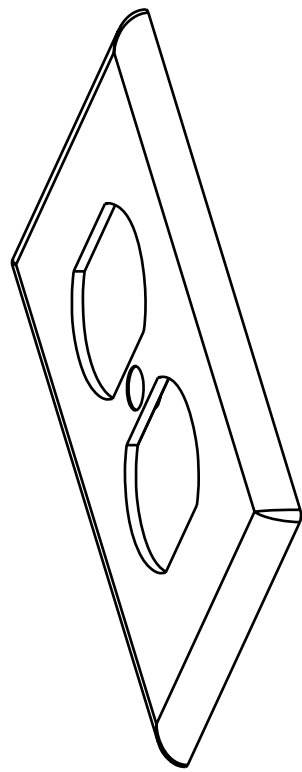
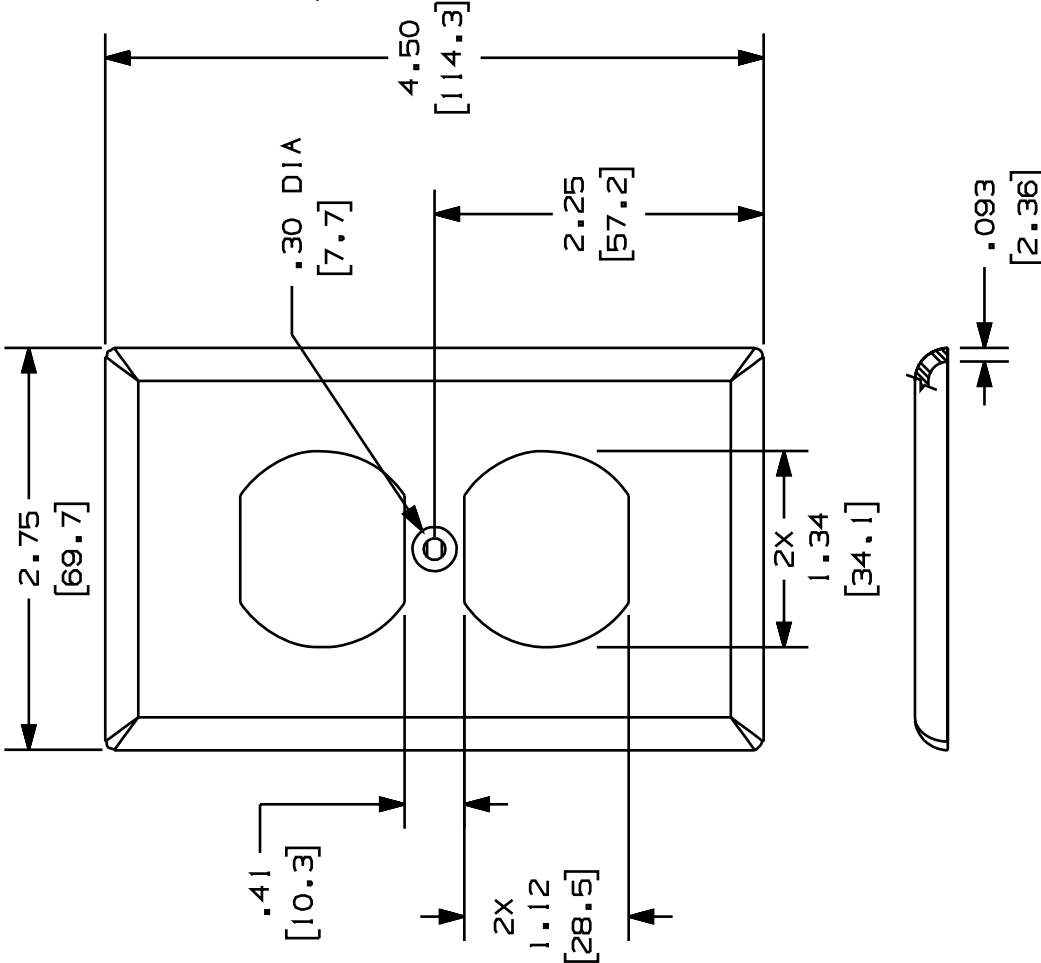

CAD FILE NAME/LAYERS (9736402) M00124BA_DC_OOB.PRT	
PANDUIT CORP. TINLEY PARK, ILLINOIS	
CLASSIC SERIES "106" FACEPLATE (CPI06**) CUSTOMER DRAWING	
UNLESS OTHERWISE SPECIFIED, DIMENSIONAL TOLERANCES ARE: (.X) ± .010(.3) (.XX) ± .031(.8) ANGLES ±	
UNLESS OTHERWISE SPECIFIED, ALL DIMENSIONS ARE GIVEN IN INCHES, THIRD ANGLE PROJECTION.	
DRAWN BY RCA	MAT'L: NONE
DATE 08-29-97	DRAWING NO. 00124-02
CHECKED BY CEF	SIZE A
ABS	
1 6/28/99 DW	A. REVISED TITLE NAME. 00124-02
R 08-29-97 RCA CEF	RELEASED TO PRODUCTION. 00124-02 CEF
REV DATE BY CHK	DESCRIPTION
	ECN
	CHK
	CUST
	SUP