



Chipsmall Limited consists of a professional team with an average of over 10 year of expertise in the distribution of electronic components. Based in Hongkong, we have already established firm and mutual-benefit business relationships with customers from,Europe,America and south Asia,supplying obsolete and hard-to-find components to meet their specific needs.

With the principle of “Quality Parts,Customers Priority,Honest Operation,and Considerate Service”,our business mainly focus on the distribution of electronic components. Line cards we deal with include Microchip,ALPS,ROHM,Xilinx,Pulse,ON,Everlight and Freescale. Main products comprise IC,Modules,Potentiometer,IC Socket,Relay,Connector.Our parts cover such applications as commercial,industrial, and automotives areas.

We are looking forward to setting up business relationship with you and hope to provide you with the best service and solution. Let us make a better world for our industry!



Contact us

Tel: +86-755-8981 8866 Fax: +86-755-8427 6832

Email & Skype: info@chipsmall.com Web: www.chipsmall.com

Address: A1208, Overseas Decoration Building, #122 Zhenhua RD., Futian, Shenzhen, China



2

1

THIS COPY IS PROVIDED ON A RESTRICTED BASIS AND IS NOT TO BE USED IN ANY WAY DETRIMENTAL TO THE INTERESTS OF PANDUIT CORP.

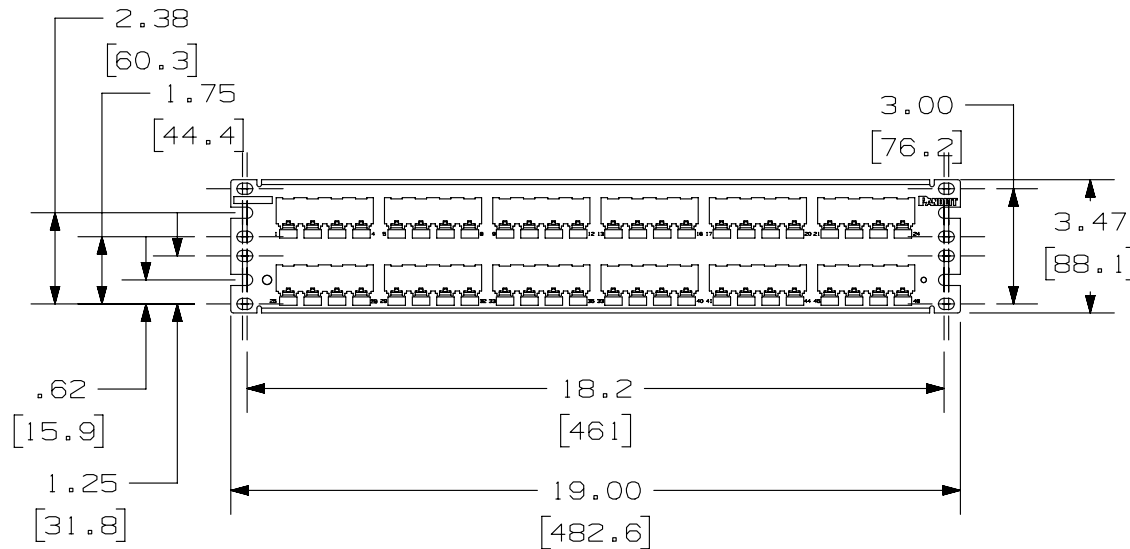
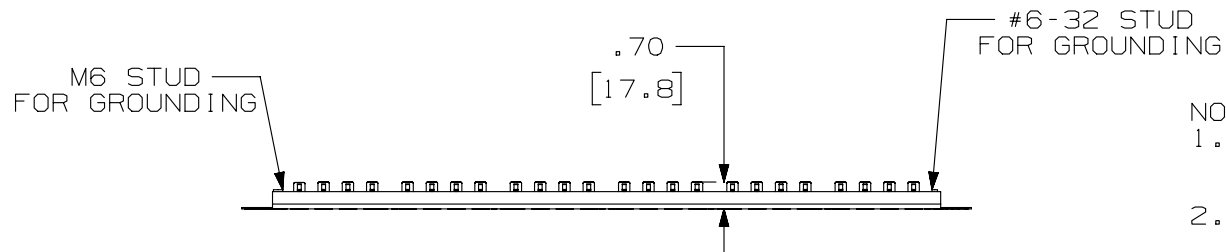

PANDUIT P/N

WEIGHT

CP48**Y

6.51 LB/10 PCS
(2952.9 g/10 PCS)

NOTES:

1. SEE CURRENT CATALOG FOR ADDITIONAL PART NUMBER SUFFIXES TO INDICATE COLOR AND OR PACKAGE QUANTITY.
 2. SEE CATALOG FOR COMPLETE LIST OF PARTS APPLICABLE FOR USE WITH THIS PART.
 3. DIMENSIONS IN [] ARE IN METRIC.
 4. PACKAGE CONTENTS:
 - 1- 48 PORT STAMPING
 - 1- SCREW KIT (INCLUDES FOUR #12-24 SCREWS AND FOUR LOCK WASHERS)
 - 1- SCREW KIT (INCLUDES FOUR M6 SCREWS)
 - 1- REMOVAL TOOL (CPT)
4. PATCH PANELS ACCEPT SNAP-IN MINI-COM SHIELDED MODULES.

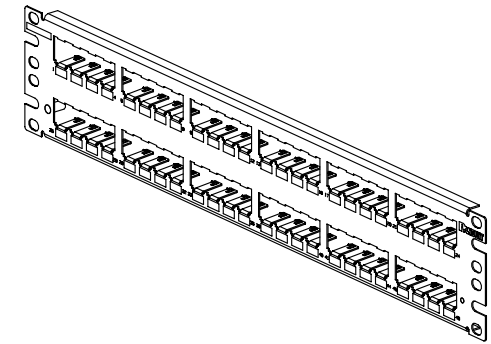

PART NUMBER

CP48**Y

TITLE

MINI-COM 48 PORT ALL METAL
MODULAR PATCH PANEL

CUSTOMER DRAWING

ITEM REVISION NAME

M02479CI/00

DATASET FILE NAME

M02479CI_DC62/00C

UNLESS OTHERWISE SPECIFIED,
DIMENSIONAL TOLERANCES ARE: IN [mm]

.X ±
.XX ± .03 [.8]

.XXX ± .010 [.3]
ANGLES ±

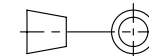
THIRD ANGLE
PROJECTION

MATERIAL:

20 GAGE
STAINLESS STEEL

DRAWING NUMBER:

02479-062

DRAWN BY

DATE

CHK

SCALE

JSP

5-2-06

MJD

NONE

SHT 1 OF 1

SIZE

A

REV	DATE	BY	CHK	APR	DESCRIPTION	ECN
2	3-14-14	SCAL			B. REVISED DRAWING TITLE BLOCK, C. ADDED "SHIELDED" TO NOTE 4.	02479-062
1	6-16-06	JSP	MJD	MJD	A. ADDED GROUNDING STUD CALLOUTS.	02479-062
R	5-2-06	JSP	MJD	MJD	RELEASED TO PRODUCTION	02479-062

2

1

D10100DA/14