



Chipsmall Limited consists of a professional team with an average of over 10 year of expertise in the distribution of electronic components. Based in Hongkong, we have already established firm and mutual-benefit business relationships with customers from,Europe,America and south Asia,supplying obsolete and hard-to-find components to meet their specific needs.

With the principle of “Quality Parts,Customers Priority,Honest Operation,and Considerate Service”,our business mainly focus on the distribution of electronic components. Line cards we deal with include Microchip,ALPS,ROHM,Xilinx,Pulse,ON,Everlight and Freescale. Main products comprise IC,Modules,Potentiometer,IC Socket,Relay,Connector.Our parts cover such applications as commercial,industrial, and automotives areas.

We are looking forward to setting up business relationship with you and hope to provide you with the best service and solution. Let us make a better world for our industry!



Contact us

Tel: +86-755-8981 8866 Fax: +86-755-8427 6832

Email & Skype: info@chipsmall.com Web: www.chipsmall.com

Address: A1208, Overseas Decoration Building, #122 Zhenhua RD., Futian, Shenzhen, China



THIS COPY IS PROVIDED ON A RESTRICTED BASIS AND IS NOT TO BE USED IN ANY WAY DETRIMENTAL TO THE INTERESTS OF PANDUIT CORP.

PANDUIT P/N	WEIGHT
CPPA48HDWBLY CPPA48HDWWH	6.88 LB/10 PCS (3215.2.0 g/10 PCS)

NOTES:

- SEE CURRENT CATALOG FOR ADDITIONAL PART NUMBER SUFFIXES TO INDICATE COLOR AND OR PACKAGE QUANTITY.
- SEE CATALOG FOR COMPLETE LIST OF PARTS APPLICABLE FOR USE WITH THIS PART.
- PACKAGE CONTENTS:
 - (1) -48 PORT ANGLED STAMPING
 - (6) -8 POSITION FACEPLATE (ASSEMBLED TO PANEL)
 - (1) -SCREW KIT (INCLUDES FOUR #12-24 SCREWS)
 - (1) -SCREW KIT (INCLUDES FOUR M6 SCREWS)
- DIMENSIONS IN [] ARE IN METRIC.
- CPPA48HDWBLY FABRICATED COMPONENTS ARE BLACK.
CPPA48HDWWH FABRICATED COMPONENTS ARE WHITE.

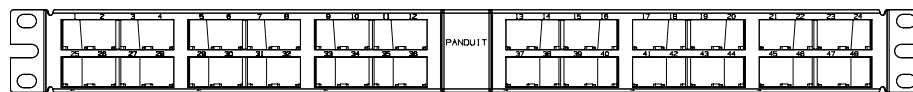
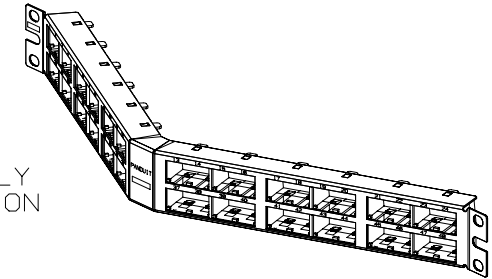
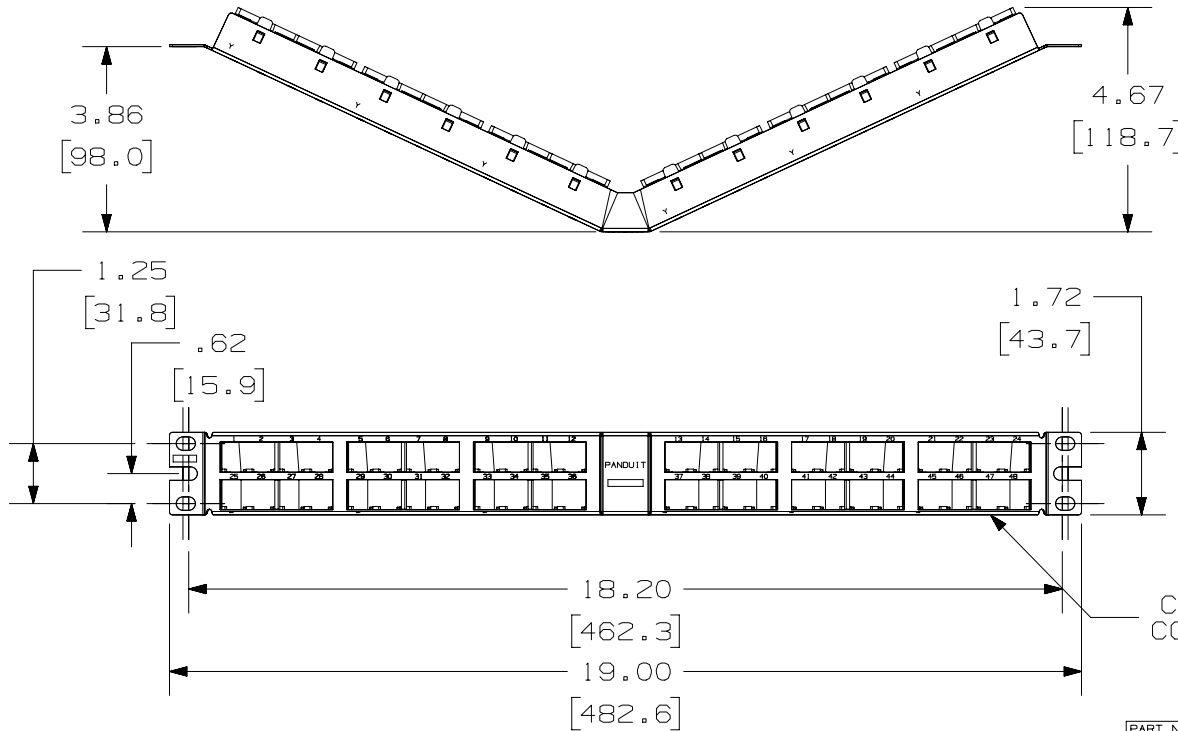

CPPA48HDWWH CONFIGURATION
NOTE: NO RECTANGULAR BOXES

PART NUMBER		CPPA48HDWBLY/CPPA48HDWWH	
TITLE		MINI-COM 48 PORT ANGLED HIGH DENSITY MODULAR PATCH PANEL	
		CUSTOMER DRAWING	
ITEM REVISION NAME		M02479DB/00	
DATASET FILE NAME		M02479DB_DC82/00C	
UNLESS OTHERWISE SPECIFIED, DIMENSIONAL TOLERANCES ARE: IN [mm]		MATERIAL:	
.x ± .03 [.8]		PANEL: 20 GAGE C.R.S	
.xxx ± .010 [.3]		FACEPLATE: ABS	
ANGLES ±		DRAWING NUMBER:	
THIRD ANGLE PROJECTION		02479-082	
DRAWN BY	DATE	CHK	SCALE
JSP	8-8-06	MJD	NONE
REV	DATE	BY	CHK
2	10/4/17	BAME	KRKE
1	5/7/14	JSP	REFR
R	8-8-06	JSP	MJD
DESCRIPTION		ECN	
ADDED P/N CPPA48HDWWH		02479-082	
A. REVISED DRAWING TITLE BLOCK		02479-082	
RELEASED TO PRODUCTION		02479-082	
SHT 1 OF 1		A	

D10100DA/14