



Chipsmall Limited consists of a professional team with an average of over 10 year of expertise in the distribution of electronic components. Based in Hongkong, we have already established firm and mutual-benefit business relationships with customers from,Europe,America and south Asia,supplying obsolete and hard-to-find components to meet their specific needs.

With the principle of “Quality Parts,Customers Priority,Honest Operation,and Considerate Service”,our business mainly focus on the distribution of electronic components. Line cards we deal with include Microchip,ALPS,ROHM,Xilinx,Pulse,ON,Everlight and Freescale. Main products comprise IC,Modules,Potentiometer,IC Socket,Relay,Connector.Our parts cover such applications as commercial,industrial, and automotives areas.

We are looking forward to setting up business relationship with you and hope to provide you with the best service and solution. Let us make a better world for our industry!



## Contact us

Tel: +86-755-8981 8866 Fax: +86-755-8427 6832

Email & Skype: info@chipsmall.com Web: www.chipsmall.com

Address: A1208, Overseas Decoration Building, #122 Zhenhua RD., Futian, Shenzhen, China



# Central<sup>TM</sup> Semiconductor Corp.

145 Adams Ave., Hauppauge, NY 11788 USA  
Phone (631) 435-1110 FAX (631) 435-1824  
Manufacturer of World Class Discrete Semiconductors  
www.centralsemi.com

## CR3F-010 SERIES 3.0 AMP FAST RECOVERY RECTIFIER

JEDEC D0-201AD CASE

**DESCRIPTION:** The CENTRAL SEMICONDUCTOR CR3F Series types are Axial Lead Silicon Rectifiers designed for DC Power Supply and Inverter applications where fast recovery times are needed.

**MAXIMUM RATINGS:** ( $T_A=25^\circ\text{C}$  unless otherwise noted)

	SYMBOL	CR3F-010	CR3F-020	CR3F-040	CR3F-060	CR3F-080	CR3F-100	UNITS
Peak Repetitive Reverse Voltage	$V_{RRM}$	100	200	400	600	800	1000	V
DC Blocking Voltage	$V_R$	100	200	400	600	800	1000	V
RMS Reverse Voltage	$V_{R(RMS)}$	70	140	280	420	560	700	V
Average Forward Current ( $T_A=90^\circ\text{C}$ )	$I_O$				3.0			A
Peak Forward Surge Current (8.3ms)	$I_{FSM}$				150			A
Operating Temperature Range	$T_J$				-55 to +125			$^\circ\text{C}$
Storage Temperature Range	$T_{stg}$				-55 to +150			$^\circ\text{C}$
Thermal Resistance	$\Theta_{JA}$				15			$^\circ\text{C/W}$

**ELECTRICAL CHARACTERISTICS** ( $T_A=25^\circ\text{C}$  unless otherwise noted)

SYMBOL	TEST CONDITIONS	TYP	MAX	UNITS
$I_R$	$V_R$ =Rated $V_{RRM}$ , $T_C=25^\circ\text{C}$		5.0	$\mu\text{A}$
$I_R$	$V_R$ =Rated $V_{RRM}$ , $T_C=100^\circ\text{C}$		100	$\mu\text{A}$
$V_F$	$I_F=3.0\text{A}$		1.2	V
$t_{rr}$	$I_F=0.5\text{A}$ , $I_R=1.0\text{A}$ , $I_{RR}=0.25\text{A}$ (CR3F-010, -020, -040)		150	ns
$t_{rr}$	$I_F=0.5\text{A}$ , $I_R=1.0\text{A}$ , $I_{RR}=0.25\text{A}$ (CR3F-060)		250	ns
$t_{rr}$	$I_F=0.5\text{A}$ , $I_R=1.0\text{A}$ , $I_{RR}=0.25\text{A}$ (CR3F-080,-100)		500	ns
$C_J$	$V_R=4.0\text{V}$ , $f=1.0\text{MHz}$ (CR3F-010, -020, -040)	65		pF
$C_J$	$V_R=4.0\text{V}$ , $f=1.0\text{MHz}$ (CR3F-060, -080, -100)	40		pF

(SEE REVERSE SIDE)

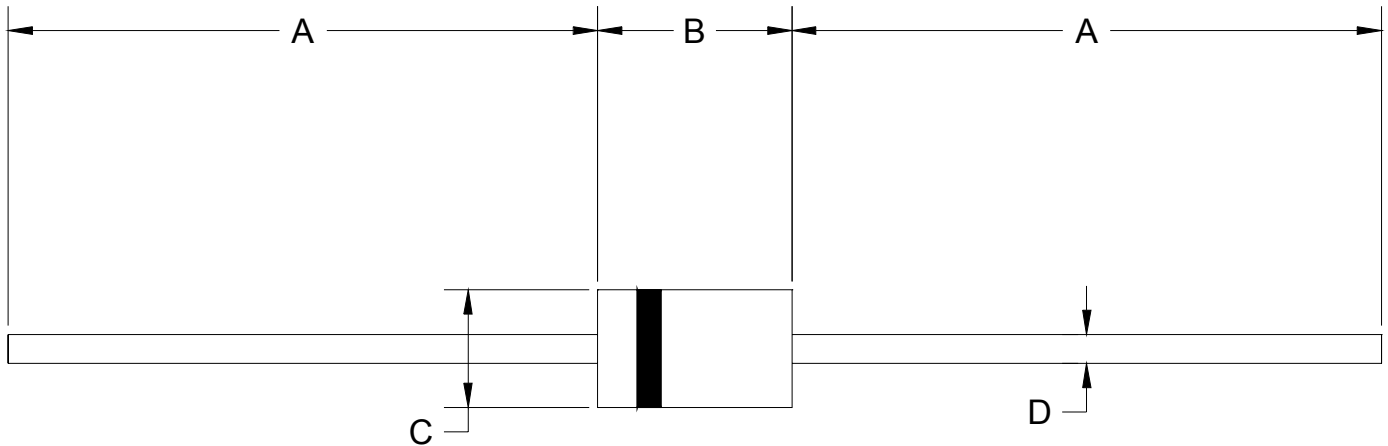
JEDEC DO-201AD CASE - MECHANICAL OUTLINE

DIMENSIONS				
SYMBOL	INCHES		MILLIMETERS	
	MIN	MAX	MIN	MAX
A	1.000	-	25.40	-
B	0.283	0.375	7.20	9.53
C	0.189	0.210	4.80	5.33
D	0.047	0.052	1.20	1.32

DO-201AD (REV: R1)

**Central**<sup>™</sup>  
Semiconductor Corp.

145 Adams Ave., Hauppauge, NY 11788 USA  
Phone (631) 435-1110 FAX (631) 435-1824

Manufacturers of World Class Discrete Semiconductors

[www.centralsemi.com](http://www.centralsemi.com)

## OUTSTANDING SUPPORT AND SUPERIOR SERVICES



---

### PRODUCT SUPPORT

Central's operations team provides the highest level of support to insure product is delivered on-time.

- Supply management (Customer portals)
- Inventory bonding
- Consolidated shipping options
- Custom bar coding for shipments
- Custom product packing

---

### DESIGNER SUPPORT/SERVICES

Central's applications engineering team is ready to discuss your design challenges. Just ask.

- Free quick ship samples (2<sup>nd</sup> day air)
- Online technical data and parametric search
- SPICE models
- Custom electrical curves
- Environmental regulation compliance
- Customer specific screening
- Up-screening capabilities
- Special wafer diffusions
- PbSn plating options
- Package details
- Application notes
- Application and design sample kits
- Custom product and package development

---

### CONTACT US

#### Corporate Headquarters & Customer Support Team

Central Semiconductor Corp.  
145 Adams Avenue  
Hauppauge, NY 11788 USA  
Main Tel: (631) 435-1110  
Main Fax: (631) 435-1824  
Support Team Fax: (631) 435-3388  
[www.centalsemi.com](http://www.centalsemi.com)

**Worldwide Field Representatives:**  
[www.centalsemi.com/wwreps](http://www.centalsemi.com/wwreps)

**Worldwide Distributors:**  
[www.centalsemi.com/wwdistributors](http://www.centalsemi.com/wwdistributors)

---

For the latest version of Central Semiconductor's **LIMITATIONS AND DAMAGES DISCLAIMER**, which is part of Central's Standard Terms and Conditions of sale, visit: [www.centalsemi.com/terms](http://www.centalsemi.com/terms)

# Product End of Life Notification

<b>PDN ID:</b>	PDN01058
<b>Notification Date:</b>	8/19/16
<b>Last Buy Date:</b>	2/19/17
<b>Last Shipment Date</b>	8/19/17

Summary: The CR3F-010 series of Fast Recovery Rectifiers is discontinued and now classified as End of Life (EOL).

Although Central Semiconductor Corp. makes every effort to continue to produce devices that have been proclaimed EOL (End of Life) by various manufacturers, it is an accepted industry practice to discontinue certain devices when customer demand falls below a minimum level of sustainability. Accordingly, the following product(s) have been transitioned to End of Life status as part of Central's Product Management Process. Any replacement product will be noted below. The effective date for placing the last purchase order will be six(6) months from the date of this notice and twelve(12) months from the notice date for final shipments; this may be extended if inventory is available.

<b>Central Part Number</b>	<b>Replacement</b>
CR3F-010 BK	CR5F-060 BK
CR3F-020 BK	CR5F-060 BK
CR3F-020 TR	CR5F-060 TR
CR3F-040 BK	CR5F-060 BK
CR3F-060 BK	CR5F-060 BK
CR3F-060 TR	CR5F-060 TR
CR3F-060GPP BK	CR5F-060 BK
CR3F-080 BK	CR5F-100 BK
CR3F-100 BK	CR5F-100 BK
CR3F-100 TR	CR5F-100 TR

Central would be happy to assist you by providing additional information or technical data to help locate an alternate source if we have no replacement available. Please email your requests to [engineering@centrasemi.com](mailto:engineering@centrasemi.com).

DISCLAIMER: This End of Life (EOL) notification is in accordance with JEDEC standard JESD48 - Product Discontinuance. Central Semiconductor Corp. will make every effort to offer life-time buy (LTB) opportunities and/or offer replacement devices to existing customers for discontinued devices, however, one or both may not be possible for all devices. Please contact your local Central Semiconductor sales representative for LTB opportunities/additional information.