



Chipsmall Limited consists of a professional team with an average of over 10 year of expertise in the distribution of electronic components. Based in Hongkong, we have already established firm and mutual-benefit business relationships with customers from,Europe,America and south Asia,supplying obsolete and hard-to-find components to meet their specific needs.

With the principle of “Quality Parts,Customers Priority,Honest Operation,and Considerate Service”,our business mainly focus on the distribution of electronic components. Line cards we deal with include Microchip,ALPS,ROHM,Xilinx,Pulse,ON,Everlight and Freescale. Main products comprise IC,Modules,Potentiometer,IC Socket,Relay,Connector.Our parts cover such applications as commercial,industrial, and automotives areas.

We are looking forward to setting up business relationship with you and hope to provide you with the best service and solution. Let us make a better world for our industry!



Contact us

Tel: +86-755-8981 8866 Fax: +86-755-8427 6832

Email & Skype: info@chipsmall.com Web: www.chipsmall.com

Address: A1208, Overseas Decoration Building, #122 Zhenhua RD., Futian, Shenzhen, China



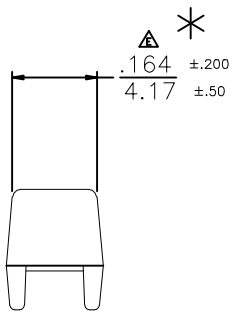

$\frac{.219}{5.56} \begin{matrix} \pm.020 \\ \pm.50 \end{matrix}$

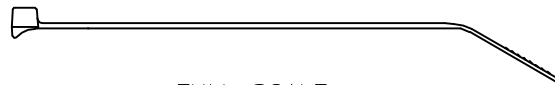
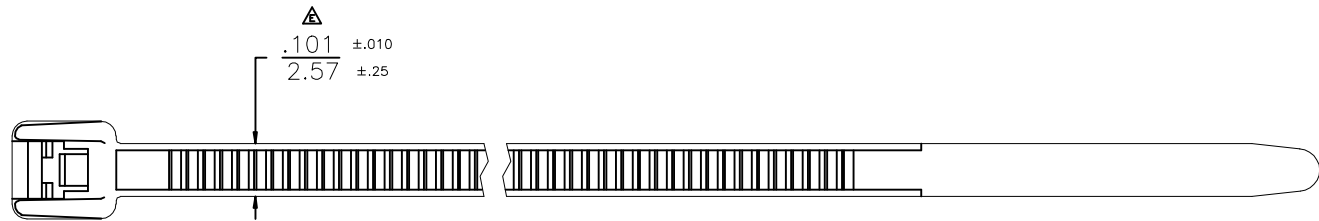
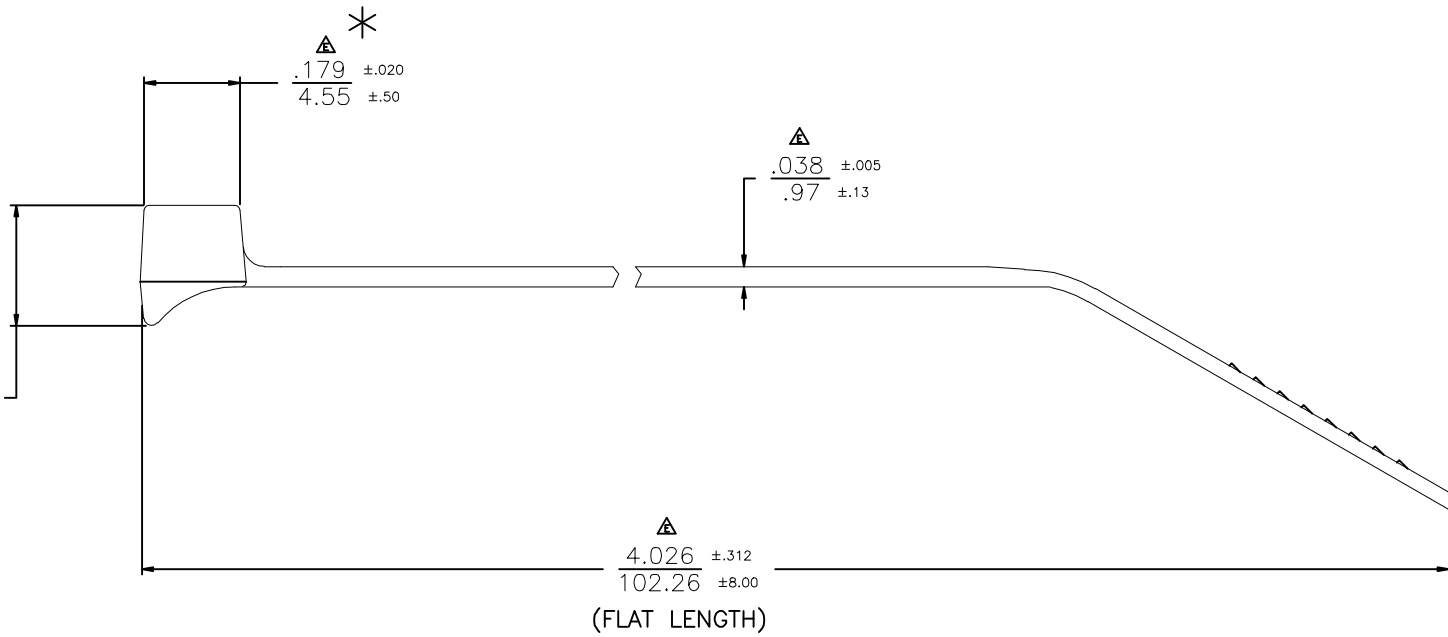

FULL SCALE

REDUCED
NO SCALE

.500	.063	20
12.70	1.59	
MAX	MIN	MIN LOOP TENSILE (LBS)
BUNDLE DIA		

HellermannTyton

ALL PROPRIETARY RIGHTS IN THE SUBJECT MATTER SHOWN ON THIS DRAWING ARE EXCLUSIVE PROPERTY OF HELLERMANN TYTON

NOTES

* DIMENSIONS INDICATED WITH AN ASTERISK ARE MEASURED AT THE TANGENCY OF THE TOP RADIUS AND THE SIDE WALL.

REVISION
DRAWING
level
date 11/12/99
by AAM
ECN # 001575
part level D

DIMENSIONS
TOLERANCES
.XXXX= NOTED
.XXX= NOTED
.XX= NOTED
.X= NOTED
unless otherwise specified
units inches/mm

number CTT20R
name
phase PRODUCTION
CLAMP TIE
material NYLON 6/6
OR
NYLON 6/6 HSO

DRAWING
FORMAT C number L CAD ACAD scale 6X
computer file number C:\CST\3007001E previous number C:\3007D001
drawn K.A.C. 11/10/89
type CUSTOMER sheet 1 of 1
number CT3007001CST