



Chipsmall Limited consists of a professional team with an average of over 10 year of expertise in the distribution of electronic components. Based in Hongkong, we have already established firm and mutual-benefit business relationships with customers from,Europe,America and south Asia,supplying obsolete and hard-to-find components to meet their specific needs.

With the principle of “Quality Parts,Customers Priority,Honest Operation,and Considerate Service”,our business mainly focus on the distribution of electronic components. Line cards we deal with include Microchip,ALPS,ROHM,Xilinx,Pulse,ON,Everlight and Freescale. Main products comprise IC,Modules,Potentiometer,IC Socket,Relay,Connector.Our parts cover such applications as commercial,industrial, and automotives areas.

We are looking forward to setting up business relationship with you and hope to provide you with the best service and solution. Let us make a better world for our industry!



## Contact us

Tel: +86-755-8981 8866 Fax: +86-755-8427 6832

Email & Skype: info@chipsmall.com Web: www.chipsmall.com

Address: A1208, Overseas Decoration Building, #122 Zhenhua RD., Futian, Shenzhen, China



## CX2045LNL

- Balun Transformer
- 1:2CT Impedance
- 3-300MHz
- Surface Mount

NOTES: UNLESS OTHERWISE SPECIFIED

1. OPERATING TEMPERATURE: -40°C TO +85°C
2. STORAGE TEMPERATURE: -50°C TO +125°C
3. JEDEC MOISTURE: LEVEL 1.
4. DIMENSIONS ARE IN INCHES WITH THE FOLLOWING TOLERANCE:  
.XX= ±.01  
.XXX= ±.005
5. OPTIONAL TAPE & REEL PACKAGING CAN BE ORDERED  
BY ADDING A "T" SUFFIX TO THE PART NUMBER(EX: CX2045LNL T)
6. ROHS COMPLIANT



## ELECTRICAL SPECIFICATIONS: @ 25°C

### RETURN LOSS:

FREQUENCY	RETURN LOSS (S11)
3 MHz	-23.5 dB MIN
5 MHz	-25 dB MIN
9 MHz	-27 dB MIN
30 MHz	-27 dB MIN
50 MHz	-24.5 dB MIN

FREQUENCY	RETURN LOSS (S11)
90 MHz	-20 dB MIN
150 MHz	-16.5 dB MIN
220 MHz	-13.5 dB MIN
250 MHz	-12 dB MIN
300 MHz	-10.5 dB MIN

### INSERTION LOSS:

FREQUENCY	ATTENUATION (S21)
3 MHz	-0.80 dB MAX
5 MHz	-0.80 dB MAX
9 MHz	-0.80 dB MAX
30 MHz	-0.80 dB MAX
50 MHz	-0.80 dB MAX

FREQUENCY	ATTENUATION (S21)
90 MHz	-0.80 dB MAX
150 MHz	-0.90 dB MAX
220 MHz	-1.00 dB MAX
250 MHz	-1.00 dB MAX
300 MHz	-1.00 dB MAX

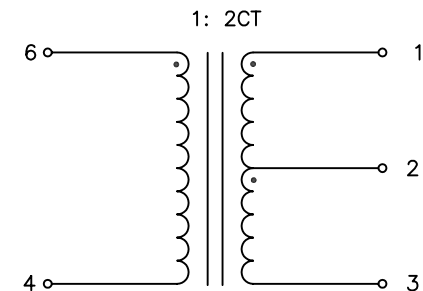

SCHEMATIC

© Copyright, 2014. Pulse Electronics Corp. All rights reserved. Drawing specifications subject to change without notice. (02/14/14)

PULSE CONFIDENTIAL  
&  
PROPRIETARY

PRODUCT SPECIFICATION:  
XFMR, RF, SGL, RAC, 1:2CT, 3-300MHz

DWG. NO./ PART NO.	SHEET:	REV.
CX2045LNL	1	M15

**MECHANICAL SPECIFICATIONS:**

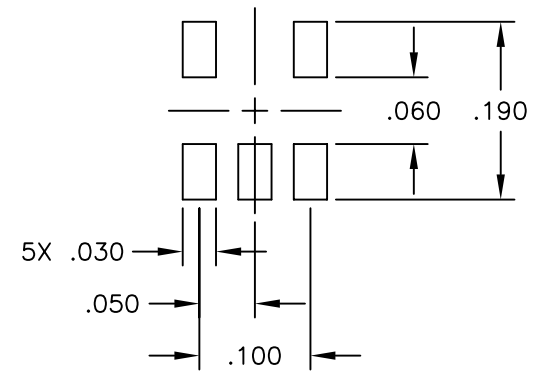
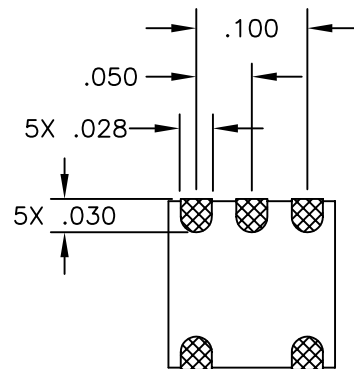
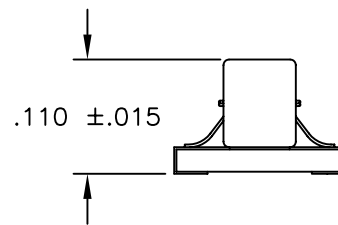
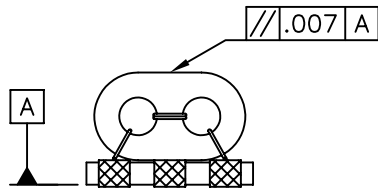
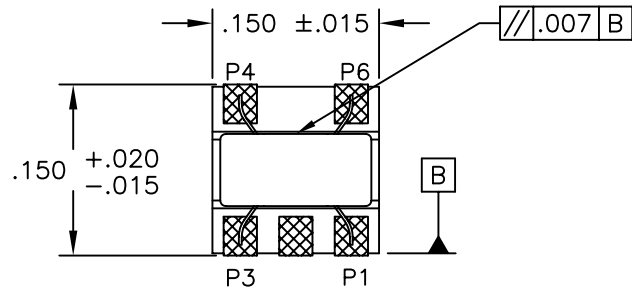

SUGGESTED LAND PATTERN

© Copyright, 2014. Pulse Electronics Corp. All rights reserved. Drawing specifications subject to change without notice. (02/14/14)

PULSE CONFIDENTIAL  
&  
PROPRIETARY

PRODUCT SPECIFICATION:  
XFMR, RF, SGL, RAC, 1:2CT, 3-300MHz

DWG. NO./ PART NO.	SHEET:	REV.
CX2045LNL	2	M15