



Chipsmall Limited consists of a professional team with an average of over 10 year of expertise in the distribution of electronic components. Based in Hongkong, we have already established firm and mutual-benefit business relationships with customers from,Europe,America and south Asia,supplying obsolete and hard-to-find components to meet their specific needs.

With the principle of “Quality Parts,Customers Priority,Honest Operation,and Considerate Service”,our business mainly focus on the distribution of electronic components. Line cards we deal with include Microchip,ALPS,ROHM,Xilinx,Pulse,ON,Everlight and Freescale. Main products comprise IC,Modules,Potentiometer,IC Socket,Relay,Connector.Our parts cover such applications as commercial,industrial, and automotives areas.

We are looking forward to setting up business relationship with you and hope to provide you with the best service and solution. Let us make a better world for our industry!



Contact us

Tel: +86-755-8981 8866 Fax: +86-755-8427 6832

Email & Skype: info@chipsmall.com Web: www.chipsmall.com

Address: A1208, Overseas Decoration Building, #122 Zhenhua RD., Futian, Shenzhen, China



CX2109NL

RF Transformer
1:1, 4.5 – 3000MHz
Impedance = 50 Ohms
Surface Mount, FR4 Substrate

ELECTRICAL SPECIFICATIONS @ 25°C:

NOTES: UNLESS OTHERWISE SPECIFIED:

1. OPERATING TEMPERATURE: -40°C TO +85°C.
2. STORAGE TEMPERATURE: -50°C TO +125°C
3. JEDEC MOISTURE: LEVEL 3.
4. DIMENSIONS ARE IN INCHES WITH THE FOLLOWING TOLERANCES:
.XX= ±.01
.XXX= ±.005
5. REVISION LEVEL MP1...MPX IS FOR PROTOTYPE RELEASED PRODUCTS.
6. ROHS COMPLIANT



PARAMETER	FREQUENCY (Hz)	CALCULATED ATTENUATION
INSERTION LOSS: AT +25°C	4.5 – 1000 M	1.0 dB MAX
	1000 – 2000 M	2.0 dB MAX
	2000 – 3000 M	3.5 dB MAX
PHASE UNBALANCE:	4.5-1000 MHz	20 DEG MAX
AMPLITUDE UNBALANCE:	4.5-1000 MHz	1.0 dB MAX

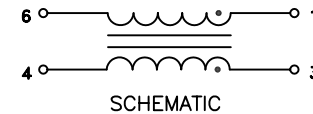

© Copyright, 2014. Pulse Electronics Corp. All rights reserved. Drawing specifications subject to change without notice. (03/11/14)

PULSE CONFIDENTIAL
&
PROPRIETARY

PRODUCT SPECIFICATION:
XFMR,RF,1:1,4.5-3000MHZ,RAC,SMT

PS DRAWING
PS-0078.001

DWG. NO./ PART NO.
CX2109NL

SHEET:
1

REV.
MP1

MECHANICAL SPECIFICATIONS:

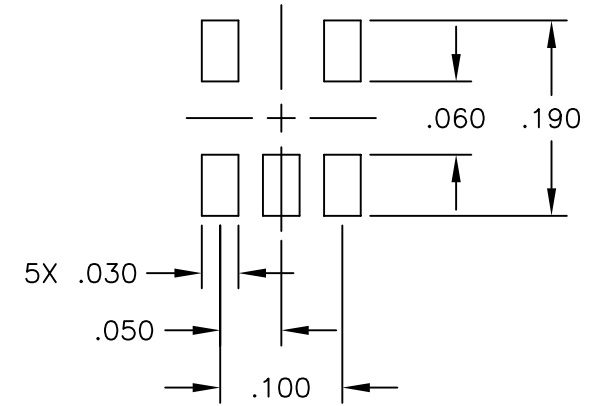
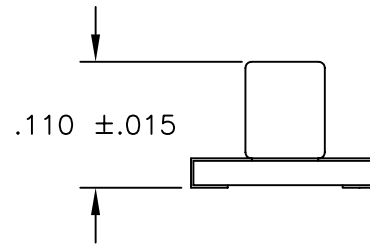
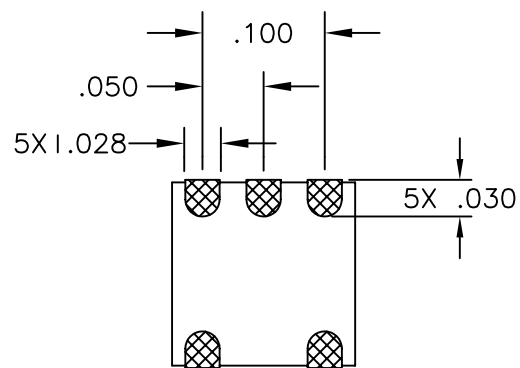
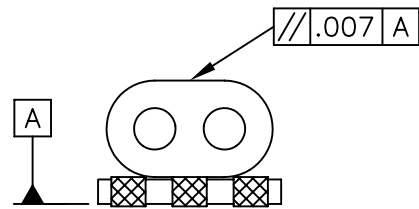
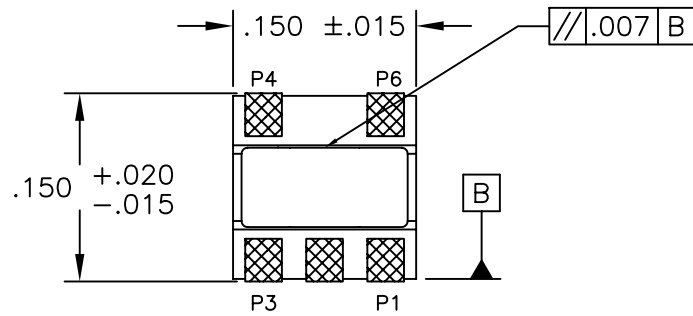

SUGGESTED LAND PATTERN

© Copyright, 2014. Pulse Electronics Corp. All rights reserved. Drawing specifications subject to change without notice. (03/11/14)

PULSE CONFIDENTIAL
&
PROPRIETARY

PRODUCT SPECIFICATION:
XFMR,RF,1:1,4.5-3000MHZ,RAC,SMT

PS DRAWING
PS-0078.001

DWG. NO./ PART NO.
CX2109NL

SHEET:
2

REV.
MP1