



Chipsmall Limited consists of a professional team with an average of over 10 year of expertise in the distribution of electronic components. Based in Hongkong, we have already established firm and mutual-benefit business relationships with customers from,Europe,America and south Asia,supplying obsolete and hard-to-find components to meet their specific needs.

With the principle of “Quality Parts,Customers Priority,Honest Operation,and Considerate Service”,our business mainly focus on the distribution of electronic components. Line cards we deal with include Microchip,ALPS,ROHM,Xilinx,Pulse,ON,Everlight and Freescale. Main products comprise IC,Modules,Potentiometer,IC Socket,Relay,Connector.Our parts cover such applications as commercial,industrial, and automotives areas.

We are looking forward to setting up business relationship with you and hope to provide you with the best service and solution. Let us make a better world for our industry!



Contact us

Tel: +86-755-8981 8866 Fax: +86-755-8427 6832

Email & Skype: info@chipsmall.com Web: www.chipsmall.com

Address: A1208, Overseas Decoration Building, #122 Zhenhua RD., Futian, Shenzhen, China



SPECIFICATION CONTROL DRAWING

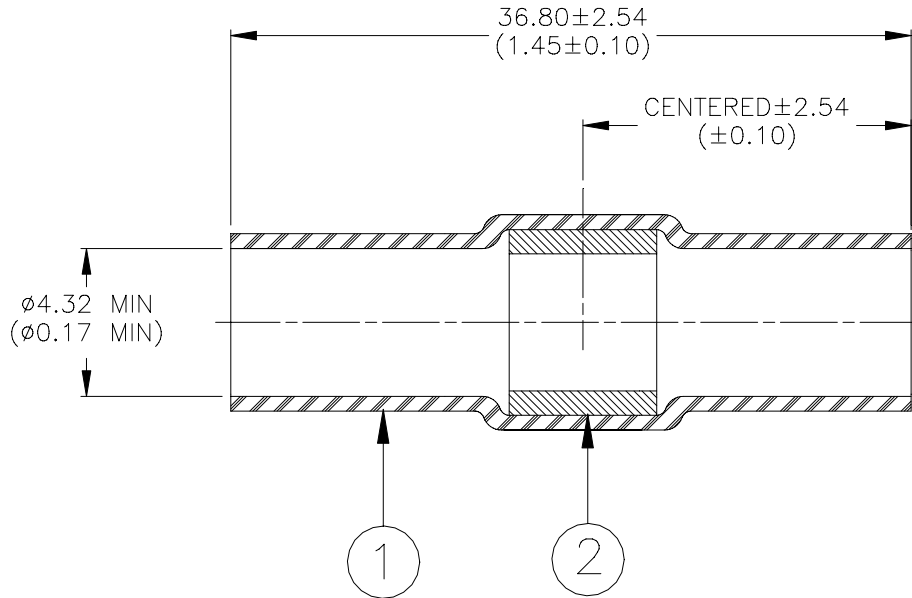

MATERIALS

1. INSULATION SLEEVE: Heat-shrinkable, transparent blue, radiation cross-linked modified polyvinylidene fluoride.
2. SOLDER PREFORM WITH FLUX:
 SOLDER: TYPE Sn63 per ANSI J-STD-006.
 FLUX: TYPE ROM1 per ANSI-J-STD-004.

APPLICATION

1. This part is designed to make a non-sealed in-line splice in conductors.
 Splice Criteria:
 Conductor Type: Bare or tin plated copper.
 Circular Mil Range: 4,800 to 9,000.
 Insulation Diameter: 2.41 - 4.32 (0.095 to 0.170).
2. Wires are to be stripped 16.5 - 19.1 (0.650 to 0.750) and overlapped under the solder preform.
3. Part may be installed with Raychem hot air or infrared heaters.
4. Part will meet requirements of Raychem Specification RT-1404.

tyco <i>Electronics</i>	Tyco Electronics Corporation 300 Constitutional Drive Menlo Park, CA 94025 USA	RAYCHEM	TITLE: SOLDERSLEEVE WIRE SPLICE, IN-LINE, NON SEALED				
UNLESS OTHERWISE SPECIFIED DIMENSIONS ARE IN MILLIMETERS. INCHES DIMENSIONS ARE BETWEEN BRACKETS.			DOCUMENT NO.: D-110-0101				
TOLERANCES: 0.00 N/A 0.0 N/A 0 N/A	ANGLES: N/A ROUGHNESS IN MICRON	Tyco reserves the right to amend this drawing at any time. Users should evaluate the suitability of the product for their application.		DATE: 06-July-00	DOC ISSUE: 1		
DRAWN BY: M. FORONDA	CAGE CODE: 06090	REPLACES: N/A	DCR NUMBER: D990721	PROD. REV. A	SCALE: None	SIZE: A	SHEET: 1 of 1

If this document is printed it becomes uncontrolled. Check for the latest revision.