



Chipsmall Limited consists of a professional team with an average of over 10 year of expertise in the distribution of electronic components. Based in Hongkong, we have already established firm and mutual-benefit business relationships with customers from,Europe,America and south Asia,supplying obsolete and hard-to-find components to meet their specific needs.

With the principle of "Quality Parts,Customers Priority,Honest Operation,and Considerate Service",our business mainly focus on the distribution of electronic components. Line cards we deal with include Microchip,ALPS,ROHM,Xilinx,Pulse,ON,Everlight and Freescale. Main products comprise IC,Modules,Potentiometer,IC Socket,Relay,Connector.Our parts cover such applications as commercial,industrial, and automotives areas.

We are looking forward to setting up business relationship with you and hope to provide you with the best service and solution. Let us make a better world for our industry!



Contact us

Tel: +86-755-8981 8866 Fax: +86-755-8427 6832

Email & Skype: info@chipsmall.com Web: www.chipsmall.com

Address: A1208, Overseas Decoration Building, #122 Zhenhua RD., Futian, Shenzhen, China



SPECIFICATION CONTROL DRAWING

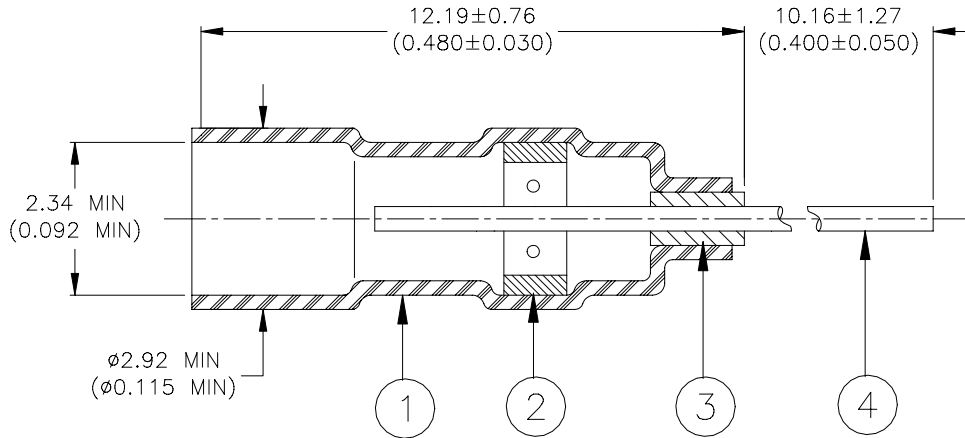

MATERIALS

1. INSULATION SLEEVE: Heat-shrinkable, transparent blue, radiation cross-linked modified polyvinylidene fluoride. Recovered I.D.: 1.27 (0.050) max.
2. SOLDER PREFORM WITH FLUX:
 SOLDER: TYPE Sn63 per ANSI J-STD-006.
 FLUX: TYPE ROL1 per ANSI J-STD-004.
3. SPACER SLEEVE: Radiation cross-linked modified polyvinylidene fluoride.
4. PRE-INSTALLED PIN: 21 AWG (0.74 (0.029) dia., Solder (Sn63) plated phosphor bronze.

APPLICATION

1. This sleeve is designed to splice wires to the per-installed pin. Part will accept 1 or 2 wires having a cross-sectional area (CMA) between 750 and 1250 (range may be extended to 2500 if conductors are pre-tinned).
2. Wires are to be stripped 6.35 – 7.92 (0.250 – 0.312), pre-tinned if necessary, and inserted to the shoulder in the sleeve. The part is then heated, using a Raychem approved infrared or convection heat source and reflector until the solder perform melts, flows and forms a fillet between the conductors and the pre-installed lead.

tyco / Electronics / Raychem		Wire and Harnessing Products	TITLE : SOLDERSLEEVE TERMINATOR WITH PIN				
307 Constitution Drive, Menlo Park, CA 94025, USA							
Unless otherwise specified dimensions are in millimeters. Inches dimensions are in between brackets.			DOCUMENT NO.: D-141-0171				
TOLERANCES: 0.00 N/A 0.0 N/A 0 N/A	ANGLES: N/A ROUGHNESS IN MICRON	Tyco Electronics reserves the right to amend this drawing at any time. Users should evaluate the suitability of the product for their application.	DCR NUMBER: D010435	REPLACES: N/A			
DRAWN BY: M. FORONDA	DATE: 13-July-01	PROD. REV. A	DOC ISSUE: 1	SCALE: None	SIZE: A	SHEET: 1 of 1	

If this document is printed it becomes uncontrolled. Check for the latest revision.