



Chipsmall Limited consists of a professional team with an average of over 10 year of expertise in the distribution of electronic components. Based in Hongkong, we have already established firm and mutual-benefit business relationships with customers from,Europe,America and south Asia,supplying obsolete and hard-to-find components to meet their specific needs.

With the principle of “Quality Parts,Customers Priority,Honest Operation,and Considerate Service”,our business mainly focus on the distribution of electronic components. Line cards we deal with include Microchip,ALPS,ROHM,Xilinx,Pulse,ON,Everlight and Freescale. Main products comprise IC,Modules,Potentiometer,IC Socket,Relay,Connector.Our parts cover such applications as commercial,industrial, and automotives areas.

We are looking forward to setting up business relationship with you and hope to provide you with the best service and solution. Let us make a better world for our industry!



Contact us

Tel: +86-755-8981 8866 Fax: +86-755-8427 6832

Email & Skype: info@chipsmall.com Web: www.chipsmall.com

Address: A1208, Overseas Decoration Building, #122 Zhenhua RD., Futian, Shenzhen, China



SPECIFICATION CONTROL DRAWING

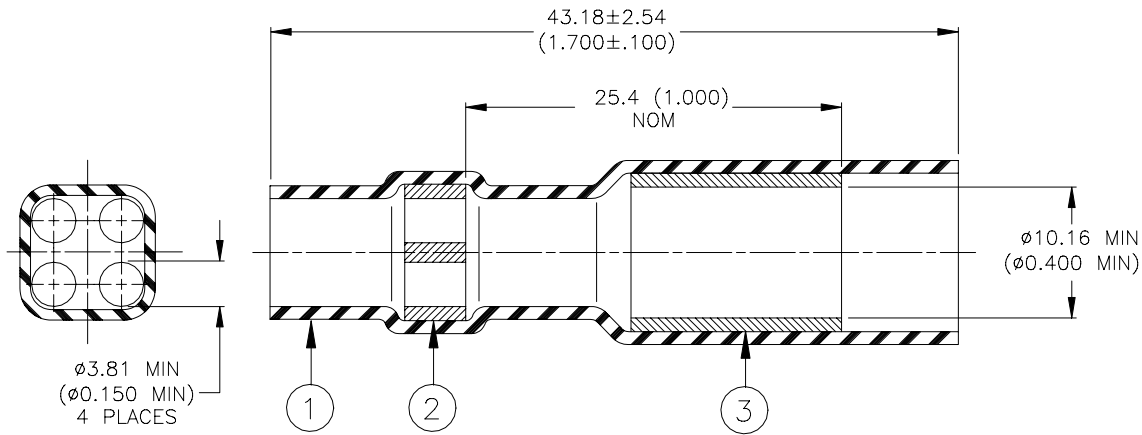

SEALING SLEEVE

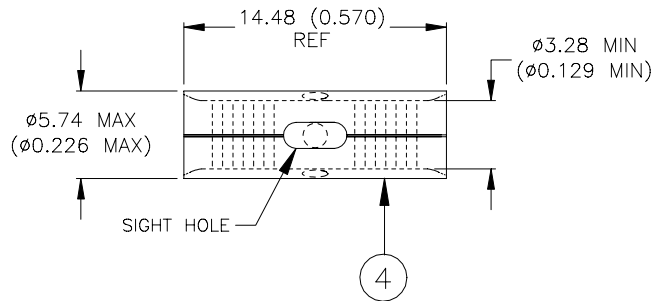

CRIMP SPLICER

MATERIALS

1. INSULATION SLEEVE: Heat-shrinkable, transparent blue, radiation cross-linked modified polyvinylidene fluoride.
2. SEALING INSERT: Fluorocarbon-based thermoplastic, color-natural.
3. 4-HOLE INSERT: Fluorocarbon-based thermoplastic, color-yellow.
4. CRIMP SPLICER: Base Metal: Copper Alloy 110 per ASTM B-152.
Plating: Tin plated per MIL-T-10727.
Wire Size Range: 2.62 – 6.64mm² (5180 – 13100 CMA, 12 –10 AWG) Solid or Stranded.

APPLICATION

1. This device is designed to provide immersion resistant in-line splice in wire bundles having up to 4 wires on one side and 1 wire on the other. Circular Mil Area (CMA) of wires on each end must be between 5180 and 13110.
2. Splicer to be installed with AMP 49900 (or equivalent tool). Sealing sleeve should be heated, starting with 4-hole insert, with a convection heater.
3. Strip length of wires shall be set so that when fully inserted into crimp barrel between 0.508 (0.020) and 1.52 (0.060) of conductor extends out of the barrel.

tyco / Electronics / Raychem 307 Constitution Drive Menlo Park, CA 94025, USA		Wire and Harnessing Products	TITLE: IN-LINE CRIMP SPLICE, 4 TO 1, 12-10 AWG, TIN PLATED				
Unless otherwise specified dimensions are in millimeters. Inches dimensions are in between brackets.			DOCUMENT NO.: D-436-0182				
TOLERANCES: 0.00 N/A 0.0 N/A 0 N/A	ANGLES: N/A ROUGHNESS IN MICRON	Tyco Electronics reserves the right to amend this drawing at any time. Users should evaluate the suitability of the product for their application.		DCR NUMBER: D010498	REPLACES: N/A		
DRAWN BY: M. FORONDA	DATE: 3-Oct-01	PROD. REV. A	DOC ISSUE: 0	SCALE: None	SIZE: A	SHEET: 1 of 1	

this document is printed it becomes uncontrolled. Check for the latest revision.