



Chipsmall Limited consists of a professional team with an average of over 10 year of expertise in the distribution of electronic components. Based in Hongkong, we have already established firm and mutual-benefit business relationships with customers from,Europe,America and south Asia,supplying obsolete and hard-to-find components to meet their specific needs.

With the principle of "Quality Parts,Customers Priority,Honest Operation,and Considerate Service",our business mainly focus on the distribution of electronic components. Line cards we deal with include Microchip,ALPS,ROHM,Xilinx,Pulse,ON,Everlight and Freescale. Main products comprise IC,Modules,Potentiometer,IC Socket,Relay,Connector.Our parts cover such applications as commercial,industrial, and automotives areas.

We are looking forward to setting up business relationship with you and hope to provide you with the best service and solution. Let us make a better world for our industry!



Contact us

Tel: +86-755-8981 8866 Fax: +86-755-8427 6832

Email & Skype: info@chipsmall.com Web: www.chipsmall.com

Address: A1208, Overseas Decoration Building, #122 Zhenhua RD., Futian, Shenzhen, China



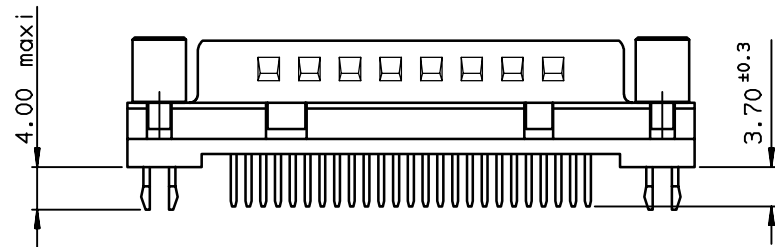
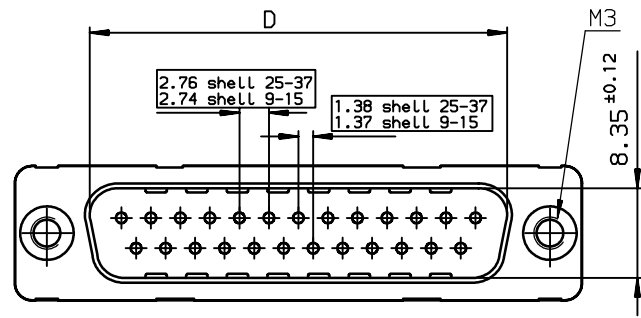
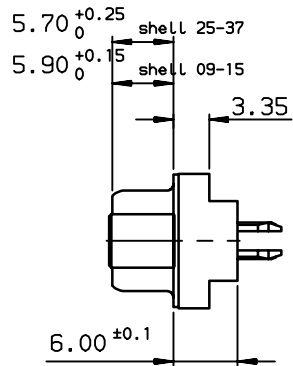
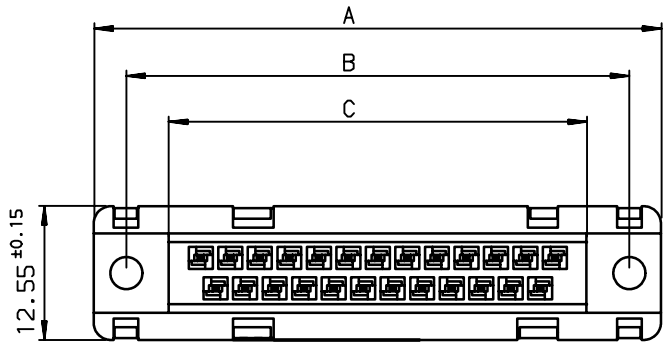

TIN LEAD PART NUMBER

SHELL	A±0.38	B±0.12	C±0.10	D±0.25	E±0.07	PART NUMBER
09	30.81	24.99	16.96	16.79	10.96	D09P24B.G100
15	39.14	33.32	25.18	25.12	19.18	D15P24B.G100
25	53.03	47.04	39.12	38.84	33.12	D25P24B.G100
37	69.32	63.50	55.68	55.30	49.68	D37P24B.G100

Protection: 4 --> flash AU
6 --> 0.76µ AU

LEAD FREE PART NUMBER

SHELL	A±0.38	B±0.12	C±0.10	D±0.25	E±0.07	PART NUMBER
09	30.81	24.99	16.96	16.79	10.96	D09P24B.G100LF
15	39.14	33.32	25.18	25.12	19.18	D15P24B.G100LF
25	53.03	47.04	39.12	38.84	33.12	D25P24B.G100LF
37	69.32	63.50	55.68	55.30	49.68	D37P24B.G100LF

Protection: 4 --> flash AU
6 --> 0.76µ AU

PC card drilling dimensions(after plating)
(thickness 2.40±0.20mm)

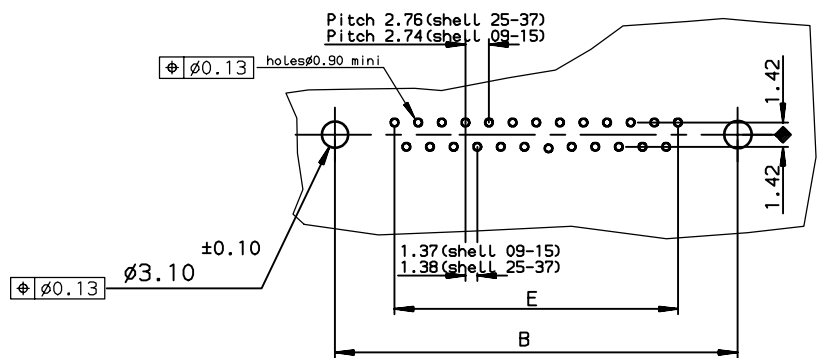

GENERAL CHARACTERISTICS AND ROHS INFORMATIONS:
SEE DRAWING C01-8646-0002

European Views

www.fciconnect.com		surface ISO 1302 ✓	tolerance std ISO 406 ISO 1101	projection mm	size A3	Scale 2
TOLERANCES UNLESS OTHERWISE SPECIFIED						
Dr	MASSON	2000/08/01	ANGULAR	0.X	±0.1	ECN L506-0097
Eng	PESSON	2000/08/01	LINEAR	0.XX	±0.1	
Chr	LEGARE	2000/08/01	0.XX' ±2'	0.XXX	±0.1	
Appr	LEGARE	2000/08/01	Product family		D-SUB	Spec ref -
FCI		MALE CONNECTOR DELTA D ST			Rev. D	
straight,solder type for		catalog no		dwg no C01-8646-0722		sheet 1 of 1

rev	ecn no	dr	date
A	-	MAS	2000/08/01
B	L505-001	MPE	2005/03/14
C	L505-0056	MPE	2005/06/30
D	L506-0097	LGO	2006/07/28
-	-	-	-
-	-	-	-
-	-	-	-



Copyright FCI.