



Chipsmall Limited consists of a professional team with an average of over 10 year of expertise in the distribution of electronic components. Based in Hongkong, we have already established firm and mutual-benefit business relationships with customers from,Europe,America and south Asia,supplying obsolete and hard-to-find components to meet their specific needs.

With the principle of “Quality Parts,Customers Priority,Honest Operation,and Considerate Service”,our business mainly focus on the distribution of electronic components. Line cards we deal with include Microchip,ALPS,ROHM,Xilinx,Pulse,ON,Everlight and Freescale. Main products comprise IC,Modules,Potentiometer,IC Socket,Relay,Connector.Our parts cover such applications as commercial,industrial, and automotives areas.

We are looking forward to setting up business relationship with you and hope to provide you with the best service and solution. Let us make a better world for our industry!



Contact us

Tel: +86-755-8981 8866 Fax: +86-755-8427 6832

Email & Skype: info@chipsmall.com Web: www.chipsmall.com

Address: A1208, Overseas Decoration Building, #122 Zhenhua RD., Futian, Shenzhen, China



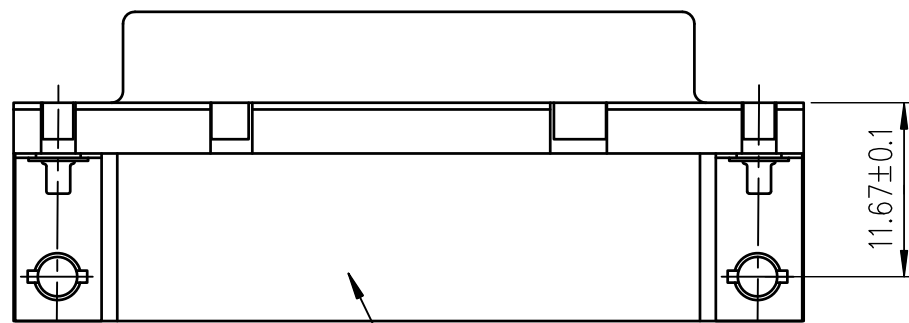
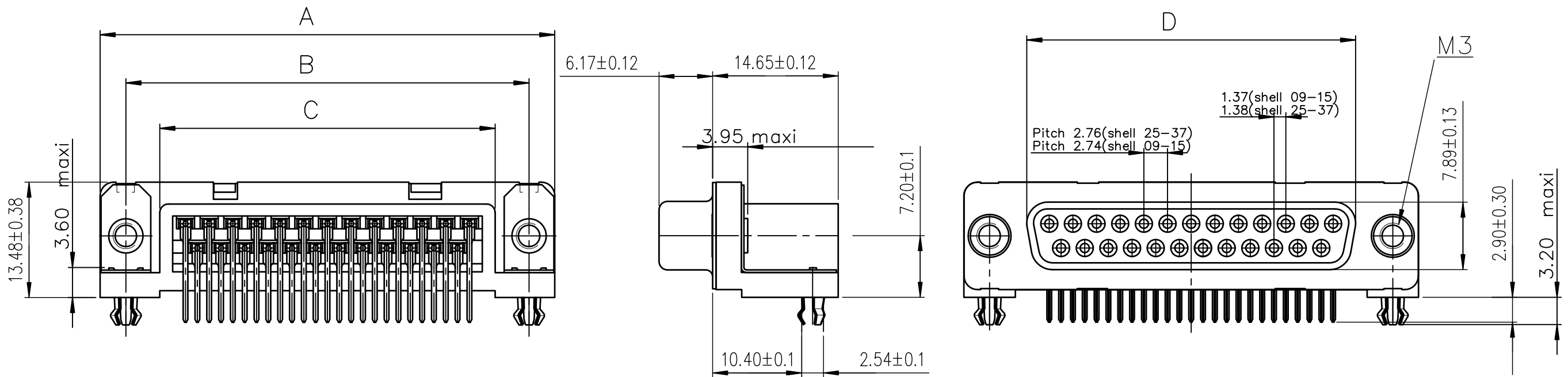

Part Number & Date Code Printing
 PC card drilling dimensions(after plating)
 (thickness 1.60±0.20mm)

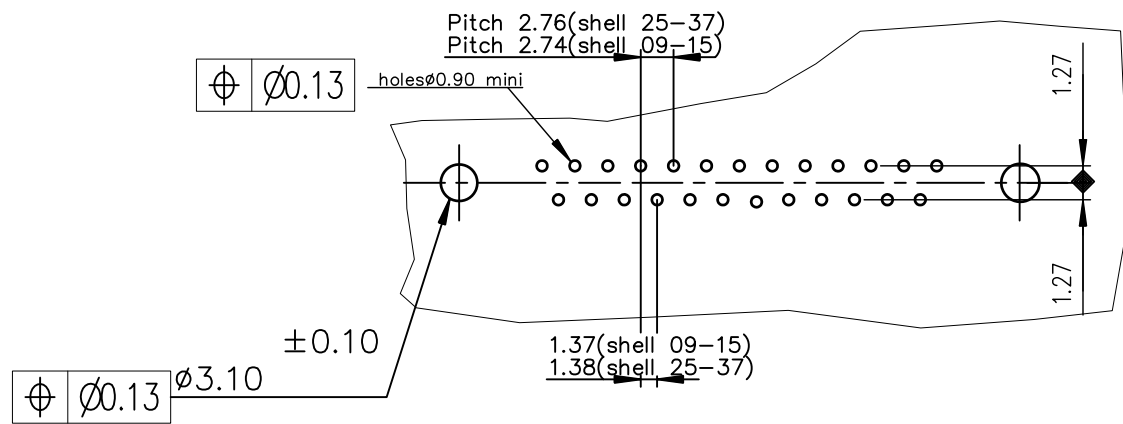

Pull Parts							
SHELL	A±0.38	B±0.12	C±0.10	D±0.25	PART NUMBER	LEAD FREE P/N	
09	30.81	24.99	16.96	16.21	D09S13A*GL00	D09S13A*GL00LF	
15	39.14	33.32	25.18	24.54	D15S13A*GL00	D15S13A*GL00LF	
25	53.03	47.04	39.12	38.25	D25S13A*GL00	D25S13A*GL00LF	
37	69.32	63.50	55.68	54.71	D37S13A*GL00	D37S13A*GL00LF	

4-200 MATING CYCLES
 6-500 MATING CYCLES

GENERAL CHARACTERISTICS : SEE DRAWING C01-8646-0000

mat'l. code SEE.NOTES				surface ISO 1302 ✓		tolerance ISO 406 ISO 1101		projection MM		product family D-SUB	
ltr	ecn no	dr	date	tolerances unless otherwise specified		angles		linear		title	
G	[05-0124	JS	2005/07/27	O.X ±0.1		linear		O.XX ±0.1		SOCKET CONNECT.DELTA D RIGHT ANGLE	
H	[06-0074	SK	2006/06/08	O.XXX ±0.1		0.XX±2°		O.XXX±0.1		WITH NUT,HARPON and metal plate.	
J	ELXI-I-15060	AB	2013/06/25	dr		JOHN.SLEEBA		1994/10/14		dwg no	
K	ELX-I-18948	AB	2014/09/29	enr		ALIAS.BABU		2014/09/29		sheet 1 of 1	
				chr		MITHUN.PAUL		2014/09/29		size 5	
				appd		BIJU.K.PAUL		2014/09/29		A3	
				sheet index						type	
				revision		K				CUSTOMER Drawing	
				sheet		1					