



Chipsmall Limited consists of a professional team with an average of over 10 year of expertise in the distribution of electronic components. Based in Hongkong, we have already established firm and mutual-benefit business relationships with customers from,Europe,America and south Asia,supplying obsolete and hard-to-find components to meet their specific needs.

With the principle of “Quality Parts,Customers Priority,Honest Operation,and Considerate Service”,our business mainly focus on the distribution of electronic components. Line cards we deal with include Microchip,ALPS,ROHM,Xilinx,Pulse,ON,Everlight and Freescale. Main products comprise IC,Modules,Potentiometer,IC Socket,Relay,Connector.Our parts cover such applications as commercial,industrial, and automotives areas.

We are looking forward to setting up business relationship with you and hope to provide you with the best service and solution. Let us make a better world for our industry!



Contact us

Tel: +86-755-8981 8866 Fax: +86-755-8427 6832

Email & Skype: info@chipsmall.com Web: www.chipsmall.com

Address: A1208, Overseas Decoration Building, #122 Zhenhua RD., Futian, Shenzhen, China



MODEL NUMBER	DCB-3510-FF-SMA-02
REV.	D1

- NOTES:
- 1.0 ELECTRICAL SPECIFICATIONS:
 - 1.1 FREQUENCY RANGE: 250 MHz to 18.5 GHz
 - 1.2 IMPEDANCE: 50 OHMS, NOM.
 - 1.3 VSWR: 1.35:1 MAX.
 - 1.4 INSERTION LOSS: 0.5dB MAX.
 - 1.5 INSERTION LOSS AT 1 KHz: > 60dB
 - 1.6 DC WORKING VOLTAGE: 200 VOLTS, MIN.
 - 1.7 OPERATING TEMPERATURE: -65°C to +125°C
 - 1.8 TYPE: INNER ONLY

2.0 MARKING: MARK UNIT AS SHOWN
(REF.: INK-04702-27-03)

3.0 DIMENSIONS IN PARENTHESIS ARE IN MILLIMETERS.

SMA FEMALE CONN.
PER MIL-PRF-39012

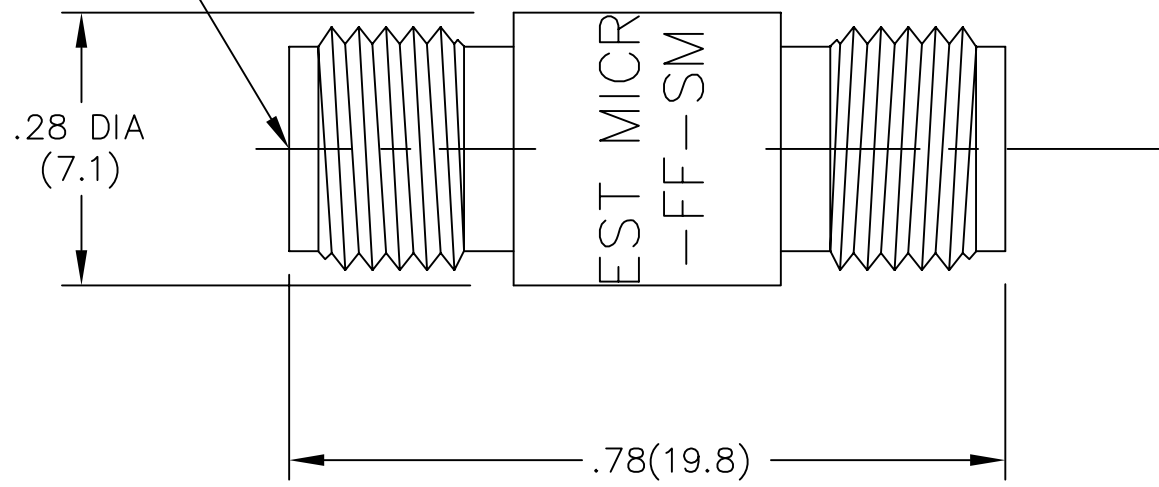

DWG NO. WAS: 03973-01-00

REV.	DESCRIPTION	DATE
-	RELEASED	3/5/82
A	ECR 2201	5/23/83
B	ECR 6545	7/10/89
C	ECN 12424	2/11/93
D	ECN 12489	3/16/93
D1	ADDED TITLEBLOCK	5/25/05

UNLESS OTHERWISE NOTED DIMENSIONS ARE IN INCHES AND TOLERANCES ARE: 3 PLACE DECIMALS ±.005 2 PLACE DECIMALS ±.02 FRACTIONS ±1/64 PARALLELITY: T.I.R. FLATNESS: T.I.R. CONCENTRICITY: T.I.R. ANGLES AND PERPENDICULARITY:	FSCM NO. 34078	MIDWEST MICROWAVE	
	NOTICE: The information contained in this drawing is proprietary and must not be used without the permission of Midwest Microwave	TITLE DC BLOCK	
	DRAWN/DATE A.BEATTY 2/12/93	ENG./DATE G.KOZAK 2/18/93	DRAWING NUMBER DCB-3510-FF-SMA-02
	CHECKED/DATE M.HOLLMAN 2/17/93	APPROVED/DATE	SCALE: 5=1 SHEET 1 of 1