



Chipsmall Limited consists of a professional team with an average of over 10 year of expertise in the distribution of electronic components. Based in Hongkong, we have already established firm and mutual-benefit business relationships with customers from,Europe,America and south Asia,supplying obsolete and hard-to-find components to meet their specific needs.

With the principle of “Quality Parts,Customers Priority,Honest Operation,and Considerate Service”,our business mainly focus on the distribution of electronic components. Line cards we deal with include Microchip,ALPS,ROHM,Xilinx,Pulse,ON,Everlight and Freescale. Main products comprise IC,Modules,Potentiometer,IC Socket,Relay,Connector.Our parts cover such applications as commercial,industrial, and automotives areas.

We are looking forward to setting up business relationship with you and hope to provide you with the best service and solution. Let us make a better world for our industry!



Contact us

Tel: +86-755-8981 8866 Fax: +86-755-8427 6832

Email & Skype: info@chipsmall.com Web: www.chipsmall.com

Address: A1208, Overseas Decoration Building, #122 Zhenhua RD., Futian, Shenzhen, China



Multilayer Chip Band Pass Filters For 2.4GHz W-LAN/Bluetooth

Conformity to RoHS Directive

DEA Series DEA252450BT-2134B1

SHAPES AND DIMENSIONS

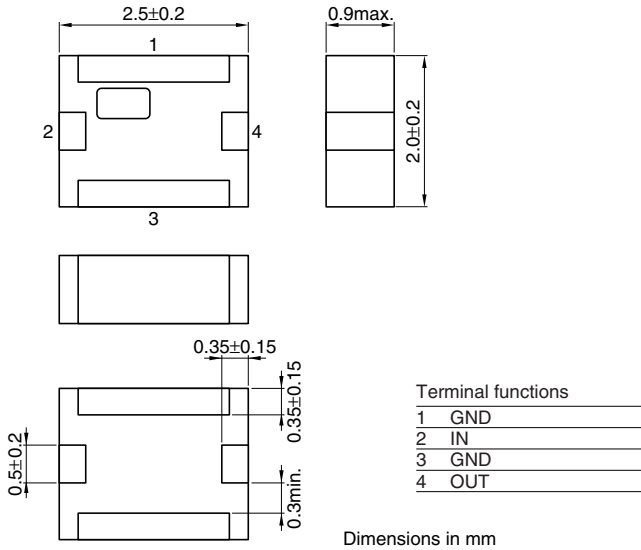

RECOMMENDED PC BOARD PATTERNS

LAND

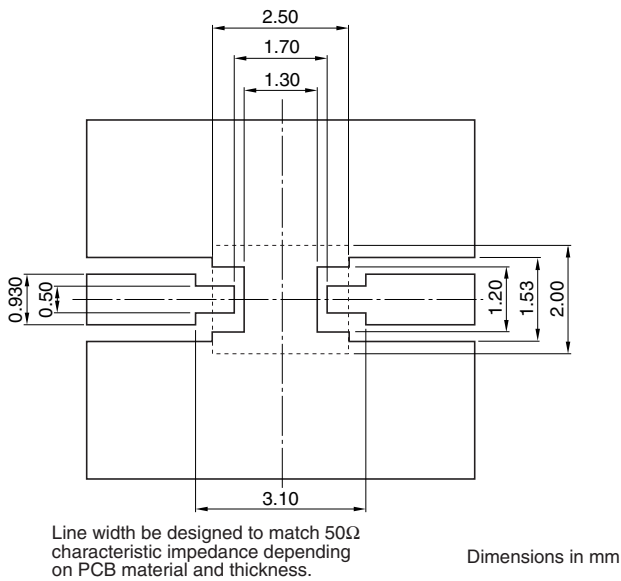

SOLDER RESIST

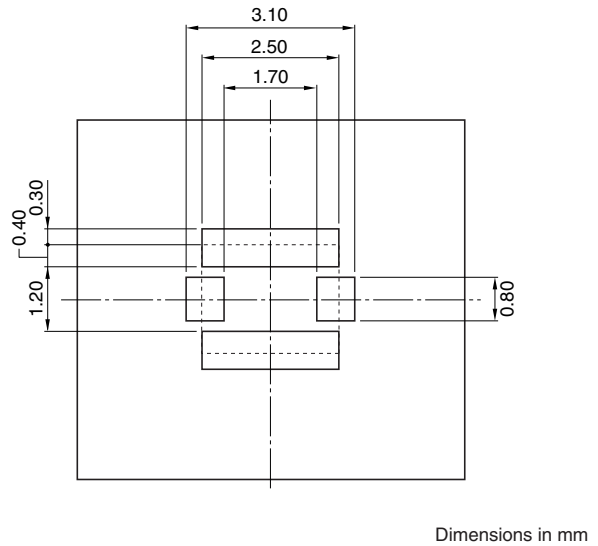

- Conformity to RoHS Directive: This means that, in conformity with EU Directive 2002/95/EC, lead, cadmium, mercury, hexavalent chromium, and specific bromine-based flame retardants, PBB and PBDE, have not been used, except for exempted applications.

- All specifications are subject to change without notice.

ELECTRICAL CHARACTERISTICS

Item		Typical value	
Frequency range(Pass band)	2400 to 2500MHz	—	
Single ended port characteristic impedance	50Ω (Nominal)	—	
Insertion loss(Pass band)	[+25°C]	2.5dB max.	2.0dB
	[-40 to +85°C]	—	—
Attenuation	[824 to 849MHz]	42dB min.	47dB
	[869 to 894MHz]	42dB min.	45dB
	[894 to 915MHz]	42dB min.	45dB
	[925 to 960MHz]	42dB min.	45dB
	[1570 to 1580MHz]	40dB min.	43dB
	[1710 to 1785MHz]	43dB min.	44dB
	[1805 to 1850MHz]	41dB min.	46dB
	[1850 to 1910MHz]	41dB min.	48dB
	[1920 to 1990MHz]	40dB min.	50dB
	[2110 to 2170MHz]	35dB min.	40dB
Temperature range	Operating	-40 to +85°C	
	Storage	-40 to +85°C	

• Ta:+25°C

FREQUENCY CHARACTERISTICS

INSERTION LOSS

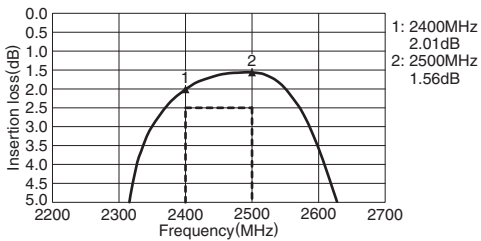

ATTENUATION

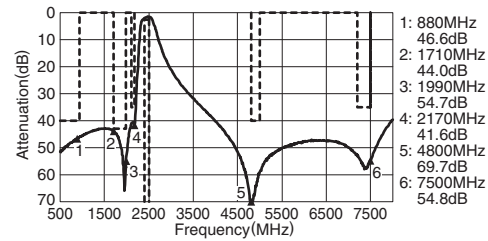

RETURN LOSS

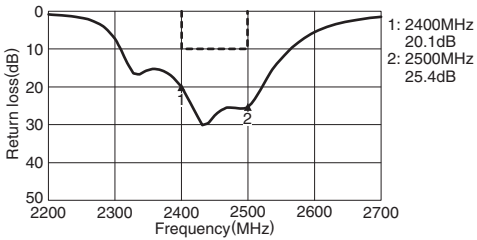

VSWR

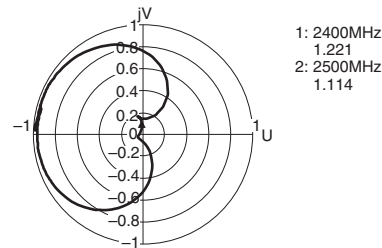

• All specifications are subject to change without notice.