



Chipsmall Limited consists of a professional team with an average of over 10 year of expertise in the distribution of electronic components. Based in Hongkong, we have already established firm and mutual-benefit business relationships with customers from,Europe,America and south Asia,supplying obsolete and hard-to-find components to meet their specific needs.

With the principle of “Quality Parts,Customers Priority,Honest Operation,and Considerate Service”,our business mainly focus on the distribution of electronic components. Line cards we deal with include Microchip,ALPS,ROHM,Xilinx,Pulse,ON,Everlight and Freescale. Main products comprise IC,Modules,Potentiometer,IC Socket,Relay,Connector.Our parts cover such applications as commercial,industrial, and automotives areas.

We are looking forward to setting up business relationship with you and hope to provide you with the best service and solution. Let us make a better world for our industry!



Contact us

Tel: +86-755-8981 8866 Fax: +86-755-8427 6832

Email & Skype: info@chipsmall.com Web: www.chipsmall.com

Address: A1208, Overseas Decoration Building, #122 Zhenhua RD., Futian, Shenzhen, China





All dimensions in mm

- Provides an easy means of exit through a normally locked door
- Touch-free technology
- 12 VDC
- 2 Year limited warranty
- Designed to meet FCC and CE requirements
- Illuminated for easy visual location
- Colour change to indicate activation

Request to Exit Switch (Illuminated)

Specified for use with all Storm AXS access control systems this touch-free technology 'request to exit' switch allows personnel to leave a secured area by simply waving their hand across an illuminated sensor.

This device is designed to be easily installed to a flush mounted, standard US format, electrical back box.

This REX switch provides a fast and convenient lock release for a defined (timed) duration. The active switch is surrounded by an illuminated annular ring that changes colour when the switch is activated. Intended for location at the secured side of any access controlled door.



Typical Installation of a Request to Exit Switch

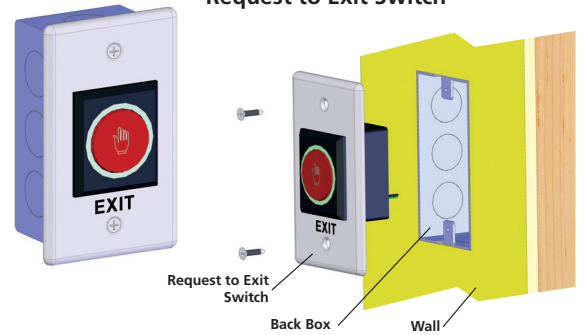

For more information & to order:

www.storm-interface.com



Whilst every effort is made to ensure details are correct at time of print, specifications are subject to change without notice.

Designed & produced by NIK Design nik@nikdesign.co.uk

Storm Interface products include technology protected by international patents and design registration. All rights reserved.



Storm is a trademark of Keymat Technology Ltd
Storm Interface is a trading name of Keymat Technology Ltd

DEEX010 July 2014



FM 39602

