



Chipsmall Limited consists of a professional team with an average of over 10 year of expertise in the distribution of electronic components. Based in Hongkong, we have already established firm and mutual-benefit business relationships with customers from,Europe,America and south Asia,supplying obsolete and hard-to-find components to meet their specific needs.

With the principle of “Quality Parts,Customers Priority,Honest Operation,and Considerate Service”,our business mainly focus on the distribution of electronic components. Line cards we deal with include Microchip,ALPS,ROHM,Xilinx,Pulse,ON,Everlight and Freescale. Main products comprise IC,Modules,Potentiometer,IC Socket,Relay,Connector.Our parts cover such applications as commercial,industrial, and automotives areas.

We are looking forward to setting up business relationship with you and hope to provide you with the best service and solution. Let us make a better world for our industry!



Contact us

Tel: +86-755-8981 8866 Fax: +86-755-8427 6832

Email & Skype: info@chipsmall.com Web: www.chipsmall.com

Address: A1208, Overseas Decoration Building, #122 Zhenhua RD., Futian, Shenzhen, China



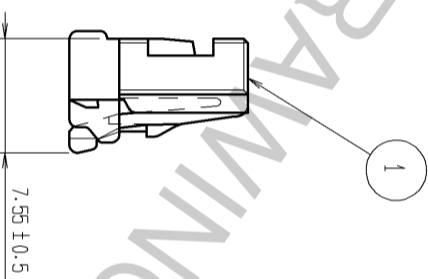
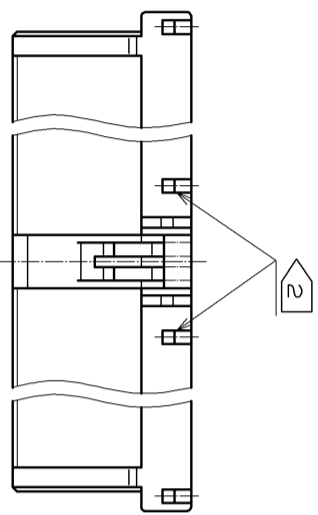
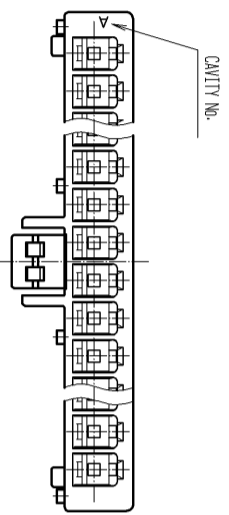
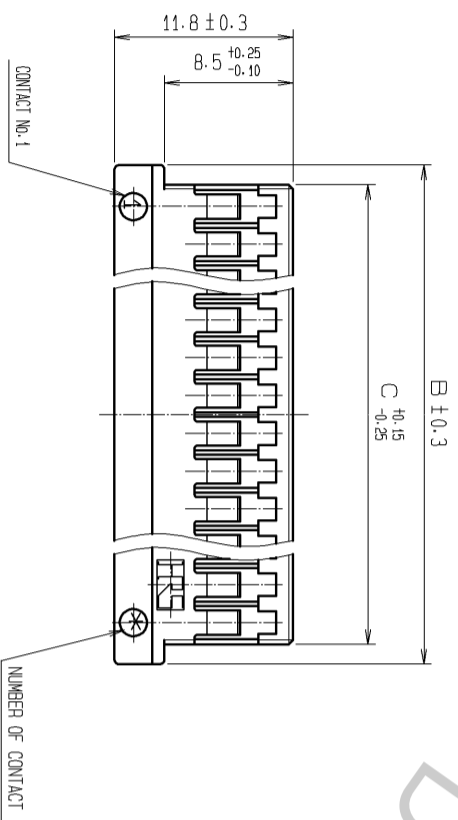
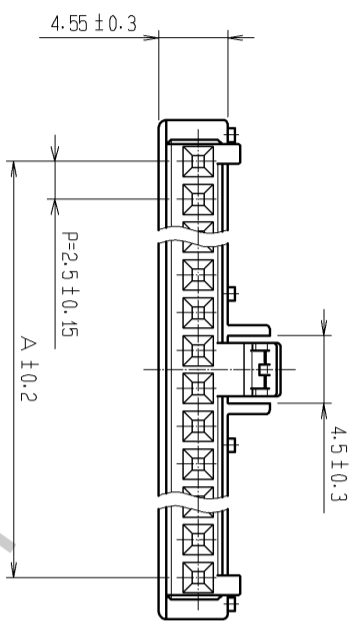

FOR DF1E-2S-2.5C

FOR DF1E-3S-2.5C

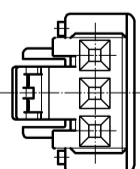
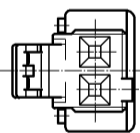
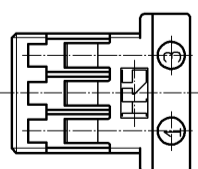
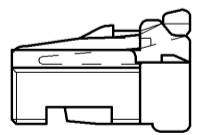
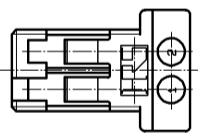
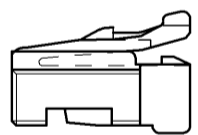

△ PART No.	CODE No.	NUMBER OF CONTACTS	A	B	C
DF1E-2S-2.5C	CL541-0811-0	2	2.5	8.0	5.4
DF1E-3S-2.5C	CL541-0812-2	3	5.0	10.5	7.9
DF1E-4S-2.5C	CL541-0813-5	4	7.5	13.0	10.4
DF1E-5S-2.5C	CL541-0814-8	5	10.0	15.5	12.9
DF1E-6S-2.5C	CL541-0815-0	6	12.5	18.0	15.4
DF1E-7S-2.5C	CL541-0816-3	7	15.0	20.5	17.9
DF1E-8S-2.5C	CL541-0817-0	8	17.5	23.0	20.4
DF1E-9S-2.5C	CL541-0818-9	9	20.0	25.5	22.9
DF1E-10S-2.5C	CL541-0819-1	10	22.5	28.0	25.4
DF1E-11S-2.5C	CL541-0820-0	11	25.0	30.5	27.9
DF1E-12S-2.5C	CL541-0821-3	12	27.5	33.0	30.4
DF1E-13S-2.5C	CL541-0822-6	13	30.0	35.5	32.9
DF1E-14S-2.5C	CL541-0823-9	14	32.5	38.0	35.4
DF1E-15S-2.5C	CL541-0824-1	15	35.0	40.5	37.9

NOTES
 1 : CONFIGURATION OF DF1E-2S-2.5C AND DF1E-3S-2.5C
 2 : ONLY APPLICABLE TO PRODUCTS OF 6 POSITIONS AND OVER.
 (TWO PROTRUSIONS ARE NOT PROVIDED TO PRODUCTS OF 5 POSITIONS AND BELOW.)
 3 : 1 PACK 100 PIECES.

NO.	MATERIAL	FINISH	REMARKS	NO.	POLYAMIDE	WHITE(NATURAL). UL94V-0
1				1		

UNITS	SCALE	COUNT	DESCRIPTION OF REVISIONS	DESIGNED	CHECKED	DATE
mm	2 : 1	3	DIS-H-006008	MI. SAKIWARA	HK. UMEHARA	11.07.20

APPROVED	TY. OMA	07.02.27	DRAWING NO.	EDC3-161939-01
CHECKED	HK. UMEHARA	07.02.27	PART NO.	DF1E-S-2.5C
DESIGNED	AH. MIYAZAKI	07.02.22	CODE NO.	CL541-
DRAWN	AK. MURA	07.02.22		