



Chipsmall Limited consists of a professional team with an average of over 10 year of expertise in the distribution of electronic components. Based in Hongkong, we have already established firm and mutual-benefit business relationships with customers from,Europe,America and south Asia,supplying obsolete and hard-to-find components to meet their specific needs.

With the principle of “Quality Parts,Customers Priority,Honest Operation,and Considerate Service”,our business mainly focus on the distribution of electronic components. Line cards we deal with include Microchip,ALPS,ROHM,Xilinx,Pulse,ON,Everlight and Freescale. Main products comprise IC,Modules,Potentiometer,IC Socket,Relay,Connector.Our parts cover such applications as commercial,industrial, and automotives areas.

We are looking forward to setting up business relationship with you and hope to provide you with the best service and solution. Let us make a better world for our industry!



Contact us

Tel: +86-755-8981 8866 Fax: +86-755-8427 6832

Email & Skype: info@chipsmall.com Web: www.chipsmall.com

Address: A1208, Overseas Decoration Building, #122 Zhenhua RD., Futian, Shenzhen, China



0.6mm Pitch Board-to-Fine-Coaxial Cable Connectors

DF21 Series

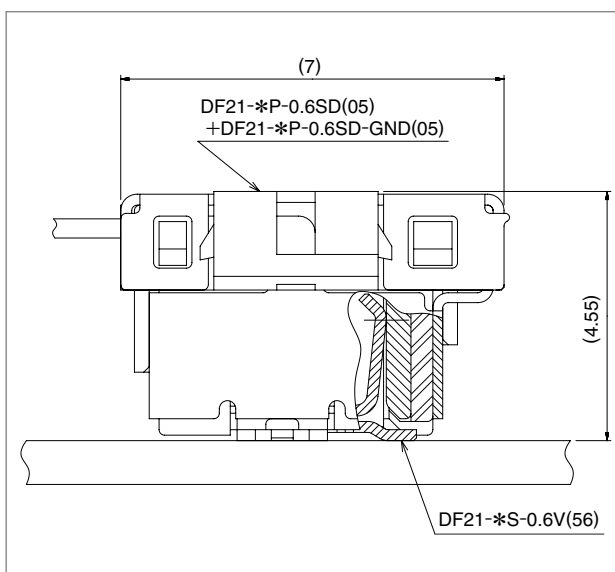
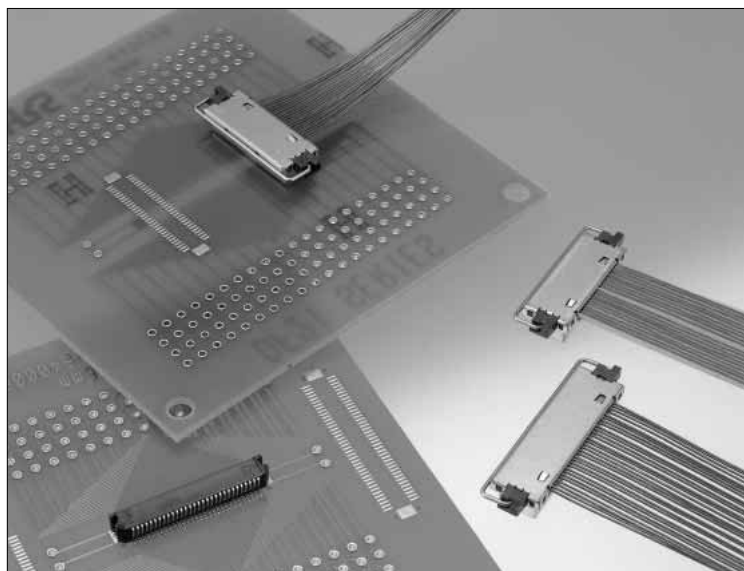

■ Features

1. High Interconnection Reliability

Effective contact mating length of 1.55 mm, innovative bellow style contact design, built-in interlocking feature of mated connectors assures high electrical and mechanical reliability, providing needed rigidity to resist excessive twisting.

Superior reliability of the termination of the fine coaxial cable is accomplished with batch soldering.

2. Shielded design

Metal shell encloses the connector and makes contact with all external conductors of the fine coaxial cable permitting reliable ground connection to the board side of mated assemblies.

3. Reliable mating/unmating

The connectors are self-align during mating.

Optional pull-out tab permits connection and disconnection in narrow spaces.

Polarized configuration prevents incorrect mating.

4. Board placement with Automatic Equipment.

The upper surface provides flat area for placement of embossed tape packaged connectors with vacuum nozzles of automatic equipment.

■ Applications

Notebook computers, liquid crystal displays (LCD), video and audio devices, medical instruments, portable devices and any other device requiring reliable connection and termination with fine pitch coaxial cable.

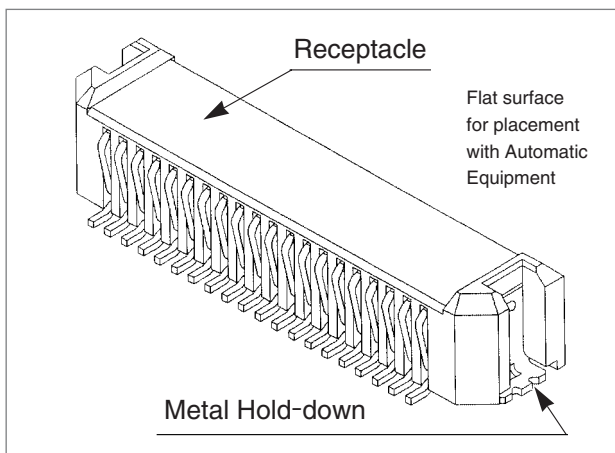

DF21 Series 0.6mm Pitch Board-to-Fine-Coaxial Cable Connectors

Product Specifications

| | | | | | |
|---------|----------------|-----------|----------------------------------|-----------------------------|------------------------|
| Ratings | Current rating | Wire size | AWG #40: 0.3 A AWG #36: 0.5 A | Operating temperature range | -35°C to 85°C (Note 1) |
| | | | | Operating humidity range | 20% to 80% |
| | | | | Storage temperature range | -10°C to 60°C (Note 2) |
| | Voltage rating | 50 V AC | | Storage humidity range | 40% to 70% (Note 2) |

| Item | Specifications | Condition |
|---------------------------------|---|--|
| 1. Insulation resistance | 500M ohms min. | Measured at 100 V DC |
| 2. Withstanding voltage | No flashover or insulation breakdown | Conduction of 150 V AC applied for 1 minute |
| 3. Contact resistance | 100m ohms max. | Measured at 100 mA |
| 4. Vibration | No electrical discontinuity of 1μs or more. | Frequency of 10 to 55 Hz, single amplitude of 0.75 mm, in 3 directions, 2 hours |
| 5. Humidity | Contact resistance of 100m ohms max., insulation resistance of 50 M ohms min. | Temperature of 40±2°C, humidity of 90% to 95%, left standing for 96 hours |
| 6. Temperature cycle | Contact resistance of 100m ohms max., insulation resistance of 50 M ohms min. | (-55°C : 30minutes → 5 to 35°C : 2 to 3minutes → 85°C : 30minutes → 5 to 35°C : 2 to 3minutes) for 5 cycles |
| 7. Durability | Contact resistance of 100m ohms max. | 30 cycles (mating/unmating) |
| 8. Resistance to Reflow heat | No melting of the resin parts that will affect performance | Reflow: at the recommended temperature profile, Solder: at a soldering iron temperature of 300°C for 3 seconds |
| 9. Resistance to Soldering heat | No deformation of the insulator parts affecting performance. | Solder bond: Within 5 seconds at 270°C max., Within 30 seconds at 200°C min. Hand soldering: Soldering iron temperature 300°C, 3 seconds |

Note 1: Includes temperature rise caused by current flow.

Note 2: The term "storage" refers to products stored for long period of time prior to mounting and use. Operating Temperature Range and Humidity range covers non- conducting condition of installed connectors in storage, shipment or during transportation.

Note 3: Information contained in this catalog represents general requirements for this Series. Contact us for the drawings and specifications for a specific part number shown.

Materials

| Item | Part | Material | Finish | Remarks |
|-------------|----------------|-----------------|--------------------|---------|
| Receptacles | Insulator | LCP | Black | UL94V-0 |
| | Contacts | Phosphor bronze | Gold plating | — |
| | Metal fittings | Phosphor bronze | Tin copper plating | — |
| Plugs | Insulator | LCP | Black | UL94V-0 |
| | Contacts | Phosphor bronze | Gold plating | — |
| | Metal shell | Phosphor bronze | Tin plating | — |
| Metal shell | Metal shell | Stainless steel | Tin copper plating | — |

Ordering information

●Receptacles/Plug

DF 21 - * P - 0.6 SD - GND

① ② ③ ④ ⑤ ⑥

| | |
|--|--|
| ① Series name : DF21 | ⑤ Termination section V : Straight SMT SD : Fine coaxial cable |
| ② Number of contacts : 20, 30 | |
| ③ Connector type S : Single-row receptacle P : Single-row plug | |
| ④ Contact pitch : 0.6 mm | ⑥ Plug mounting parts GND : Metal shell-required |

Note: The metal shell is an absolutely necessary part at the time of wiring.

Receptacles

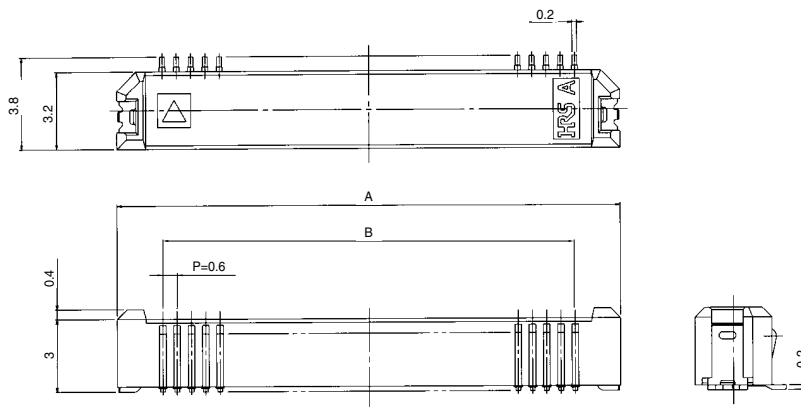
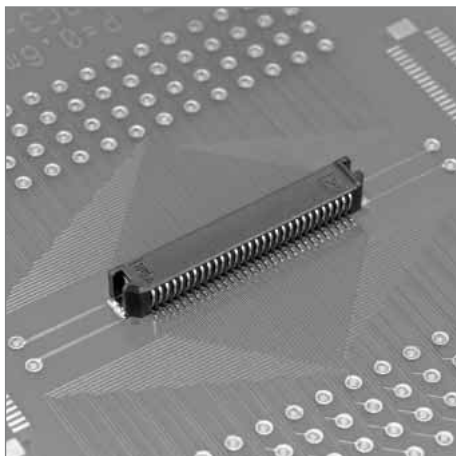

Embossed Carrier Tape Dimensions

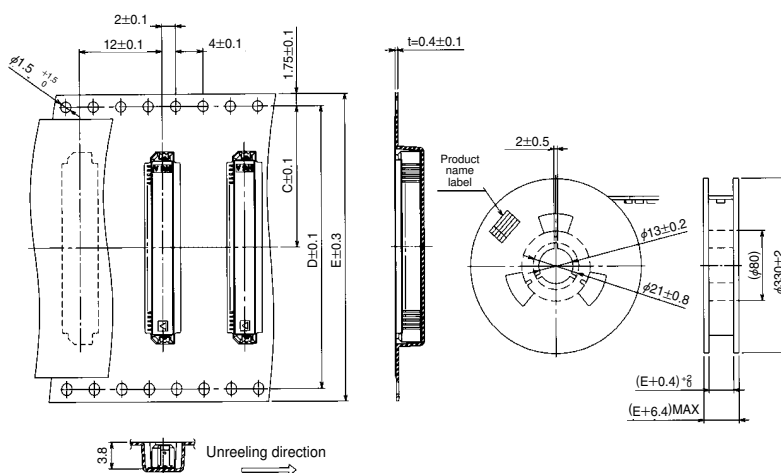

[Specifications number] - **, (***)
 (56) : Embossed tape packaging (1,000 pieces per reel)

Unit: mm

| Product No. | CL No. | Number of Contacts | A | B | C | D | E | F | RoHS |
|-------------------|---------------|--------------------|------|------|------|------|----|------|------|
| DF21-20S-0.6V(56) | 687-0001-5-56 | 20 | 15.2 | 11.4 | 11.5 | | 24 | 12.6 | YES |
| DF21-30S-0.6V(56) | 687-0003-0-56 | 30 | 21.2 | 17.4 | 14.2 | 28.4 | 32 | 18.6 | |

Note : One reel contains 1,000 pieces package unit. Please order by the package unit.

Recommended PCB mounting pattern

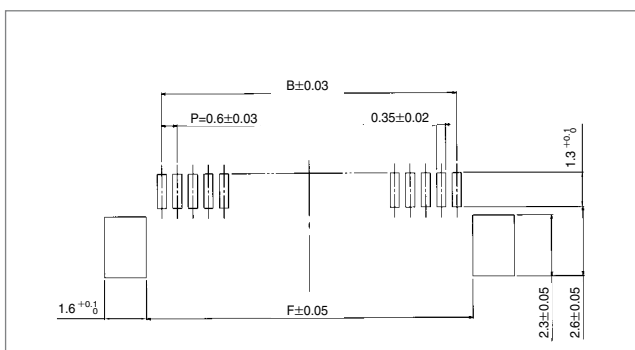

DF21 Series 0.6mm Pitch Board-to-Fine Coaxial Cable Connectors

■Plugs

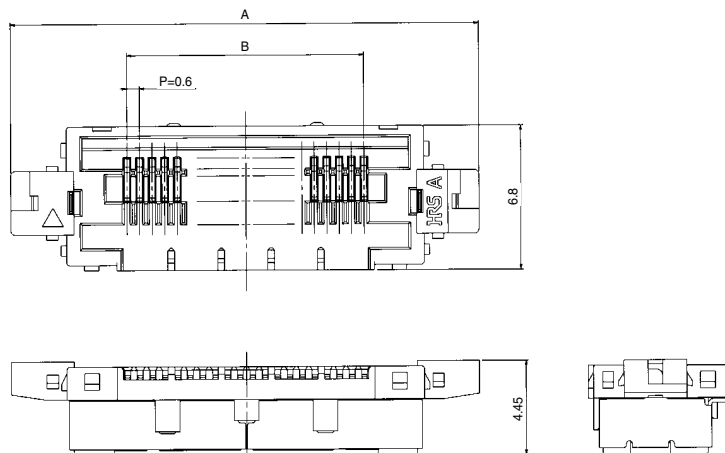
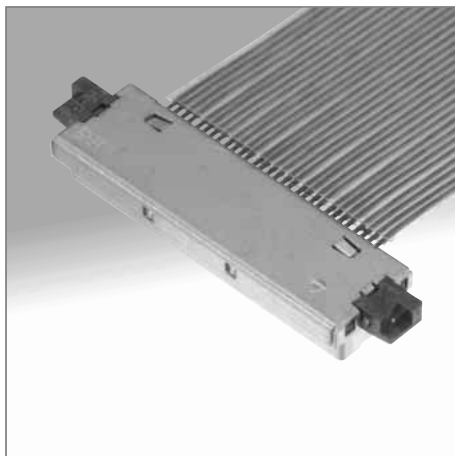

Unit: mm

| Product No. | CL No. | Number of Contacts | A | B | C | RoHS |
|--------------------|---------------|--------------------|------|------|----|------|
| DF21-20P-0.6SD(05) | 687-1500-0-05 | 20 | 22.5 | 11.4 | 15 | YES |
| DF21-30P-0.6SD(05) | 687-1502-6-05 | 30 | 28.5 | 17.4 | 21 | |

Note 1 : One package unit contains 100 pieces. Please order by the package unit.

Note 2: The metal shell is an absolutely necessary part at the time of wiring.

●Recommended Fine Coaxial Cable Preparation

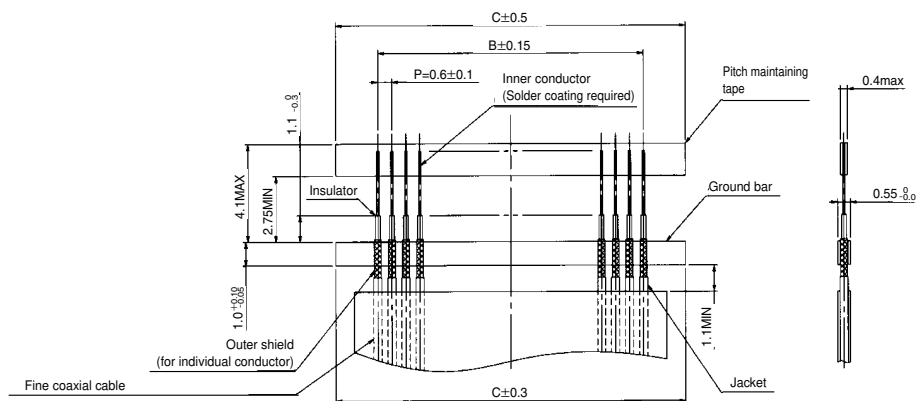

Note 1: The pitch maintaining tape can be left in place during the termination process. Use high quality tape.

Note 2: When using 2-conductor coaxial cable, some contact positions will not be usable.

Contact nearest Hirose sales office for recommendation on specific application.

Note 3: Contact Hirose for Termination Procedures.

■Metal shell-Required for assembly of the Plug

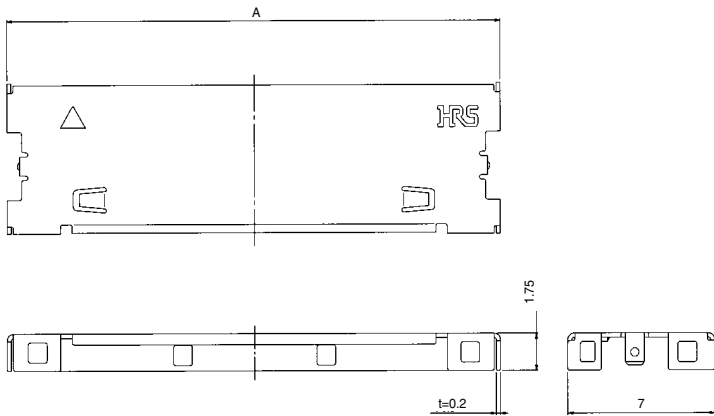

Unit: mm

| Product No. | CL No. | Number of Contacts | A | RoHS |
|------------------------|---------------|--------------------|------|------|
| DF21-20P-0.6SD-GND(05) | 687-2500-6-05 | 20 | 17.7 | YES |
| DF21-30P-0.6SD-GND(05) | 687-2502-1-05 | 30 | 23.7 | |

Note 1: One package unit contains 100 pieces. Please order by the package unit.
Note 2: The metal shell is an absolutely necessary part at the time of wiring.

DF21 Series 0.6mm Pitch Board-to-Pine Coaxial Cable Connectors

Usage Recommendations

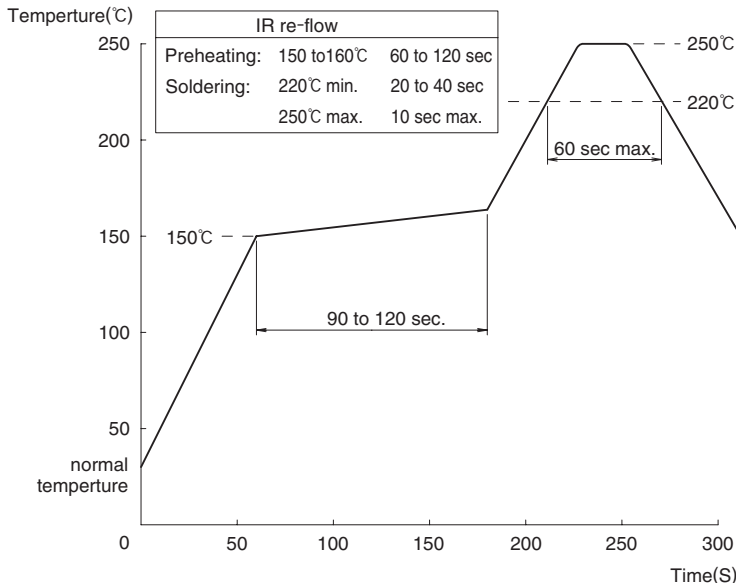
| | |
|---|---|
| 1. Recommended Temperature Profile |  <p>Temperature(°C)</p> <p>250</p> <p>200</p> <p>150</p> <p>100</p> <p>50</p> <p>normal temperature</p> <p>0 50 100 150 200 250 300</p> <p>Time(S)</p> <p>IR re-flow</p> <p>Preheating: 150 to 160°C 60 to 120 sec</p> <p>Soldering: 220°C min. 20 to 40 sec</p> <p>250°C max. 10 sec max.</p> <p>60 sec max.</p> <p>90 to 120 sec.</p> <p>250°C</p> <p>220°C</p> <p>Note 1: Up to 2 cycles of reflow soldering are possible under the same conditions, provided that there is a return to normal temperature between the first and second cycle.</p> <p>Note 2: The temperature profile indicates the board surface temperature at the point of contacts with the connector terminals (for surface mounted plug assembly).</p> |
| 1. Receptacle Recommended Manual Soldering Conditions | Soldering temperature: 340°C ±10°C, soldering time: within 5 sec. |
| 2. Recommended Screen Thickness | 0.15mm |
| 3. Board Warping | Maximum of 0.03 mm at the connector center section, with both ends of the connector as reference points. |
| 4. Cleaning Conditions | Refer to "Nylon Connector Use Handbook." |
| 5. Plug Recommended Soldering Conditions | 260°C ±5°C within 5 sec, 200°C min. within 25 sec. |
| 6. Handling and use precautions | <p>■DO NOT mate/un-mate non-terminated plugs with non-mounted receptacles. This may lead to damage or deformation of the contacts.</p> <p>■DO NOT touch the exposed contacts of the receptacle with bare fingers. This may leave non-conductive film, cause corrosion or electrostatic discharge, affecting performance of the connectors or sensitive electronic components.</p> <p>■DO NOT apply flux to the contact terminals when hand soldering the receptacle to the board. Wicking of the flux into the electrical contact areas may lead to connection failures.</p> |