



Chipsmall Limited consists of a professional team with an average of over 10 year of expertise in the distribution of electronic components. Based in Hongkong, we have already established firm and mutual-benefit business relationships with customers from,Europe,America and south Asia,supplying obsolete and hard-to-find components to meet their specific needs.

With the principle of “Quality Parts,Customers Priority,Honest Operation,and Considerate Service”,our business mainly focus on the distribution of electronic components. Line cards we deal with include Microchip,ALPS,ROHM,Xilinx,Pulse,ON,Everlight and Freescale. Main products comprise IC,Modules,Potentiometer,IC Socket,Relay,Connector.Our parts cover such applications as commercial,industrial, and automotives areas.

We are looking forward to setting up business relationship with you and hope to provide you with the best service and solution. Let us make a better world for our industry!



Contact us

Tel: +86-755-8981 8866 Fax: +86-755-8427 6832

Email & Skype: info@chipsmall.com Web: www.chipsmall.com

Address: A1208, Overseas Decoration Building, #122 Zhenhua RD., Futian, Shenzhen, China



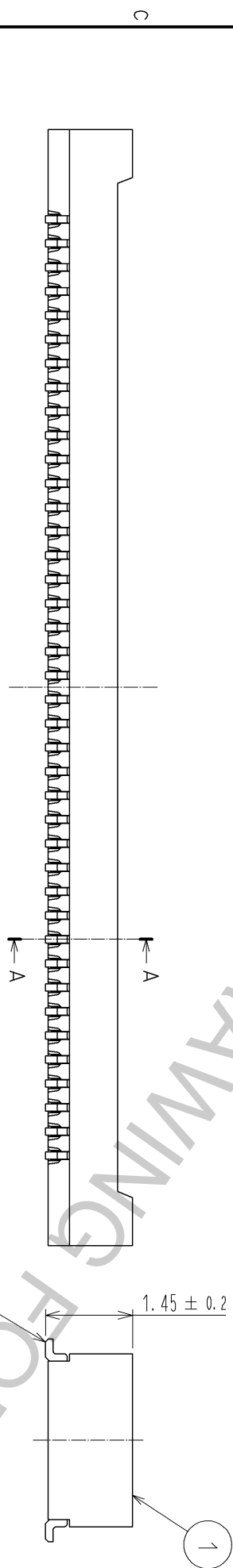
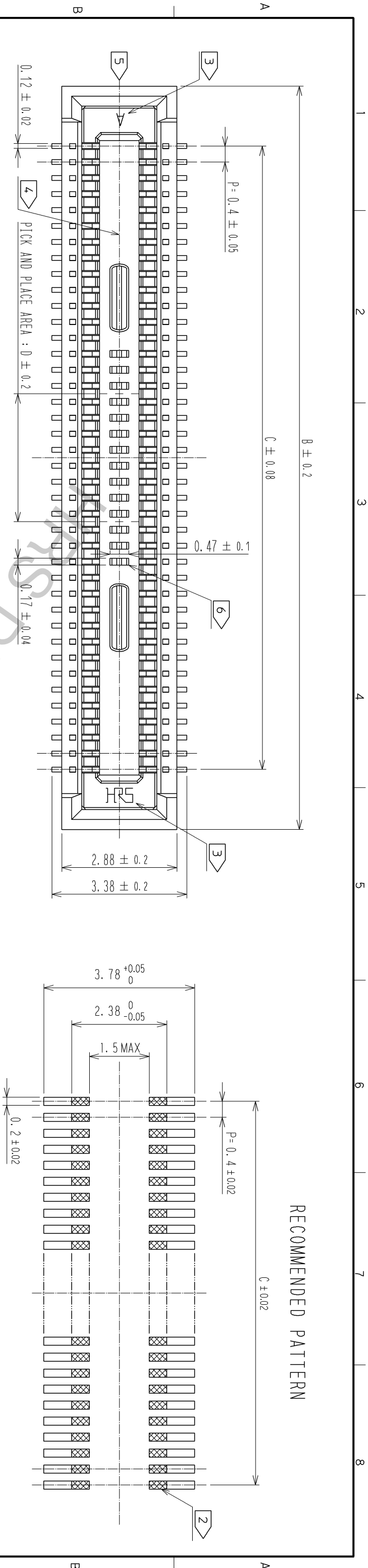

NOTES) 1. ALL LEADS CO-PLANARITY SHALL BE 0.1 MAX.
2. IS NO PATTERN AREA OTHER THAN THE SAME CIRCUIT.
3. HRS MARK AND CAV NO. IS INDICATED IN APPROXIMAL POSITION SHOWN.
4. GATE POSITION OF 60 TO 100 POSITIONS IS POSITIONED IN APPROXIMAL AREA SHOWN.
5. GATE POSITION OF 10 TO 50 POSITIONS IS POSITIONED IN APPROXIMAL AREA SHOWN.
6. A PART OF THE WALL COULD BE NOTCHED FOR SETTING GATE.
A PART OF THE WALL COULD BE NOTCHED FOR SETTING GATE.
60 TO 100 POSITIONS HAVE CONCAVE PORTION.

製品名	製品コード	B	C	D
DF40C-10DS-0.4V(51)	CL684-4036-2-51	4.6	1.6	1.0
DF40C-20DS-0.4V(51)	CL684-4005-9-51	6.6	3.6	1.0
DF40C-24DS-0.4V(51)	CL684-4006-1-51	7.4	4.4	1.0
DF40C-30DS-0.4V(51)	CL684-4007-4-51	8.6	5.6	1.5
DF40C-34DS-0.4V(51)	CL684-4023-0-51	9.4	6.4	2.3
DF40C-40DS-0.4V(51)	CL684-4008-7-51	10.6	7.6	3.2
DF40C-50DS-0.4V(51)	CL684-4009-0-51	12.6	9.6	3.2
DF40C-60DS-0.4V(51)	CL684-4004-6-51	14.6	11.6	3.2
DF40C-70DS-0.4V(51)	CL684-4016-5-51	16.6	13.6	3.2
DF40C-80DS-0.4V(51)	CL684-4002-0-51	18.6	15.6	3.2
DF40C-90DS-0.4V(51)	CL684-4124-8-51	20.6	17.6	3.2
DF40C-100DS-0.4V(51)	CL684-4033-4-51	22.6	19.6	3.2

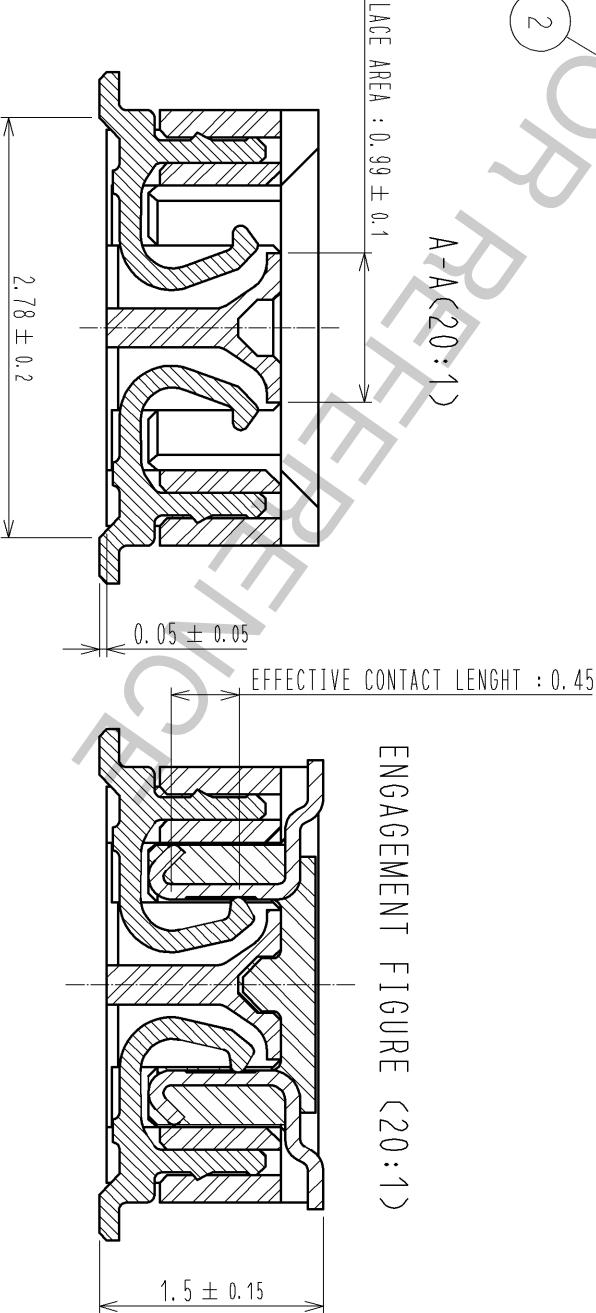

1	PHOSPHOR BRONZE	CONTACT AREA: GOLD 0.05 μm MIN SMT LEAD: GOLD 0.05 μm MIN UNDERPLATING: NICKEL 1 μm MIN	6	PS	CLEAR, REINFORCEMENT COLLAR
2	LCP	BLACK, UL94V-0	4	PS	BLACK, PLASTIC REEL
3	FINISH .	REMARKS	3	PS	CLEAR, COVER TAPE
4	FINISH .	REMARKS	4	PS	CLEAR, EMBOSSED CARRIER TAPE
5	FINISH .	REMARKS	5	PS	CLEAR, COVER TAPE
6	FINISH .	REMARKS	6	PS	CLEAR, COVER TAPE

UNITS	SCALE	COUNT	DESCRIPTION OF REVISIONS	NO.	MATERIAL	FINISH .	REMARKS
mm	10 : 1	2	DIS-H-006409	1	TR. YUNOKI	TS. MIYAZAKI	DATE
APPROVED : MO. NAKAMURA				05.12.09	DRAWING NO.		
CHECKED : KH. IKEDA				05.12.09	PART NO.		
DESIGNED : MY. GOTO				05.12.09	CODE		
DRAWN : MY. GOTO				05.12.09	CL684		

HIROSE ELECTRIC CO., LTD.	EDC3-311352-00	DF40C-*DS-0.4V(51)	CL684	1/2
---------------------------	----------------	--------------------	-------	-----

EMBOSSED CARRIER TAPE PACKAGING (5:1)

STYLE AND DIMENSION OF REEL(FREE SIZE)

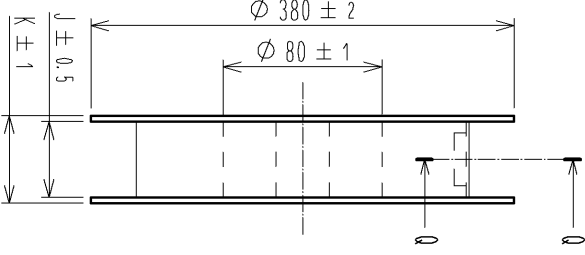
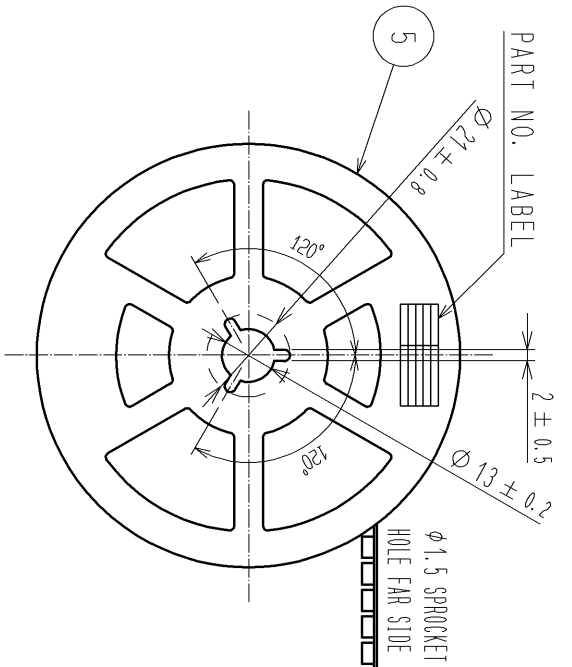
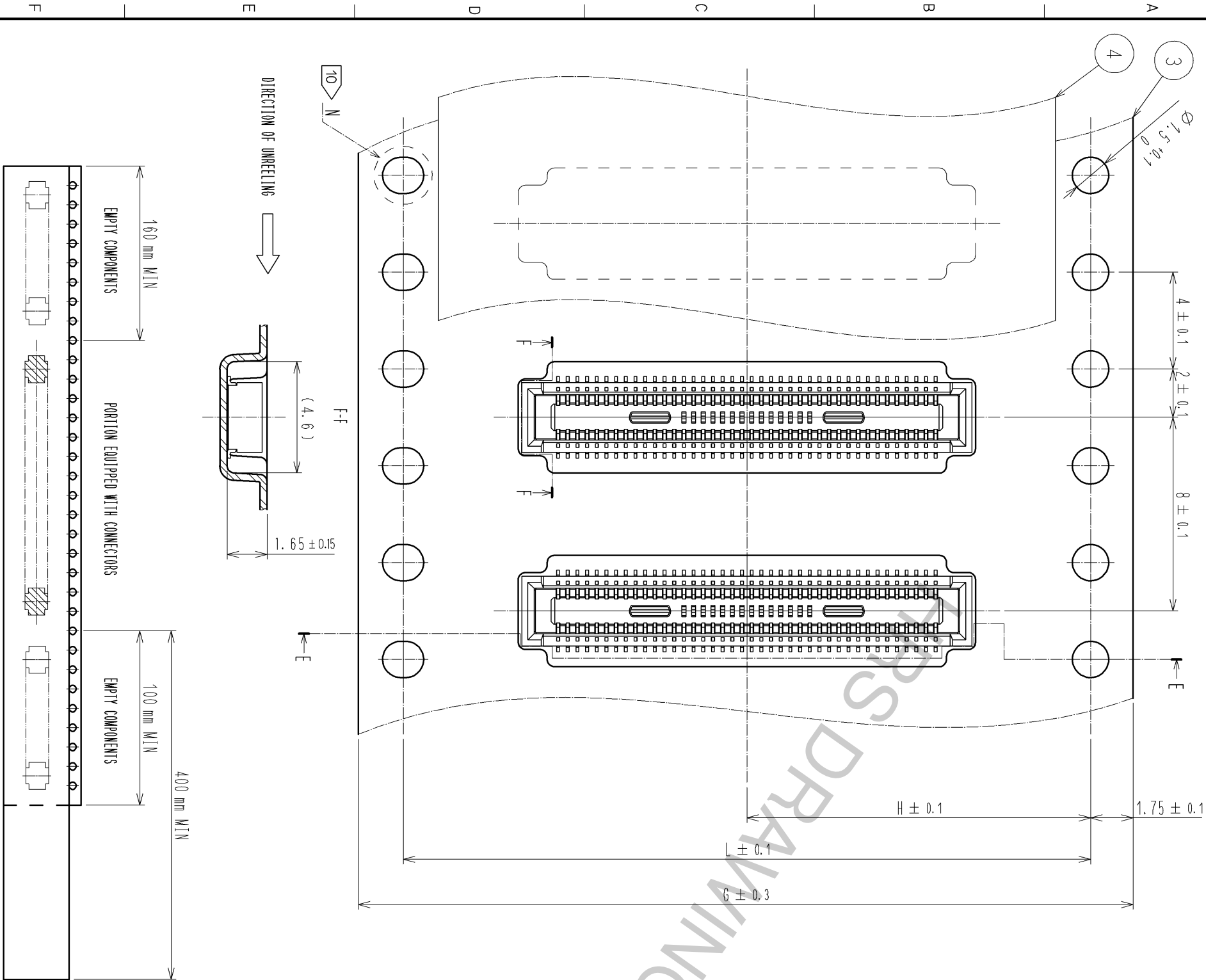

DETAIL OF PART NO. LABEL

製造年月日	** ** *	DATE OF MANUFACTURED
製品コード	CL684-***-51	CODE NO.
製品名	DF40C-DS-0.4V(51)	PART NO.
数量	5000	QUANTITY
納入者	ヒロセ電機(株)	SUPPLIER

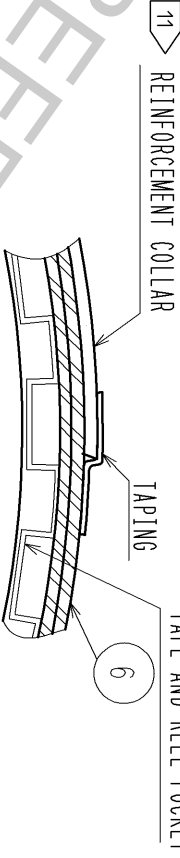

PART NO.	G	H	J	K	L	M
DF40C-100S-0.4V(51)	16	7.5	17.5	21.5	—	4.9
DF40C-200S-0.4V(51)	16	7.5	17.5	21.5	—	6.9
DF40C-240S-0.4V(51)	16	7.5	17.5	21.5	—	7.7
DF40C-300S-0.4V(51)	24	11.5	25.5	29.5	—	8.9
DF40C-340S-0.4V(51)	24	11.5	25.5	29.5	—	8.9
DF40C-400S-0.4V(51)	24	11.5	25.5	29.5	—	10.9
DF40C-500S-0.4V(51)	24	11.5	25.5	29.5	—	12.9
DF40C-600S-0.4V(51)	24	11.5	25.5	29.5	—	14.9
DF40C-700S-0.4V(51)	32	14.2	33.5	37.5	28.4	16.9
DF40C-800S-0.4V(51)	32	14.2	33.5	37.5	28.4	18.9
DF40C-900S-0.4V(51)	44	20.2	45.5	49.5	40.4	20.9
DF40C-1000S-0.4V(51)	44	20.2	45.5	49.5	40.4	22.9

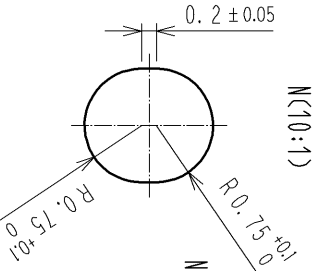

- NOTES)
7. PER REEL 5000 CONNECTORS.
 8. THE DIMENSIONS IN PARENTHESES ARE FOR REFERENCE.
 9. REFER TO JIS C 0806(PACKING OF COMPONENTS FOR AUTOMATIC HANDLING)
 10. 10 TO 60 POSITIONS EMBOSSED CARRIER TAPE HAS THE SPROCKET HOLE ON ONE SIDES.
 11. AFTER PACKAGING, ROLL 2 METERS OF THE REINFORCEMENT COLLAR TO OUTER CIRCUMFERENCE OF TAPE AND REEL POCKET, AND TAPE DOWN AT THE END THE COLLAR.

DRAWING NO.		EDC3-311352-00	
PART NO.	DF40C-DS-0.4V(51)	CODE	CL684
HRS		2/2	