



Chipsmall Limited consists of a professional team with an average of over 10 year of expertise in the distribution of electronic components. Based in Hongkong, we have already established firm and mutual-benefit business relationships with customers from,Europe,America and south Asia,supplying obsolete and hard-to-find components to meet their specific needs.

With the principle of “Quality Parts,Customers Priority,Honest Operation,and Considerate Service”,our business mainly focus on the distribution of electronic components. Line cards we deal with include Microchip,ALPS,ROHM,Xilinx,Pulse,ON,Everlight and Freescale. Main products comprise IC,Modules,Potentiometer,IC Socket,Relay,Connector.Our parts cover such applications as commercial,industrial, and automotives areas.

We are looking forward to setting up business relationship with you and hope to provide you with the best service and solution. Let us make a better world for our industry!



Contact us

Tel: +86-755-8981 8866 Fax: +86-755-8427 6832

Email & Skype: info@chipsmall.com Web: www.chipsmall.com

Address: A1208, Overseas Decoration Building, #122 Zhenhua RD., Futian, Shenzhen, China



Magnetically Compensated Choke, 1- and 3-phase



Description

- Current compensated choke
- 1- or 3-phase choke
- THT terminals or wire leads
- Flange for mounting onto printed circuit board
- Fully potted resin

Standards

- EN 60938
- UL 1283
- CSA 22.2 no 8

Applications

- Attenuation of common mode interferences
- May also be used in direct current applications where magnetic compensation is required
- Designed for 230/400 VAC applications

Weblinks

[pdf datasheet](#), [html-datasheet](#), [General Product Information](#), [Approvals](#), [CE declaration of conformity](#), [RoHS](#), [CHINA-RoHS](#), [REACH](#), [Distributor-Stock-Check](#), [Detailed request for product](#)

Technical Data

Rated voltage	up to 440 VAC	Test Voltage	1.8kV, 50Hz, 1 min, winding to winding
Rated Current	0.5 - 15A @ Ta 40 °C	Isolation Voltage	2kV eff., winding to ambient
Rated inductance	1 - 20mH, Tol. -30% +50%	Climatic Category	25/100/21 acc. to IEC 60068-1
Power Operating Frequency	50 - 400Hz	Allowable Operation Temp.	-25 °C to 100 °C
Terminal Type	THT, Flexible wire		
Weight	6 - 163g		
Material: Housing	UL 94V-0		
Sealing Compound	UL 94V-0		

Detailed information on product approvals, code requirements, usage instructions and detailed test conditions can be looked up in [General Product Information](#)

Dimension

Case 03

Case 07

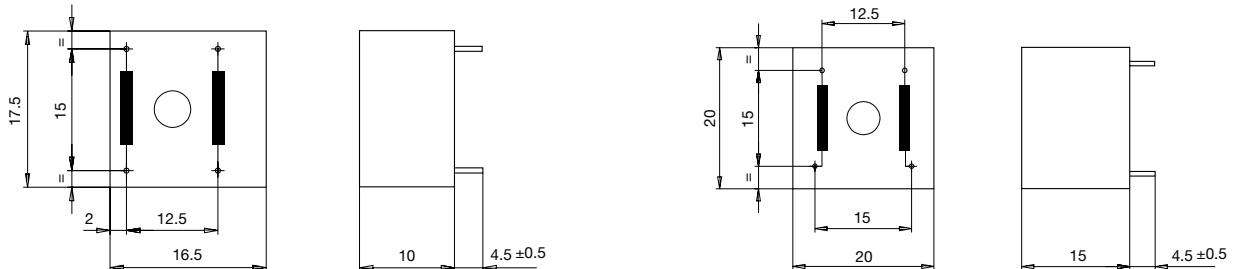

Case 11

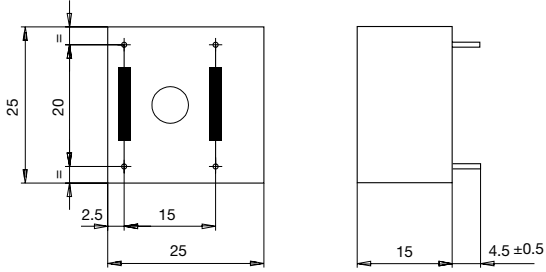

Case 12

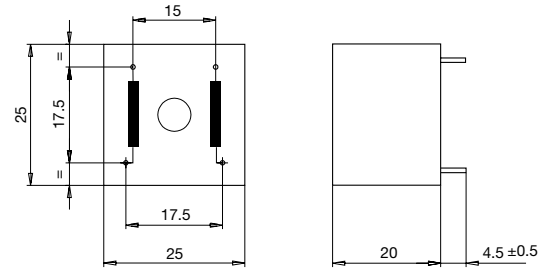

Case 20

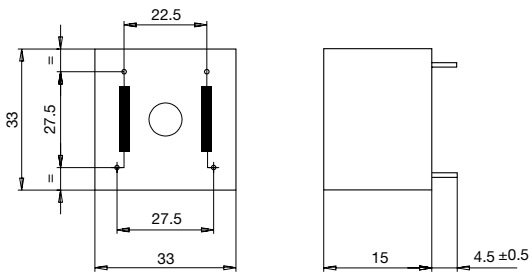

Case 25-2

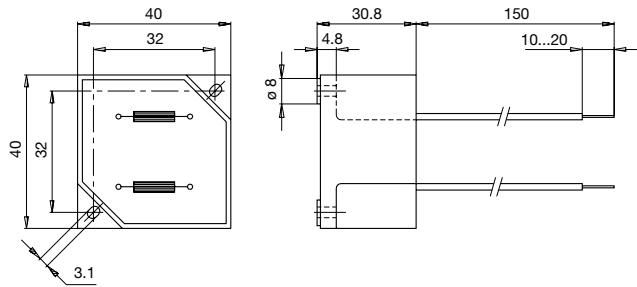

Case 29-4

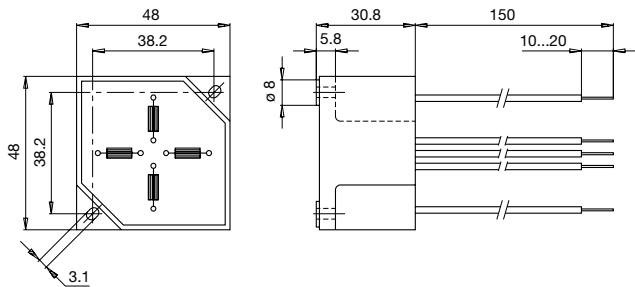

Diagrams

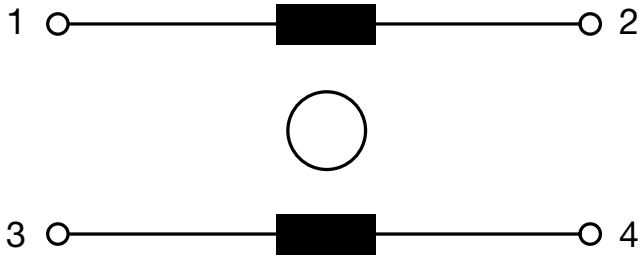

1 phase

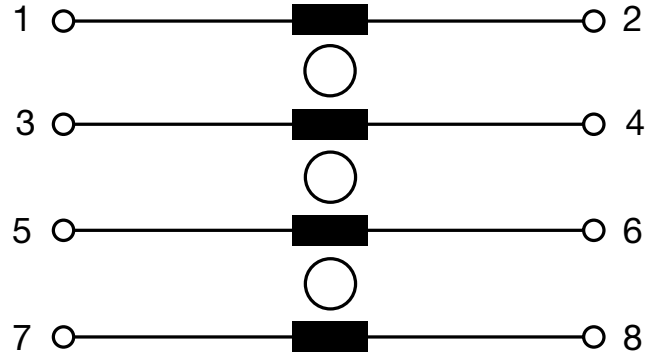

3 phases and neutral

Impedance curves

DFK-175-xxxx, DFK-20-xxxxx

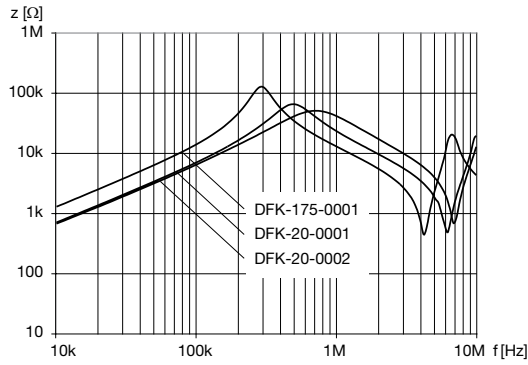

DFK-25-xxxx, DFK-40-xxxxx

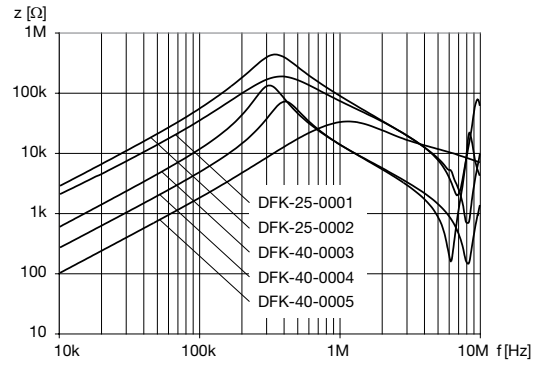

DFK-33-xxxx, DFK-48-xxxxx

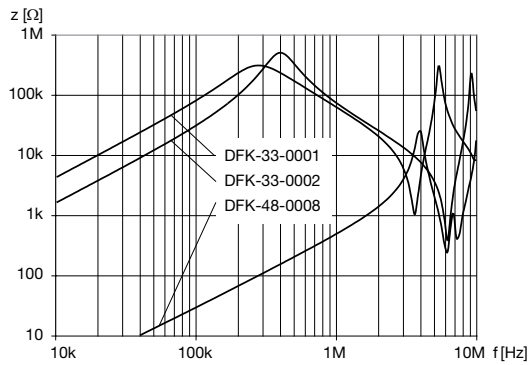

All Variants

I_n [A]	L_n [mH]	R_{cu} [mΩ]	f_{RES} [MHz]	Copper ϕ [mm]	Weight [g]	Housings	Packing unit [pcs.]	Order Number
0.5	10	900	0.5	0.5	6g	03	100	DFK-175-0001
1	10	500	0.7	0.6	12g	07	150	DFK-20-0001
1	20	500	0.5	0.6	12g	07	150	DFK-20-0002
1	10	510	0.5	0.6	18g	11	50	DFK-25-0001
2	10	250	0.5	0.6	18g	12	50	DFK-25-0002
2	20	250	0.3	0.6	37g	20	45	DFK-33-0001
3	10	150	0.38	0.6	37g	20	45	DFK-33-0002
6	4	27	0.4	-	127g	25-2	10	DFK-40-0003
10	2	9	1.45	-	127g	25-2	10	DFK-40-0004
15	1	10	1.45	2.5 x 2.5	127g	25-2	10	DFK-40-0005
6	4 x 1.5	20	0.2	1.5 x 1.5	163g	29-4	10	DFK-48-0008

I_n [A]	L_n [mH]	R_{cu} [mΩ]	f_{RES} [MHz]	Copper ϕ [mm]	Weight [g]	Housings	Packing unit [pcs.]	Order Number
-----------	------------	---------------	-----------------	-----------------------	------------	----------	---------------------	--------------

Availability for all products can be searched real-time:<http://www.schurter.com/en/Stock-Check/Stock-Check-SCHURTER>
