



Chipsmall Limited consists of a professional team with an average of over 10 year of expertise in the distribution of electronic components. Based in Hongkong, we have already established firm and mutual-benefit business relationships with customers from,Europe,America and south Asia,supplying obsolete and hard-to-find components to meet their specific needs.

With the principle of "Quality Parts,Customers Priority,Honest Operation,and Considerate Service",our business mainly focus on the distribution of electronic components. Line cards we deal with include Microchip,ALPS,ROHM,Xilinx,Pulse,ON,Everlight and Freescale. Main products comprise IC,Modules,Potentiometer,IC Socket,Relay,Connector.Our parts cover such applications as commercial,industrial, and automotives areas.

We are looking forward to setting up business relationship with you and hope to provide you with the best service and solution. Let us make a better world for our industry!



Contact us

Tel: +86-755-8981 8866 Fax: +86-755-8427 6832

Email & Skype: info@chipsmall.com Web: www.chipsmall.com

Address: A1208, Overseas Decoration Building, #122 Zhenhua RD., Futian, Shenzhen, China





DFS20A-A2BAC001024

DFS20

INCREMENTAL ENCODERS

SICK
Sensor Intelligence.



Illustration may differ



Ordering information

| Type | Part no. |
|--------------------|----------|
| DFS20A-A2BAC001024 | 1094817 |

Other models and accessories → www.sick.com/DFS20

Detailed technical data

Performance

| | |
|---------------------------------|---------------------|
| Pulses per revolution | 1,024 |
| Measuring step | ± 0.08° |
| Measuring step deviation | ± 0.008° |
| Error limits | ± 0.3° |
| Initialization time | 40 ms ¹⁾ |

¹⁾ Valid positional data can be read once this time has elapsed.

Electrical data

| | |
|-----------------------------------|---|
| Electrical interface | 8 V ... 30 V, HTL/Push pull |
| Connection type | Male connector, radial ¹⁾ |
| Power consumption | 0.7 W (without load) |
| Output frequency | 820 kHz |
| Reference signal, number | 1 |
| Reference signal, position | 180°, electronically, gated with B negative |
| Code sequence | Clockwise |

¹⁾ Zero set possible, not for programmable devices.

Mechanical data

| | |
|---|-------------------------------|
| Mechanical design | Solid shaft, Square flange |
| Shaft diameter | 3/8" |
| Weight | 0.4 kg (maximum) |
| Start up torque | 0.5 Ncm (+20 °C) |
| Operating torque | 0.3 Ncm (+20 °C) |
| Permissible shaft loading radial/axial | 40 N (axial) 80 N (radial) |
| Operating speed | 9,000 min ⁻¹ |
| Moment of inertia of the rotor | 15 gcm ² |

| | |
|-----------------------------|-----------------------------------|
| Bearing lifetime | 3.6 x 10 ⁹ revolutions |
| Angular acceleration | ≤ 500,000 rad/s ² |

Ambient data

| | |
|--------------------------------------|--|
| EMC | According to EN 61000-6-2 and EN 61000-6-3 |
| Enclosure rating | IP65 (according to IEC 60529) |
| Permissible relative humidity | 90 % (Condensation not permitted) |
| Operating temperature range | -30 °C ... +85 °C |
| Storage temperature range | -40 °C ... +100 °C, without package |
| Resistance to shocks | 100 g, 11 ms (according to EN 60068-2-27) |
| Resistance to vibration | 30 g, 10 Hz ... 2,000 Hz (according to EN 60068-2-6) |

Classifications

| | |
|-----------------------|----------|
| ECl@ss 5.0 | 27270501 |
| ECl@ss 5.1.4 | 27270501 |
| ECl@ss 6.0 | 27270590 |
| ECl@ss 6.2 | 27270590 |
| ECl@ss 7.0 | 27270501 |
| ECl@ss 8.0 | 27270501 |
| ECl@ss 8.1 | 27270501 |
| ECl@ss 9.0 | 27270501 |
| ETIM 5.0 | EC001486 |
| ETIM 6.0 | EC001486 |
| UNSPSC 16.0901 | 41112113 |

Dimensional drawing (Dimensions in mm (inch))

| SHAFT OPTIONS | | |
|---------------|-------------------------|--------------|
| NOMINAL | SHAFT Ø "A" | FLAT DIM "B" |
| 1/4" | 6.327[6.312]/2491/2485] | 5.5[2.2] |
| 3/8" | 9.507[9.492]/3743/3737] | 8.5[3.3] |
| 10MM | 9.977[9.962]/3928/3922] | 9[.35] |

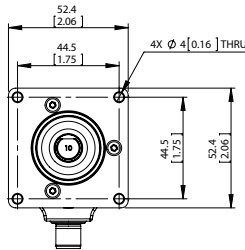
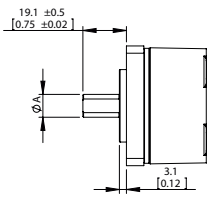

SQUARE FLANGE

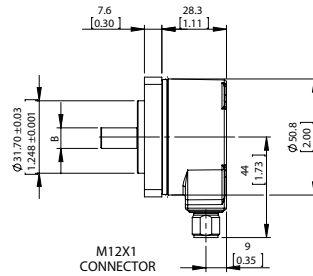

M12X1 CONNECTOR

| MIL CONNECTOR OPTIONS | |
|-----------------------|------------|
| TYPE | DIM "C" |
| 6 PIN | 63.9[2.52] |
| 7 PIN | 63.9[2.52] |
| 10 PIN | 69.4[2.73] |

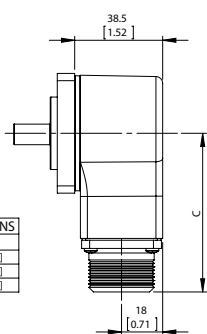

MIL CONNECTOR

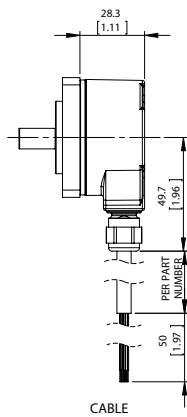

CABLE

PIN assignment

View of M12 male device connector on encoder

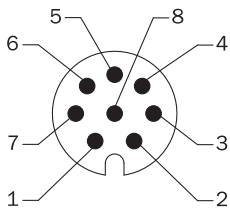

SICK AT A GLANCE

SICK is one of the leading manufacturers of intelligent sensors and sensor solutions for industrial applications. A unique range of products and services creates the perfect basis for controlling processes securely and efficiently, protecting individuals from accidents and preventing damage to the environment.

We have extensive experience in a wide range of industries and understand their processes and requirements. With intelligent sensors, we can deliver exactly what our customers need. In application centers in Europe, Asia and North America, system solutions are tested and optimized in accordance with customer specifications. All this makes us a reliable supplier and development partner.

Comprehensive services complete our offering: SICK LifeTime Services provide support throughout the machine life cycle and ensure safety and productivity.

For us, that is “Sensor Intelligence.”

WORLDWIDE PRESENCE:

Contacts and other locations www.sick.com