



Chipsmall Limited consists of a professional team with an average of over 10 year of expertise in the distribution of electronic components. Based in Hongkong, we have already established firm and mutual-benefit business relationships with customers from,Europe,America and south Asia,supplying obsolete and hard-to-find components to meet their specific needs.

With the principle of “Quality Parts,Customers Priority,Honest Operation,and Considerate Service”,our business mainly focus on the distribution of electronic components. Line cards we deal with include Microchip,ALPS,ROHM,Xilinx,Pulse,ON,Everlight and Freescale. Main products comprise IC,Modules,Potentiometer,IC Socket,Relay,Connector.Our parts cover such applications as commercial,industrial, and automotives areas.

We are looking forward to setting up business relationship with you and hope to provide you with the best service and solution. Let us make a better world for our industry!



Contact us

Tel: +86-755-8981 8866 Fax: +86-755-8427 6832

Email & Skype: info@chipsmall.com Web: www.chipsmall.com

Address: A1208, Overseas Decoration Building, #122 Zhenhua RD., Futian, Shenzhen, China



THIS COPY IS PROVIDED ON A RESTRICTED BASIS AND IS NOT TO BE USED IN ANY WAY DETRIMENTAL TO THE INTERESTS OF PANDUIT CORP.

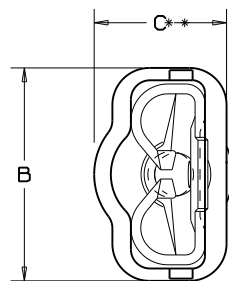
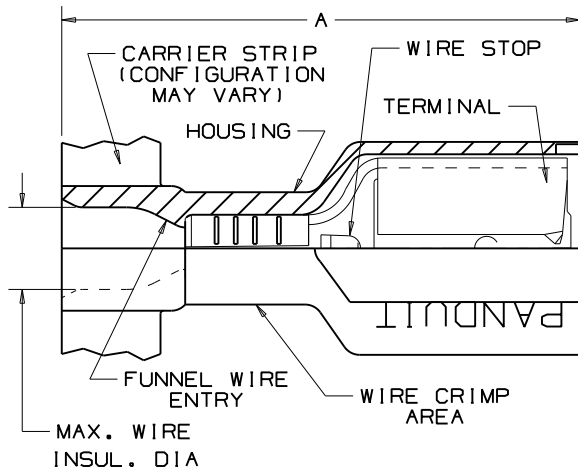

NOTES:

1. UL LISTED AND CSA CERTIFIED FOR:
 - A. 600V MAX. VOLTAGE RATING.
 - B. 221°F (105°C) MAX. TEMP. RATING (CSA).
 - C. 257°F (125°C) MAX. TEMP. RATING (UL).
 - D. STRANDED COPPER WIRE ONLY.
2. DNF10-250FIB-2K IS RATED FOR 257°F (125°C) BY UL & CSA
3. PACKAGE QTY: 3K:3000 PIECES, 2K:2000 PIECES
CONTINUOUS MOLDED STRIP CARRIER
4. MATERIAL:
 - A. STAMPING-CDA 260 BRASS, TIN PLATED
 - B. HOUSING-TYPE 66 NYLON
5. DIMENSIONS IN BRACKETS ARE IN mm OR mm²
6. COLORS ARE TRANSLUCENT
- * 7. NOTCHES DO NOT APPEAR ON PART# DNF18-250FIB-3K
8. DNF10-250FIB-2K IS UL APPROVED FOR USE WITH THE FOLLOWING WIRE COMBINATIONS: (2) #14, (2) #16, (2) #18
TWIST WIRES TOGETHER BEFORE CRIMPING
- *** 9. DNF10250FIBC-2K HAS HIGH WITHDRAWAL AND INSERTION CHARACTERISTICS (NOT UL/CSA)



LISTED 20H3 E78522
CERTIFIED LR31212

TOOL CHART
RECOMMENDED PRESS:
CP-871

PART NUMBER	TAB SIZE	WIRE RANGE AWG (mm ²)	COLOR (note 6)	MAX. INSUL.	DIMENSIONS in.			STRIP LENGTH (+1/32 (0.8) -0)	TOOL CHART RECOMMENDED PRESS: CP-871
					A ±.03 (.8)	B ±.02 (.5)	C ±.02 (.5)		
** DNF18-250FIB-3K	.250 X .032 (6,3 X 0,8)	22-18 (1,5-1,0)	RED	.136 (3,45)	.84 (21,3)	.35 (8,9)	.22 (5,6)	9/32 (7,1)	CA-800EZ / CA9 CA-800 APPLICATOR DIES
DNF18-205FIB-3K	.205/.187 X .032 (5,2/4,8 X 0,8)	22-18 (1,5-1,0)	RED	.136 (3,45)	.78 (19,8)	.31 (7,9)	.22 (5,6)	"	CD-800-4 CD9-4A
DNF18-206FIB-3K	.205/.187 X .020 (5,2/4,8 X 0,5)	22-18 (1,5-1,0)	RED	.136 (3,45)	.78 (19,8)	.31 (7,9)	.22 (5,6)	"	
DNF18-187FIB-3K	.187 X .032 (4,8 X 0,8)	22-18 (1,5-1,0)	RED	.136 (3,45)	.78 (19,8)	.29 (7,4)	.16 (4,1)	"	
DNF18-188FIB-3K	.187 X .020 (4,8 X 0,5)	22-18 (1,5-1,0)	RED	.136 (3,45)	.78 (19,8)	.29 (7,4)	.16 (4,1)	"	
DNF14-250FIB-3K	.250 X .032 (6,3 X 0,8)	16-14 (1,5-2,5)	BLUE	.160 (4,06)	.84 (21,3)	.35 (8,9)	.22 (5,6)	"	CD-800-5 CD9-5A
DNF14-205FIB-3K	.205/.187 X .032 (5,2/4,8 X 0,8)	16-14 (1,5-2,5)	BLUE	.160 (4,06)	.78 (19,8)	.31 (7,9)	.22 (5,6)	"	
DNF14-206FIB-3K	.205/.187 X .020 (5,2/4,8 X 0,5)	16-14 (1,5-2,5)	BLUE	.160 (4,06)	.78 (19,8)	.31 (7,9)	.22 (5,6)	"	
DNF14-187FIB-3K	.187 X .032 (4,8 X 0,8)	16-14 (1,5-2,5)	BLUE	.160 (4,06)	.78 (19,8)	.29 (7,4)	.18 (4,6)	"	
DNF14-188FIB-3K	.187 X .020 (4,8 X 0,5)	16-14 (1,5-2,5)	BLUE	.160 (4,06)	.78 (19,8)	.29 (7,4)	.18 (4,6)	"	CD-800-13 CD9-13B
DNF10-250FIB-2K	.250 X .032 (6,3 X 0,8)	12-10 (4,0-6,0)	YELLOW	.220 (5,59)	.96 (24,4)	.35 (8,9)	.23 (5,8)	3/8 (9,5)	
*** DNF10-250FIBC-2K	.250 X .032 (6,3 X 0,8)	12-10 (4,0-6,0)	YELLOW	.220 (5,59)	.96 (24,4)	.35 (8,9)	.23 (5,8)	3/8 (9,5)	

13	07.12	BDK	LSM	ADDED DNF10-250FIBC-2K TO CHART AND NOTE #9 REVISED TOOL CHART	N41165BA-DC	VMB	
12	02/09	BCT		ADDED NOTE TO TWIST MULTIPLE WIRES TOGETHER PRIOR TO CRIMPING			
11	08/07	SRB		Removed notches from housing DNF18-250FIB-3K			
10	11/04	KLFU		UPDATED TOOL CHART PART NUMBERS			
REV	DATE	BY	CHK	DESCRIPTION	ECN #	CUST	PM



CORP.

TINLEY PARK, ILLINOIS

REELSMART™

DISCO-FULLY INSULATED FEMALE DISCONNECTS
.250 X .032, .205 X .032/.020, .187 X .032/.020

DRAWN BY DSM	CHK'D	SCALE NONE	DRAWING NO. N41165BA-DC
-----------------	-------	---------------	----------------------------