



Chipsmall Limited consists of a professional team with an average of over 10 year of expertise in the distribution of electronic components. Based in Hongkong, we have already established firm and mutual-benefit business relationships with customers from,Europe,America and south Asia,supplying obsolete and hard-to-find components to meet their specific needs.

With the principle of “Quality Parts,Customers Priority,Honest Operation,and Considerate Service”,our business mainly focus on the distribution of electronic components. Line cards we deal with include Microchip,ALPS,ROHM,Xilinx,Pulse,ON,Everlight and Freescale. Main products comprise IC,Modules,Potentiometer,IC Socket,Relay,Connector.Our parts cover such applications as commercial,industrial, and automotives areas.

We are looking forward to setting up business relationship with you and hope to provide you with the best service and solution. Let us make a better world for our industry!



Contact us

Tel: +86-755-8981 8866 Fax: +86-755-8427 6832

Email & Skype: info@chipsmall.com Web: www.chipsmall.com

Address: A1208, Overseas Decoration Building, #122 Zhenhua RD., Futian, Shenzhen, China



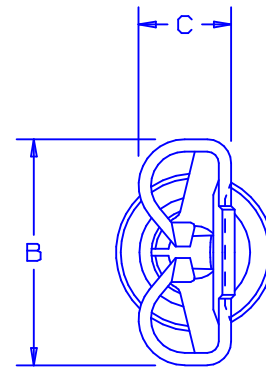
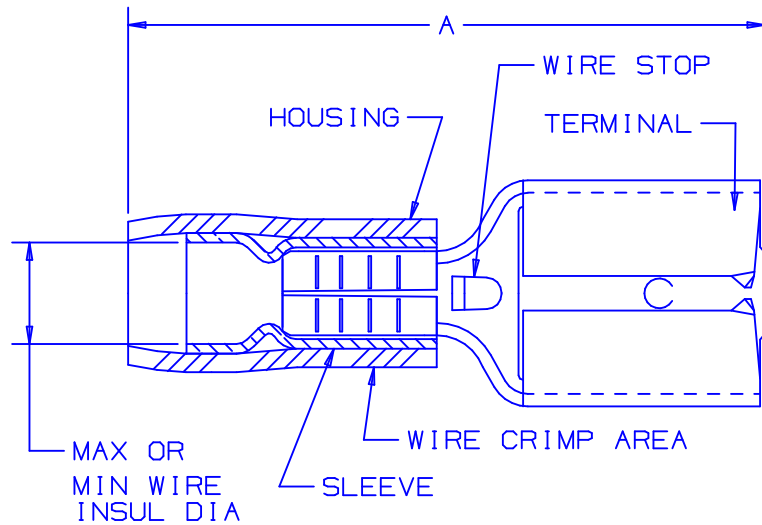

NOTES:

1. UL LISTED AND CSA CERTIFIED FOR:
 - A. 300V MAX VOLTAGE RATING
 - B. 194°F (90°C) MAX TEMP RATING
 - C. STRANDED COPPER WIRE ONLY
 - D. 6-12 LBS INITIAL INSERTION/WITHDRAWAL FORCE
2. MATERIAL:
 - A. STAMPING-BRASS, TIN PLATED
 - B. HOUSING-NYLON
 - C. SLEEVE-BRASS, TIN PLATED
3. DIMENSIONS IN BRACKETS ARE IN mm OR mm²
4. INSTALLATION TOOLS: UL/CSA: CT-500
PANDUIT APPROVED: CT-100, CT-160, CT-260, CT-400, CT-460, CT-1551, CT-1550
5. WIRE STRIP LENGTH: 9/32 ^{+1/32} (7.1 ⁺⁸)
6. PKG QTY:
 - C = 100
 - M = 1000

PART NUMBER	TAB SIZE	WIRE RANGE AWG	COLOR	MAX. INSUL.	MIN. INSUL.	DIMENSIONS in.		
						A ±.03	B ±.01	C ±.004
DNF18-250	.250 X .032	22-18	RED	.138 (3.51)	.040 (1.02)	.81 (20.57)	.29 (7.37)	.12 (3.05)
DNF14-250	.250 X .032	16-14	BLUE	.162 (4.11)	.050 (1.27)	.83 (21.08)	.29 (7.37)	.12 (3.05)



07	7/03	KLFU		ADDED INTERNAL SERRATIONS			
06	1/01	KMD	SKB	CAD FILE SPEC. WAS N41200AA_PCD_05	8938	JAC	CCH
05	3/99	JKD		ADDED CT-1551 & CT-1550 TOOLS	07632		
04	12/96	JB	RLS	ADDED TO TABLE "MIN INSUL"	05427	LA	DBH
03	4/95	MS	RLS	REMOVED SLOT FROM TERMINAL	03132	LA	KRS
REV	DATE	BY	CHK	DESCRIPTION	ECN #	CUST	PM

A41200_07



TINLEY PARK, ILLINOIS

FEMALE DISCONNECTS, NYLON INSULATED, FUNNEL .250 X .032

DRAWN BY FES	CHK'D LA	SCALE NONE	DRAWING NO. A41200
-----------------	-------------	---------------	-----------------------