



Chipsmall Limited consists of a professional team with an average of over 10 year of expertise in the distribution of electronic components. Based in Hongkong, we have already established firm and mutual-benefit business relationships with customers from,Europe,America and south Asia,supplying obsolete and hard-to-find components to meet their specific needs.

With the principle of “Quality Parts,Customers Priority,Honest Operation,and Considerate Service”,our business mainly focus on the distribution of electronic components. Line cards we deal with include Microchip,ALPS,ROHM,Xilinx,Pulse,ON,Everlight and Freescale. Main products comprise IC,Modules,Potentiometer,IC Socket,Relay,Connector.Our parts cover such applications as commercial,industrial, and automotives areas.

We are looking forward to setting up business relationship with you and hope to provide you with the best service and solution. Let us make a better world for our industry!



## Contact us

Tel: +86-755-8981 8866 Fax: +86-755-8427 6832

Email & Skype: [info@chipsmall.com](mailto:info@chipsmall.com) Web: [www.chipsmall.com](http://www.chipsmall.com)

Address: A1208, Overseas Decoration Building, #122 Zhenhua RD., Futian, Shenzhen, China



| Panduit<br>Part number |          | Wire<br>range<br>AWG<br>(mm <sup>2</sup> ) | Housing<br>color | Dim.<br>"F"  | Minimum<br>Wire<br>Insulation<br>Diameter | Maximum<br>Wire<br>Insulation<br>Diameter | Tools   |
|------------------------|----------|--|------------------|--------------|---|---|---------|
| Prefix                 | PK       |  |                  |              |   |   |         |
| DNG18-250FL            | -C<br>-M | 22-18<br>(0.5-1.5)                         | Red              | .24<br>(6.1) | .060<br>(1.52)                            | .126<br>(3.20)                            | CT-1014 |
| DNG14-250FL            | -C<br>-M | 16-14<br>(1.5-2.5)                         | Blue             | .25<br>(6.4) | .080<br>(2.03)                            | .150<br>(3.81)                            |         |

**Notes:**

**1. Used for:**

- A. 300 V maximum rating
- B. 221°F (105°C) maximum temperature rating
- C. Stranded copper wire only

**2. Wire strip length:**  $\frac{1}{4}$   $\begin{smallmatrix} +1/32 \\ -0 \end{smallmatrix}$   $\begin{smallmatrix} +.8 \\ (6.4 -0) \end{smallmatrix}$

**3. Material:**

- A. Stamping - Tin plated brass
- B. Housing - Nylon

**4. Tab size .250 X .032 (6.3 X .8)**  
Hole type detent

**5. Packaging:**

- A. -C = 100 pieces
- B. -M = 1000 pieces

**6. Dimensions in brackets are in millimeters or mm<sup>2</sup>**

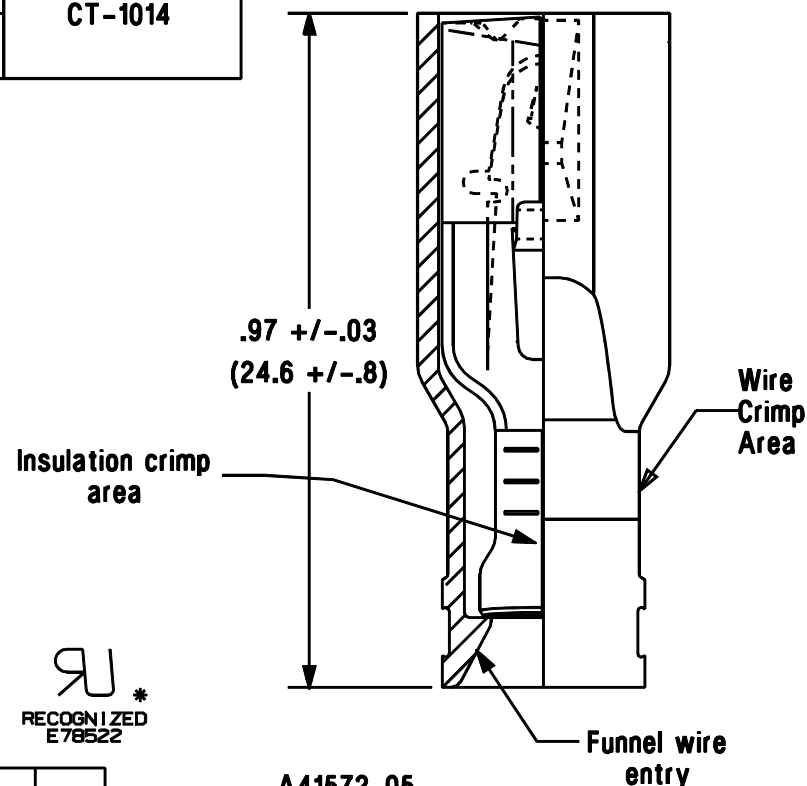
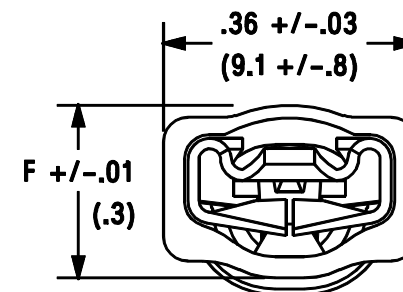

|     |       |      |     |   |       |      |      |
|-----|-------|------|-----|---|-------|------|------|
| 05  | 01/01 | EJS  |     | FILE SPEC WAS N41572AA_PCD_04                   | 08933 |      |      |
| 04  | 1/97  | JAMB |     | ADDED TO NOTES,"MIN. WIRE INSULATION DIA."      | 05405 |      |      |
| 03  | 12/95 | ED   | RLS | REVISION TO NOTES AND UL RECOGNIZED             | 03835 | TFKE | LA   |
| 02  | 2/95  | MS   | JW  | WIRE STRIP LNGTH WAS 3/16, TOOL NO. WAS CT-1000 | 03003 | KS   | LA   |
| 01  | 7/94  | MS   | JW  | CSA CERTIFIED, WIRE STRIP LNGTH WAS 7/32        | 02381 | KS   | LA   |
| REV | DATE  | BY   | CHK | DESCRIPTION                                     | ECN # | PM   | CUST |

A41572\_05

**PANDUIT**

CORP.

TINLEY PARK, ILLINOIS

**Disco-Lok™ Loose piece**  
**Fully Insulated Locking Female Disconnect**

|          |       |       |                          |
|----------|-------|-------|--------------------------|
| DRAWN BY | CHK'D | SCALE | DRAWING NO./CAD FILENAME |
| BDK      | JAW   | None  | A41572                   |