



Chipsmall Limited consists of a professional team with an average of over 10 year of expertise in the distribution of electronic components. Based in Hongkong, we have already established firm and mutual-benefit business relationships with customers from,Europe,America and south Asia,supplying obsolete and hard-to-find components to meet their specific needs.

With the principle of “Quality Parts,Customers Priority,Honest Operation,and Considerate Service”,our business mainly focus on the distribution of electronic components. Line cards we deal with include Microchip,ALPS,ROHM,Xilinx,Pulse,ON,Everlight and Freescale. Main products comprise IC,Modules,Potentiometer,IC Socket,Relay,Connector.Our parts cover such applications as commercial,industrial, and automotives areas.

We are looking forward to setting up business relationship with you and hope to provide you with the best service and solution. Let us make a better world for our industry!



Contact us

Tel: +86-755-8981 8866 Fax: +86-755-8427 6832

Email & Skype: info@chipsmall.com Web: www.chipsmall.com

Address: A1208, Overseas Decoration Building, #122 Zhenhua RD., Futian, Shenzhen, China



Distinctive Characteristics

Power and logic level capabilities available to suit varying applications.

High torque bushing prevents rotation and separation from metal frame during installation.

Stainless steel frame resists corrosion.

Case of heat resistant resin meets UL94V-0 flammability rating.

Antijamming design protects contact mechanism from damage if lever is subjected to sharp downward force or other harsh treatment.

Bias guard achieved by interlocking actuator block with lever and interior guide; diagonal force on toggle is not transmitted to actuator block and misalignment of contacts is prevented.

Higher insulating barriers protect against crossover in double pole devices.

1,500V dielectric strength between contacts and case is accomplished by clinching the frame away from the terminals.

Epoxy sealed terminals prevent entry of solder flux and other contaminants.

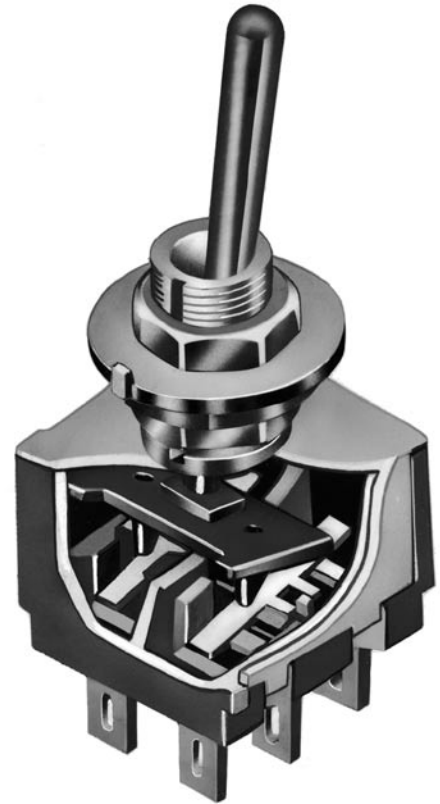

Actual Size

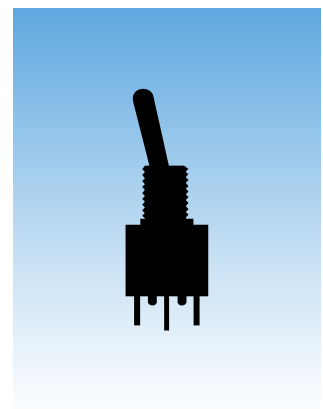

General Specifications

Electrical Capacity (Resistive Load)

Power Level (No Code or P):	3A @ 125V AC for silver contacts
Logic Level (code G or PG):	0.4VA maximum @ 28V AC/DC maximum for gold contacts (Applicable Range 0.1mA ~ 0.1A @ 20mV ~ 28V)
	Note: Find additional explanation of operating range in Supplement section.

Other Ratings

Contact Resistance:	10 milliohms maximum for silver; 20 milliohms maximum for gold
Insulation Resistance:	1,000 megohms minimum @ 500V DC
Dielectric Strength:	1,000V AC minimum between contacts for 1 minute minimum; 1,500V AC minimum between contacts & case for 1 minute minimum
Mechanical Life:	100,000 operations minimum
Electrical Life:	20,000 operations minimum for silver; 50,000 operations minimum for gold
Angle of Throw:	25°

Materials & Finishes

Toggle:	Brass with chrome plating
Bushing:	Brass with nickel plating
Frame:	Stainless steel
Case:	Melamine phenolic resin (UL94V-0)
Movable Contacts:	Copper with silver or gold plating
Stationary Contacts:	Silver with silver or gold plating
Terminals:	Copper with silver or gold plating

Environmental Data

Operating Temp Range:	-10°C through +70°C (+14°F through +158°F)
Humidity:	90 ~ 95% humidity for 96 hours @ 40°C (104°F)
Vibration:	10 ~ 55Hz with peak-to-peak amplitude of 1.5mm traversing the frequency range & returning in 1 minute; 3 right angled directions for 2 hours
Shock:	50G (490m/s ²) acceleration (tested in 6 right angled directions, with 5 shocks in each direction)

Installation

Mounting Torque:	1.47Nm (13 lb•in) for double nut; .686Nm (6 lb•in) for single nut
Soldering Time & Temp:	Circuits 2 & 5 Manual Soldering: 3 seconds maximum @ 350°C maximum Wave Solder: 5 seconds maximum @ 270°C maximum. Circuits 1, 3, 8, & 9 Manual Soldering: 4 seconds maximum @ 410°C maximum Wave Solder: See Profile A in Supplement section. Note: On circuits 1, 3, 8, & 9 levers must be in center or off position while soldering.

Standards & Certifications

Flammability Standards:	UL94V-0 case
UL Recognized:	All single & double pole models recognized at 3A @ 125V AC; UL File No. WOYR2.E44145; add "/U" to end of part number to order UL mark on switch.
CSA Certified:	Single pole, double throw solder lug & PC models certified at 3A @ 125V AC; double pole, double throw PC models certified at 3A @ 125V AC; CSA File No. 023535-0-000; add "/C" to end of part number to order CSA mark on switch.



TYPICAL SWITCH ORDERING EXAMPLE

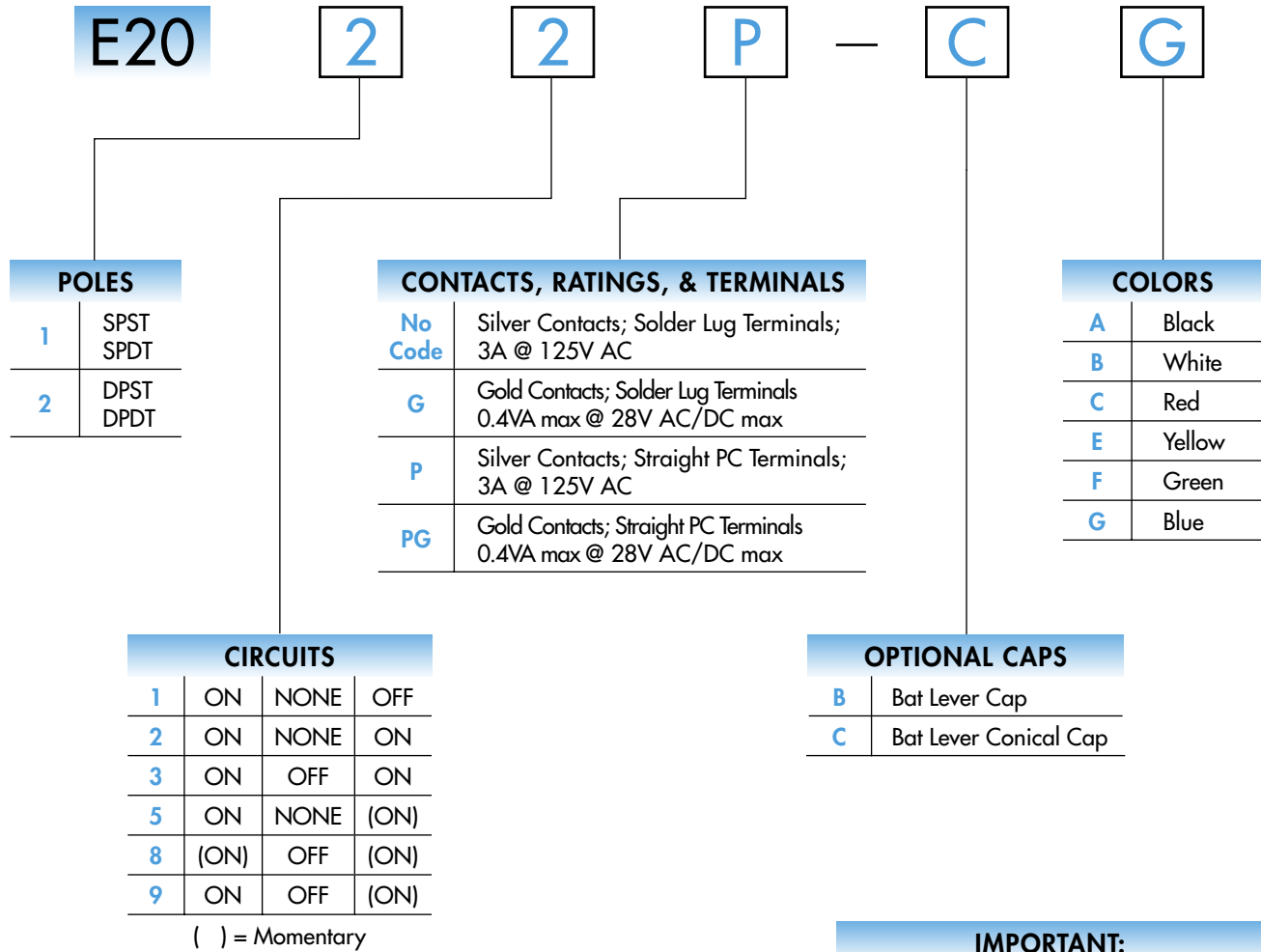

IMPORTANT:

Switches are supplied without UL & CSA marking unless specified. Specific models & ratings noted on General Specifications page.

DESCRIPTION FOR TYPICAL ORDERING EXAMPLE

E2022P-CG

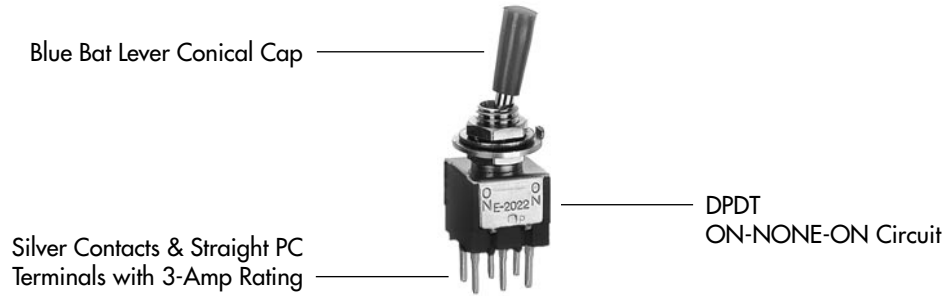

POLES & CIRCUITS

Pole	Model	Toggle Position () = Momentary			Connected Terminals			Throw & Schematics
		Down <small>Keyway</small>	Center	Up	Down <small>Keyway</small>	Center	Up	
SP	E2011	ON	NONE	OFF	2-3	OPEN	OPEN	SPST
SP	E2012 E2013 E2015 E2018 E2019	ON ON ON (ON) ON	NONE OFF NONE OFF OFF	ON ON (ON) (ON) (ON)	2-3	OPEN	2-1	SPDT
DP	E2021	ON	NONE	OFF	2-3 5-6	OPEN	OPEN	DPST
DP	E2022 E2023 E2025 E2028 E2029	ON ON ON (ON) ON	NONE OFF NONE OFF OFF	ON ON (ON) (ON) (ON)	2-3 5-6	OPEN	2-1 5-4	DPDT

Note: Terminal numbers are not actually on the switch.

CONTACT MATERIALS, RATINGS, & TERMINALS



**Solder Lug
Silver Contacts**

**Power Level
3A @ 125V AC**

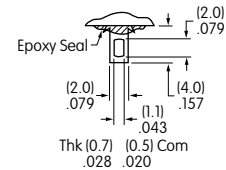

**Solder Lug
Gold Contacts**

**Logic Level
0.4VA maximum @ 28V AC/DC maximum**

Wiring Specifications

The .043" x .079" (1.1mm x 2.0mm) oblong terminal hole accommodates one solid 18-gauge wire or two solid or stranded 20-gauge wires.

Complete explanation of operating range in Supplement section.



**Straight PC
Silver Contacts**

**Power Level
3A @ 125V AC**

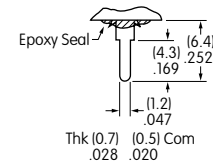

PCB Footprints



**Straight PC
Gold Contacts**

**Logic Level
0.4VA maximum @ 28V AC/DC maximum**

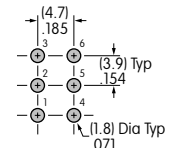
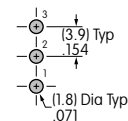

Complete explanation of operating range in Supplement section.

Single Pole

Double Pole

OPTIONAL CAPS & COLORS

B AT415
Bat Lever Cap

Cap Lever Material
Polyethylene

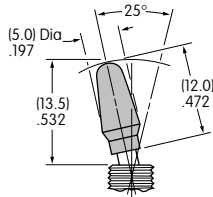

C AT444
Bat Lever Conical Cap

Cap Lever Material
Polyethylene

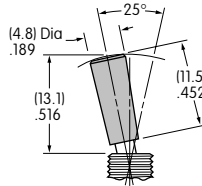

Cap Colors Available:

- A** Black **B** White **C** Red
E Yellow **F** Green **G** Blue

The E Series toggles have a bat lever .413" (10.5mm) long.

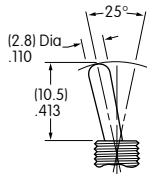

This standard lever is combined with a metric bushing.

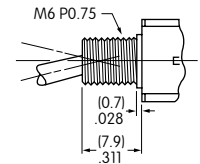
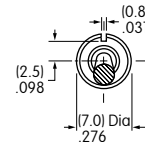

TYPICAL SWITCH DIMENSIONS

Solder Lug

Single Pole

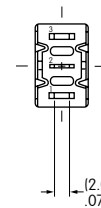
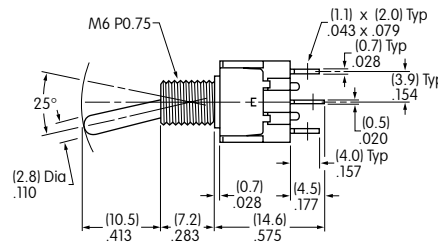
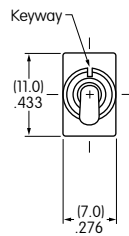

E2012

E2011 model does not have terminal 1.

Solder Lug

Double Pole

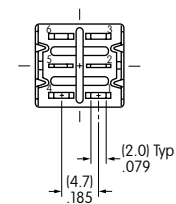
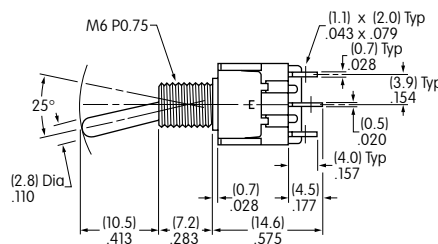
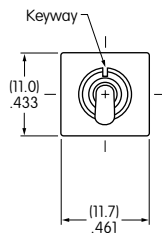

E2022

E2021 model does not have terminals 1 & 4.

STANDARD HARDWARE

Standard Hardware

- 2 AT513M Metric Hexagon Nuts
- 1 AT507M Metric Locking Ring
- 1 AT509 Internal Tooth Lockwasher

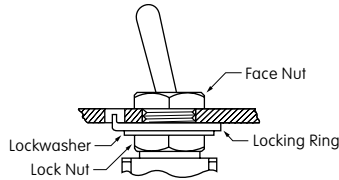

AT513M Metric Hexagon Nut

Material:
Brass with Nickel Plating

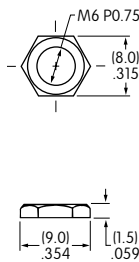

AT507M Metric Locking Ring

Material:
Steel with Zinc/Chromate

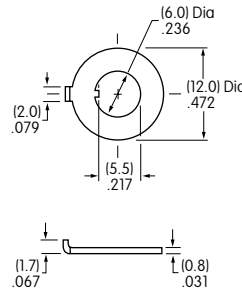

AT509 Lockwasher

Material:
Steel with Zinc/Chromate

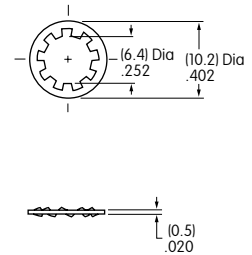

Optional hardware available. See Accessories & Hardware section.

Panel Thicknesses & Panel Cutouts

With Standard Hardware

Maximum Effective Panel Thickness:
.087" (2.2mm)

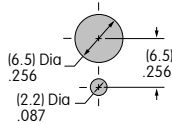

Without Locking Ring

Maximum Effective Panel Thickness:
.118" (3.0mm)



Without Bottom Hex Nut

Maximum Effective Panel Thickness:
.154" (3.9mm)

Without Locking Ring & Bottom Hex Nut

Maximum Effective Panel Thickness:
.185" (4.7mm)

OPTIONAL SPLASHPROOF BOOT

AT428M (Metric) Boot for Bat Toggle

Material: Silicone Rubber

