



Chipsmall Limited consists of a professional team with an average of over 10 year of expertise in the distribution of electronic components. Based in Hongkong, we have already established firm and mutual-benefit business relationships with customers from,Europe,America and south Asia,supplying obsolete and hard-to-find components to meet their specific needs.

With the principle of “Quality Parts,Customers Priority,Honest Operation,and Considerate Service”,our business mainly focus on the distribution of electronic components. Line cards we deal with include Microchip,ALPS,ROHM,Xilinx,Pulse,ON,Everlight and Freescale. Main products comprise IC,Modules,Potentiometer,IC Socket,Relay,Connector.Our parts cover such applications as commercial,industrial, and automotives areas.

We are looking forward to setting up business relationship with you and hope to provide you with the best service and solution. Let us make a better world for our industry!



Contact us

Tel: +86-755-8981 8866 Fax: +86-755-8427 6832

Email & Skype: info@chipsmall.com Web: www.chipsmall.com

Address: A1208, Overseas Decoration Building, #122 Zhenhua RD., Futian, Shenzhen, China



General Speaker

■ Features

- Reproduces wide range of frequencies
- Wide variety of applications
- Wide product range

■ Recommended Applications

- CD-radio-cassette recorders, Radios
- Information and communication equipment



■ Specifications

Part No.	Input (W)		(Ω) Imp.	fo (Hz)	(Hz) Frequency Range	S.P.L.* (dB/1 W/ 0.5 m)	(g) Mass	Comments
	Rated	max.						
EAS-4P15SA	0.1	—	8	530	fo - 3k	92.0	25	
EAS-45P30S	0.1	—	8		fo - 3k	93.0	24	
EAS-6P22S	0.5	—	8		Full Range	92.0	75	
EAS-8P36S	0.63	—	25		Full Range	95.0	83	
EAS-4D02CO	1	—	16		Full Range	73.0	12	
EAS-G7D504A2	1.5	—	16		Full Range	90.0	107	
EAS-G9D550B2	1.5	—	16		Full Range	87.0	45	
EAS-G9D541A2	3	—	8		Full Range	88.5	135	
EAS-G12D531E2	3	—	8		Full Range	93.5	180	

EAS4P15SA

Dimensions in mm (not to scale)

EAS4P15SA

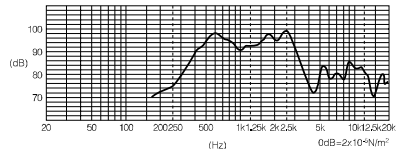
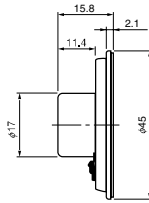
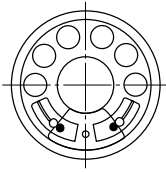

EAS45P30S

Dimensions in mm (not to scale)

EAS45P30S

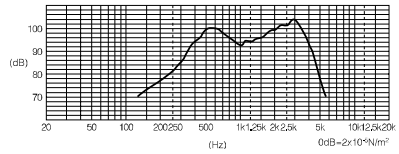
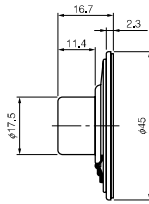
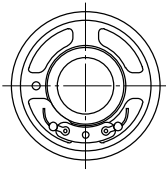

EAS6P22S

Dimensions in mm (not to scale)

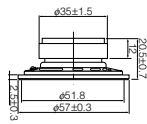

EAS8P36S

Dimensions in mm (not to scale)

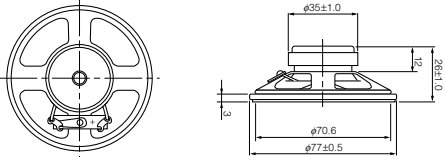

EAS4D02C0

Dimensions in mm (not to scale)

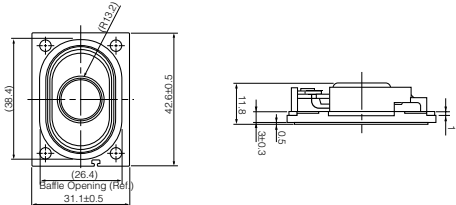

EASG7D504A2

Dimensions in mm (not to scale)

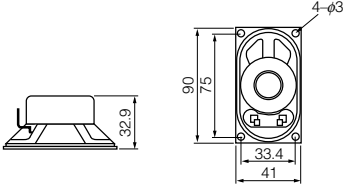

EASG9D550B2

Dimensions in mm (not to scale)

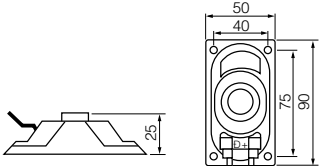

EASG9D541A2

Dimensions in mm (not to scale)

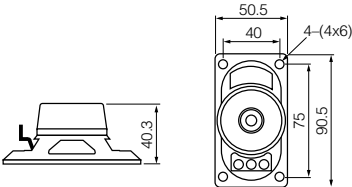

EASG12D531E2

Dimensions in mm (not to scale)

